

Maine State Library

**Digital Maine**

---

Transportation Documents

Transportation

---

9-1-2011

**Central Maine Regional Airport, Town of Norridgewock, Maine :  
Runway 15-33 Obstruction Removal (Phase 2) and RSA Extension,  
September 2011**

Maine Department of Transportation

Follow this and additional works at: [https://digitalmaine.com/mdot\\_docs](https://digitalmaine.com/mdot_docs)

---



Stantec Consulting Services Inc.  
 482 Payne Road  
 Scarborough ME U.S.A.  
 04074  
 Tel. 207.883.3355  
 Fax. 207.883.3376  
 www.stantec.com

Copyright Reserved

The Contractor shall verify and be responsible for all dimensions. DO NOT scale the drawing - any errors or omissions shall be reported to Stantec without delay.  
 The Copyrights to all designs and drawings are the property of Stantec. Reproduction or use for any purpose other than that authorized by Stantec is forbidden.

Consultants

Legend

- AIRPORT PROPERTY LINE
- EASEMENT BOUNDARY
- SILT FENCE
- CB INLET SEDIMENT FILTER
- CONTRACTOR HAUL ROUTE
- DELINEATED WETLAND BOUNDARY
- WETLAND VEG. REMOVAL
- UPLAND VEG. REMOVAL
- RUNWAY SAFETY AREA EXTENSION

Notes

- UPLAND OBSTRUCTIONS TO BE REMOVED: 29.7± ACRES
- WETLAND OBSTRUCTIONS TO BE REMOVED: 20.0± ACRES
- PROP. WETLAND FILL IMPACTS FOR RSA: ±0.85 ACRES (±36,900 SF)
- EXIST. WETLAND FILL IMPACTS: ±538 SF

NOTE:

1. TOPOGRAPHY FOR AIRPORT PROPERTY WAS OBTAINED THROUGH AERIAL PHOTOGRAMMETRY SUPPLIED BY AERIAL SURVEY AND PHOTO INC. OF NORRIDGEWOCK, MAINE, DATED 05/07/2008. VERTICAL DATUM: N.A.V.D. 1988; HORIZONTAL DATUM: MAINE STATE COORDINATES, WEST ZONE, NAD 83.
2. TOPOGRAPHY IN EASEMENT AREAS NOT COVERED BY THE AERIAL PHOTOGRAMMETRY WERE DERIVED FROM 10 METER DIGITAL ELEVATION MODELS (DEM) ORIGINATED BY THE USGS AS PART OF THE NATIONAL MAPPING PROGRAM. MEDEM10'S ARE MADE AVAILABLE FOR DOWNLOAD FROM MAINE OFFICE OF GIS.

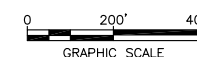

Revision \_\_\_\_\_ By \_\_\_\_\_ Appd. YY.MM.DD

Issued \_\_\_\_\_ By \_\_\_\_\_ Appd. YY.MM.DD

File Name: sht\_01\_obs\_rmv\_pln.dwg \_\_\_\_\_ Dwn. Chkd. Dsgn. YY.MM.DD

Permit-Seal \_\_\_\_\_

Client/Project

CENTRAL MAINE REGIONAL AIRPORT  
 TOWN OF NORRIDGEWOCK, MAINE  
 RW 15-33 OBSTR. REMOVAL (PHASE 2)  
 AND RSA EXTENSION  
 NORRIDGEWOCK, MAINE

Title

SITE PLAN

Project No. \_\_\_\_\_ Scale \_\_\_\_\_

195210550 1" = 200'

Drawing No. \_\_\_\_\_ Sheet \_\_\_\_\_ Revision \_\_\_\_\_

1 1 of 0

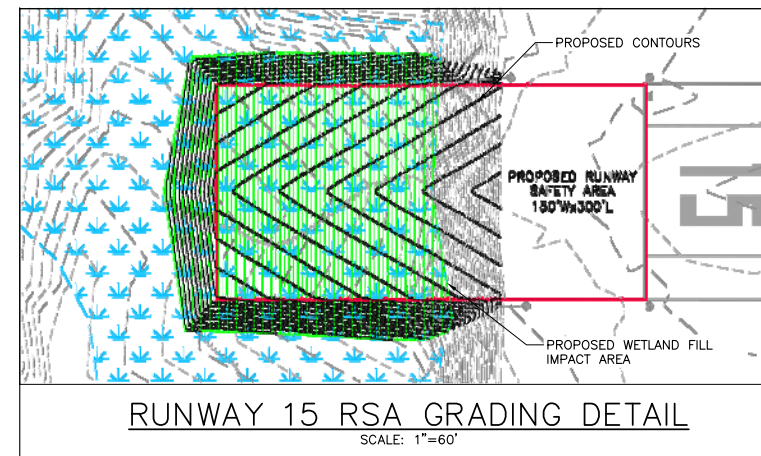
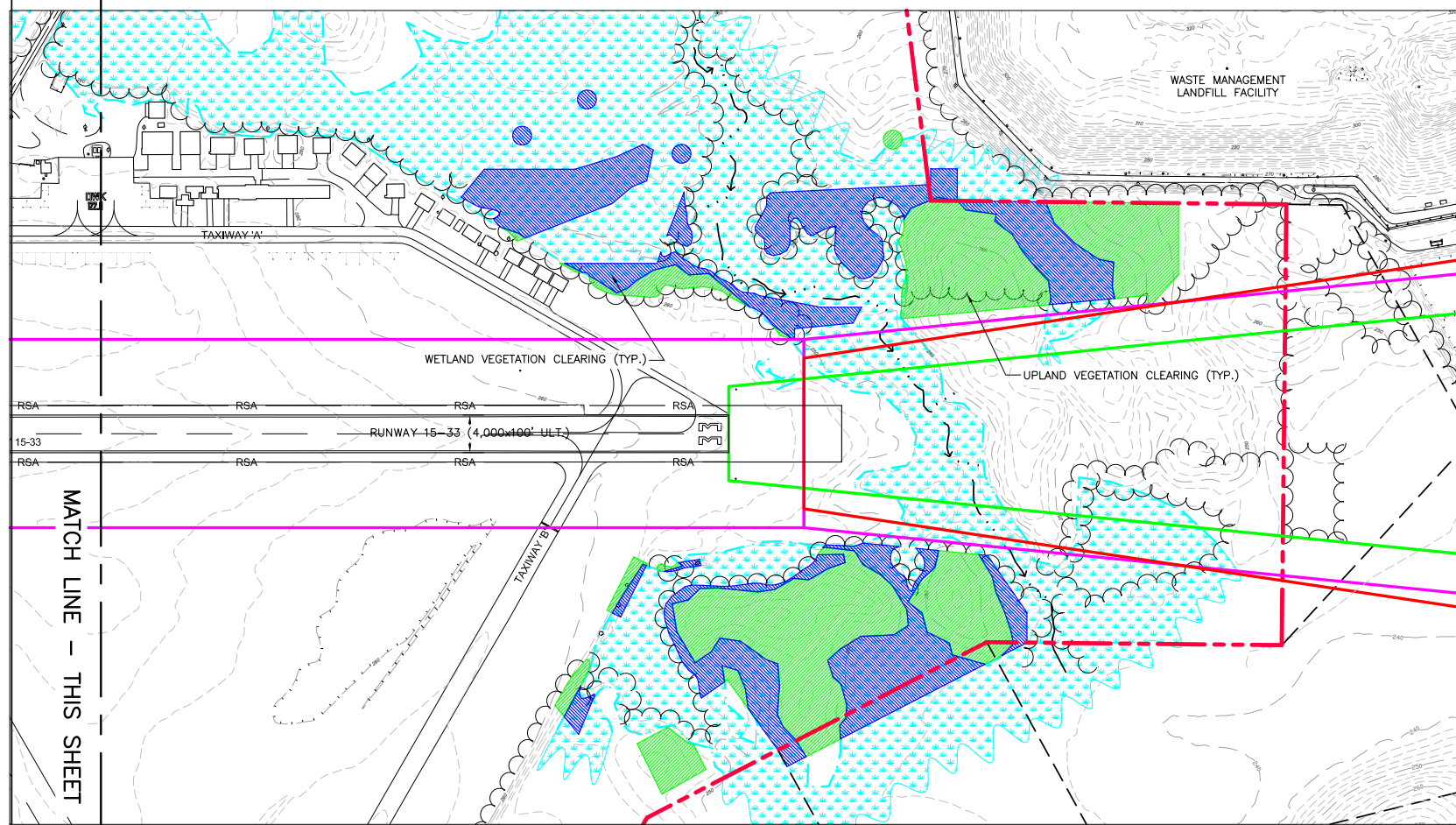
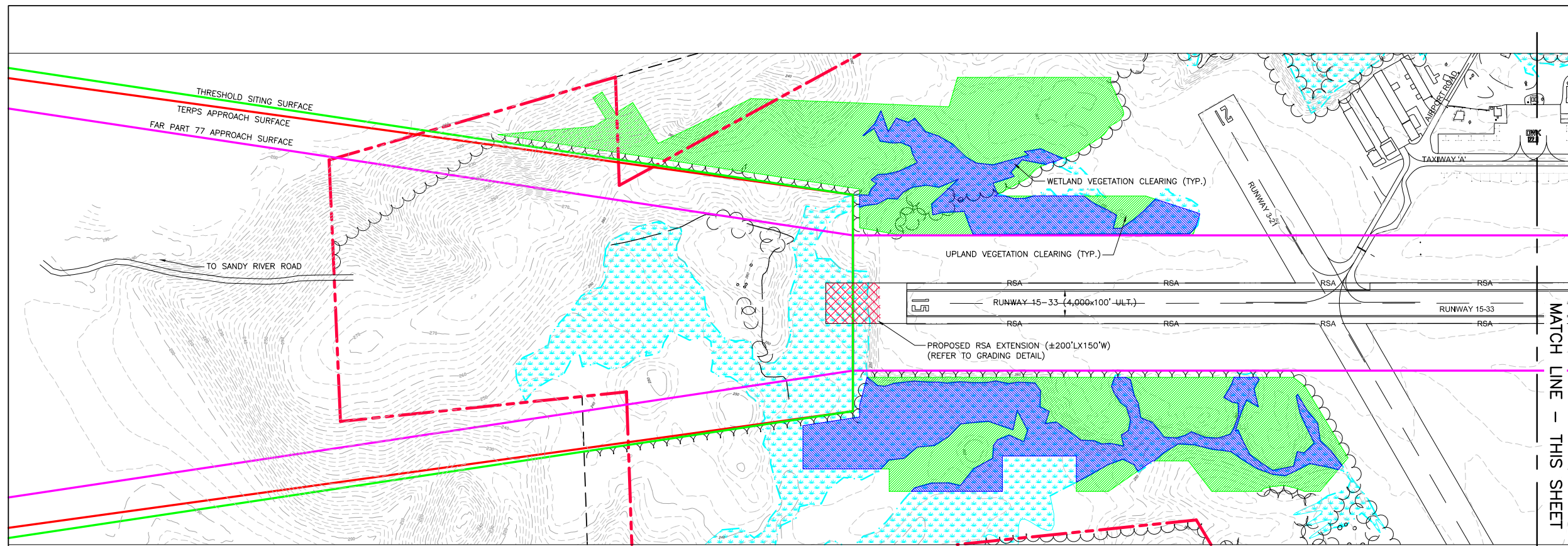

**PRELIMINARY  
 NOT FOR  
 CONSTRUCTION**  
 SEPTEMBER 2011