

Approved by Planning Board
July 2, 1965
by James H. Farnham, Chairman

PROFILE
LEDGE ROAD
SCHOONER ROCKS
CUMBERLAND, MAINE

OWEN HASKELL
CIVIL ENGINEER
CAPE ELIZABETH, ME

JOB 6424
DATE APR. 14, 1965

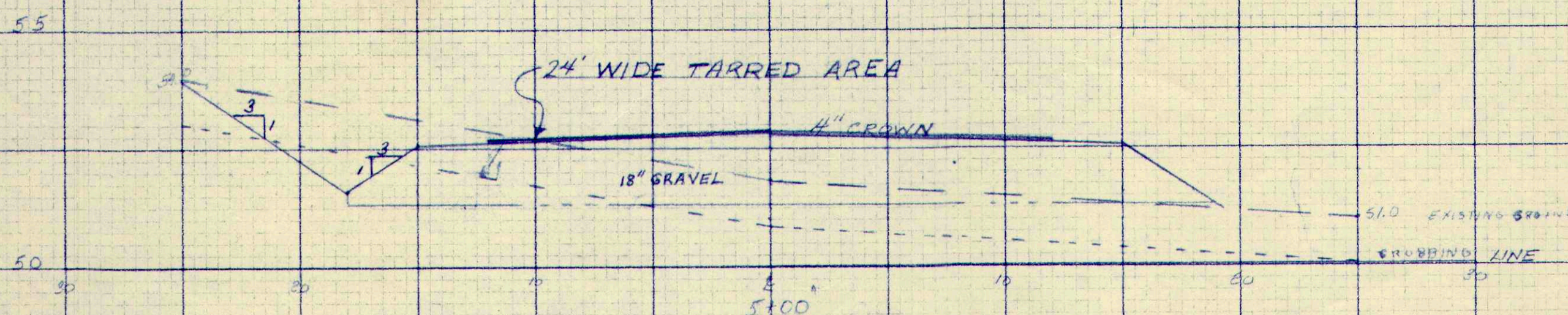
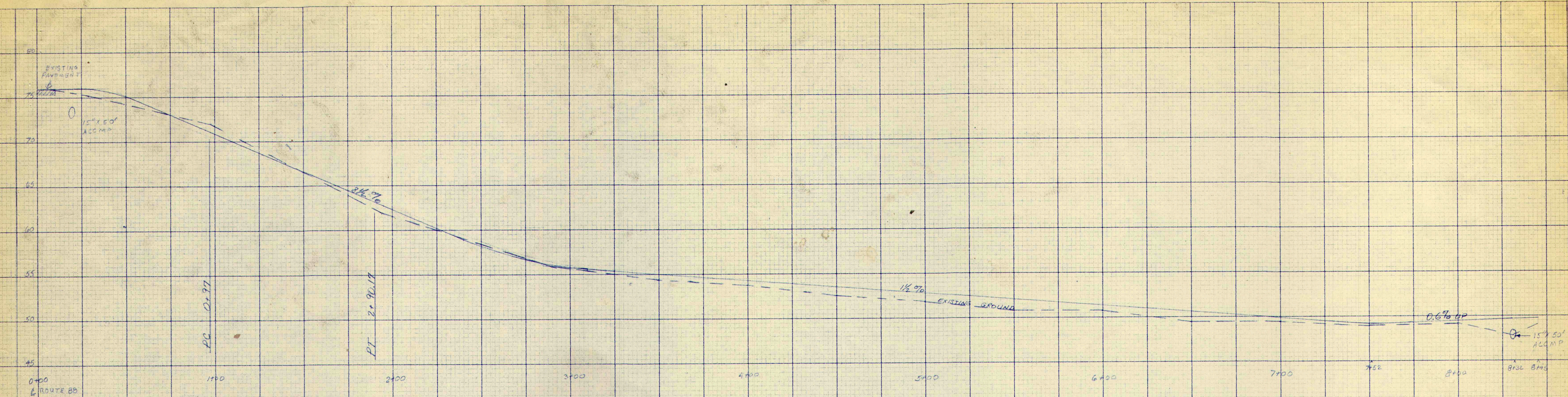

APPROVED BY CUMBERLAND PLANNING BOARD
CHAIRMAN
DATE

PROFILE OF LEDGE ROAD at SCHOONER ROCKS CUMBERLAND, MAINE		
OWEN HASKELL CIVIL ENGINEER CAPE ELIZABETH, MAINE		
DRAWN BY: JHC	BOOK NO. 3/14	JOB NO. 6924
SCALE: As shown	DATE: 7/6/69	DRWG NO. 3

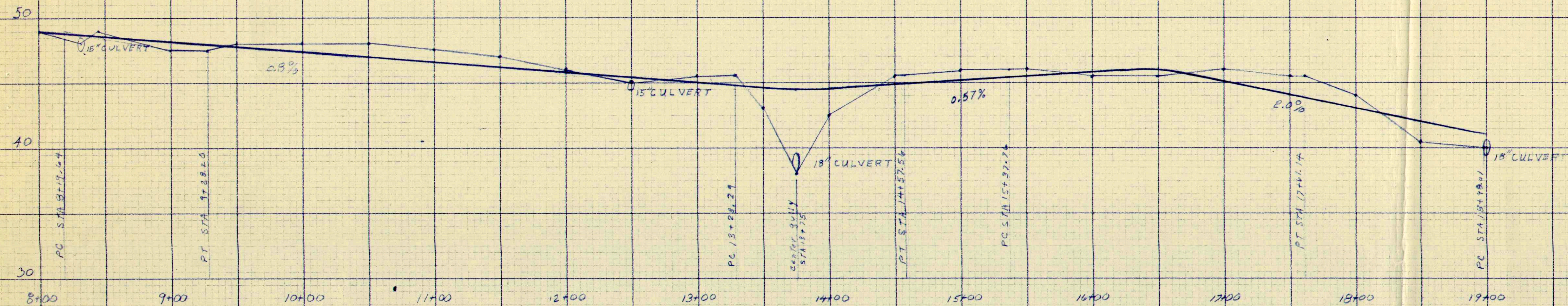

LEDGE ROAD

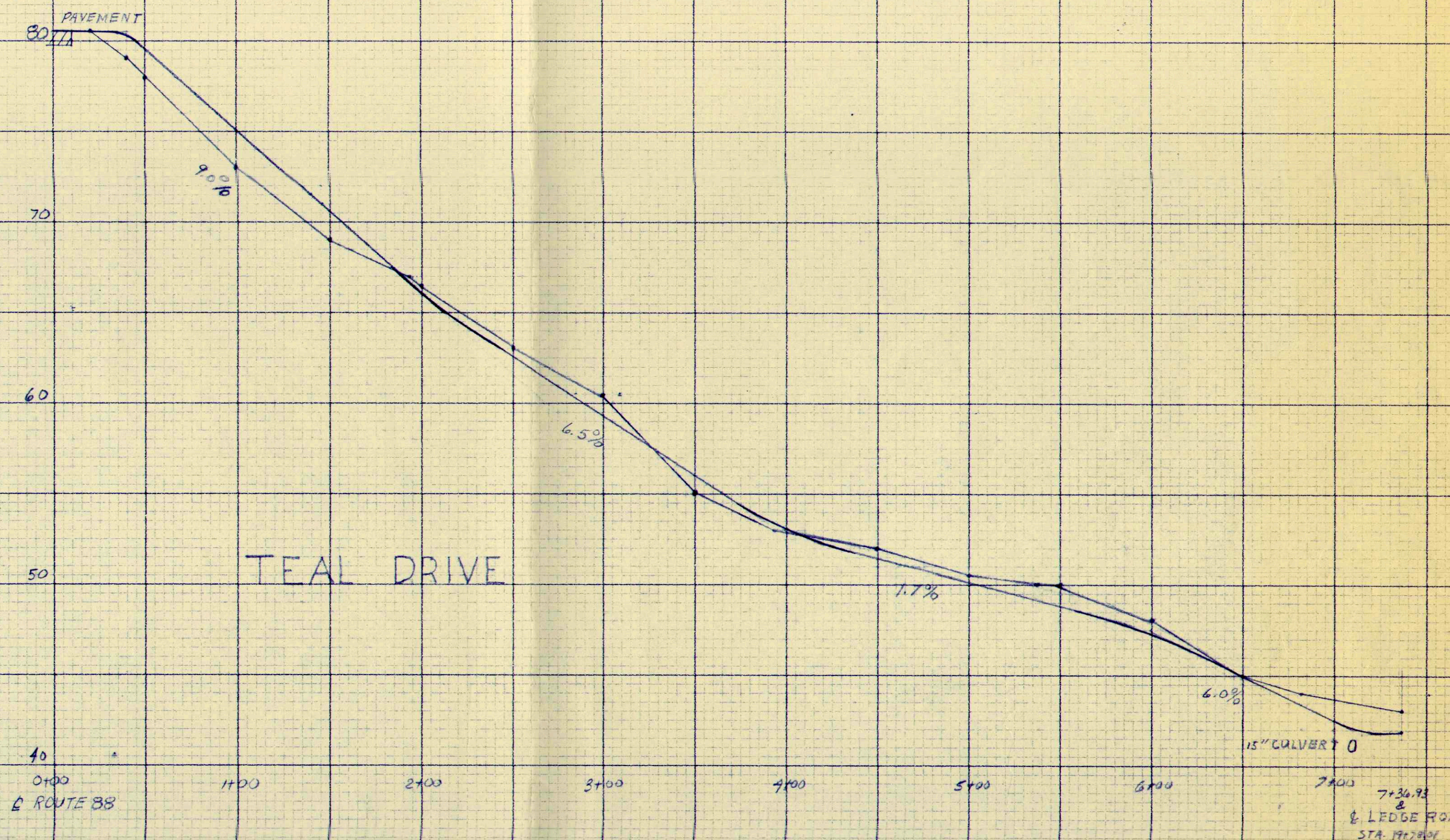
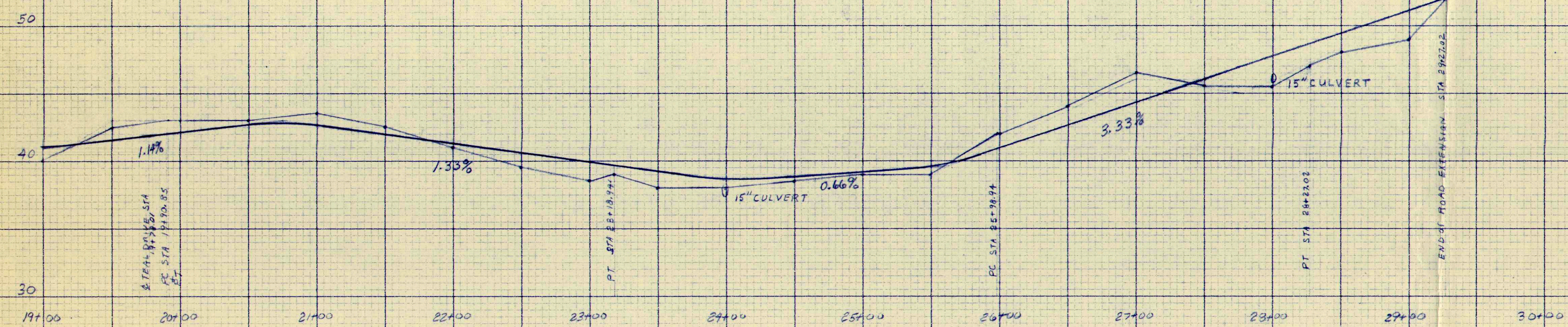

TEAL DRIVE

PROFILE OF
LEDGE ROAD EXTENSION
and
TEAL DRIVE
at
SCHOONER ROCKS
CUMBERLAND, MAINE
OWEN HASKELL
CIVIL ENGINEER
CAPE ELIZABETH, MAINE
DATE 11/19/64 JOB NO 6424

A.1.1 CUT 57.0
 original ground

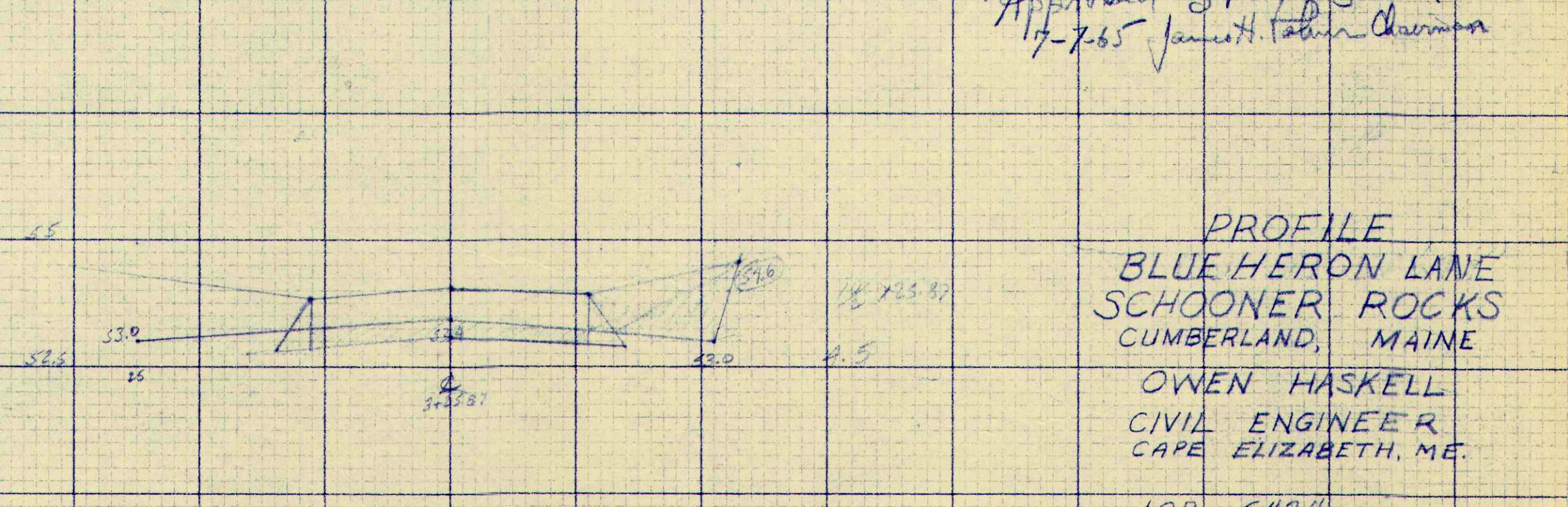
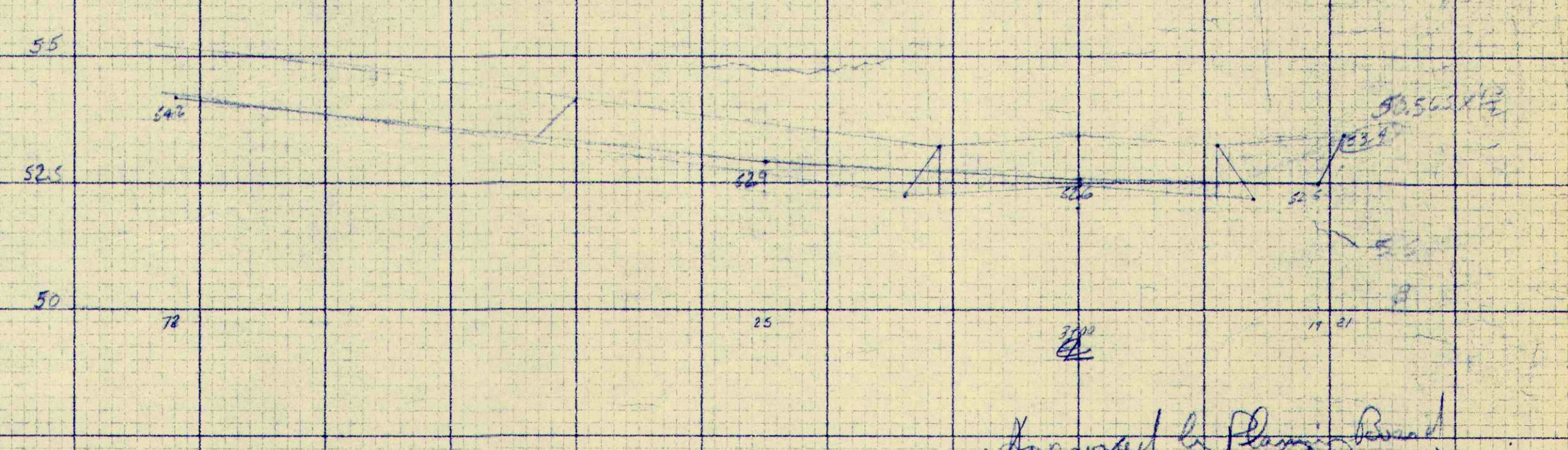
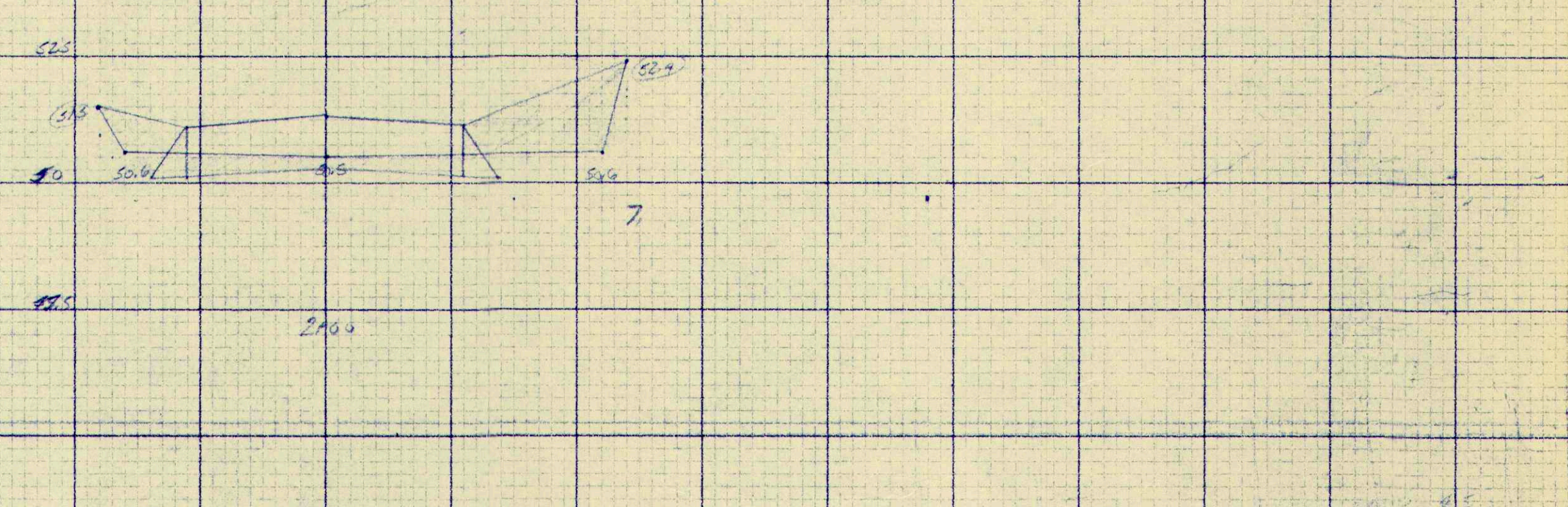
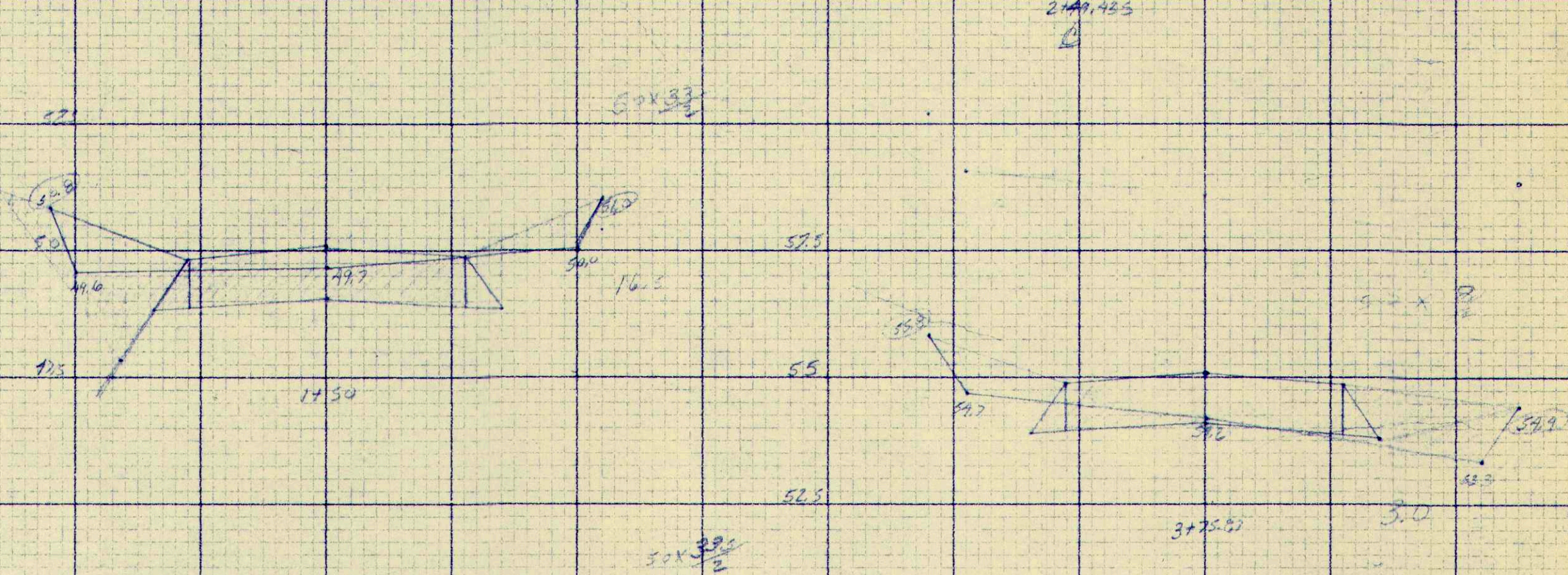
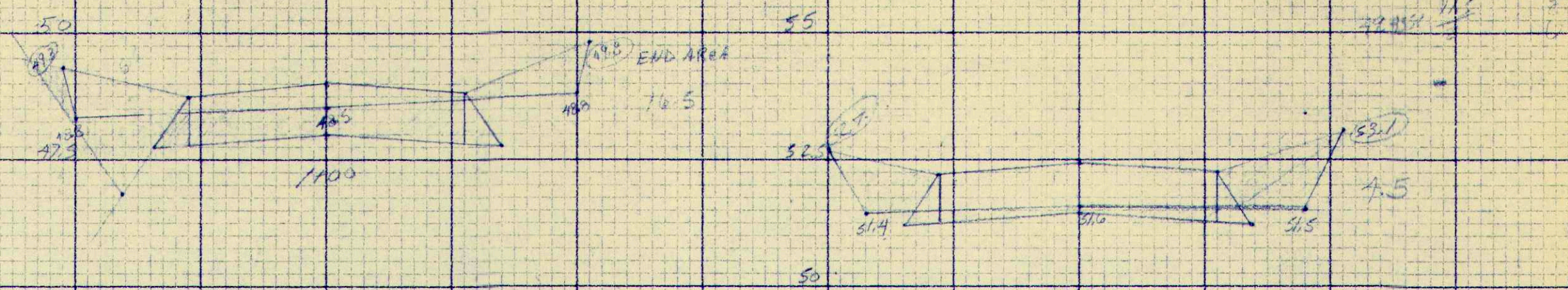
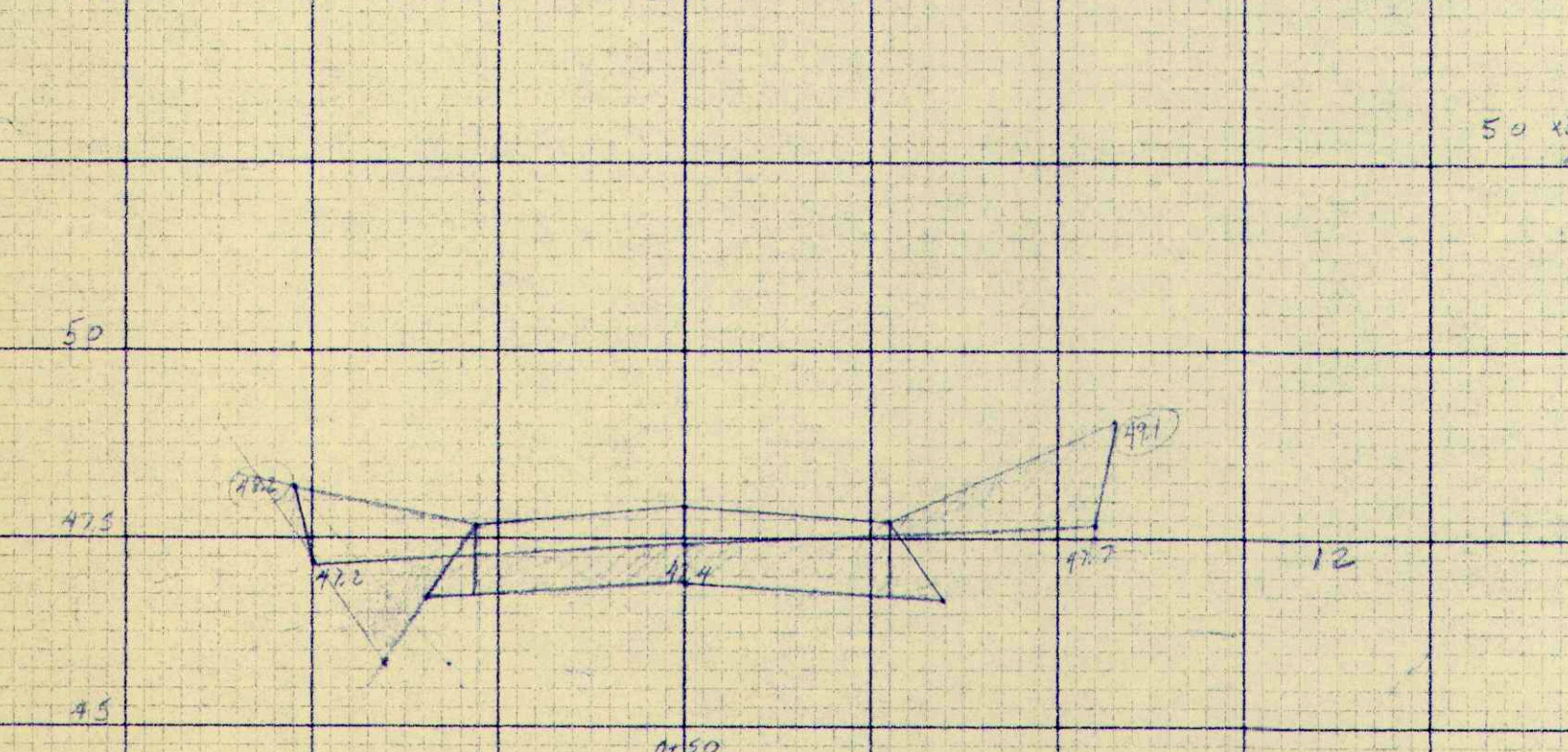
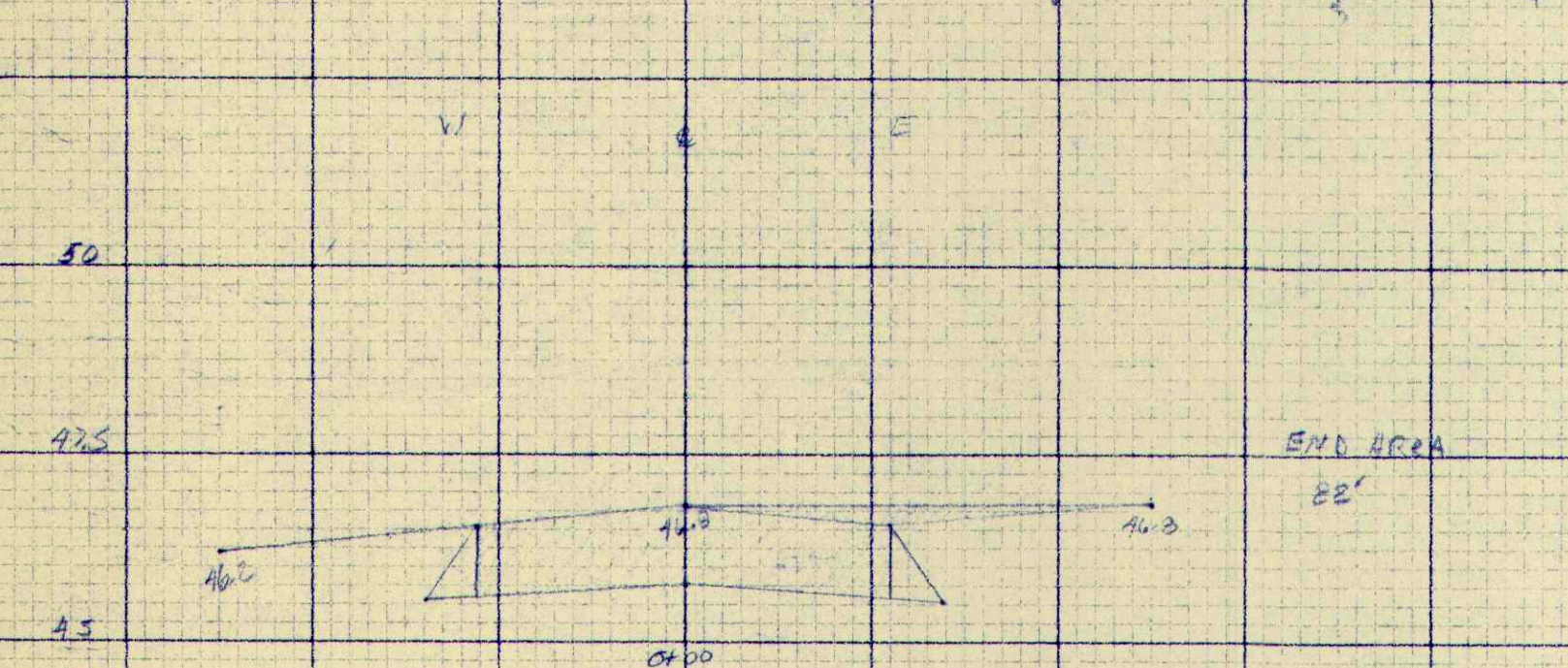
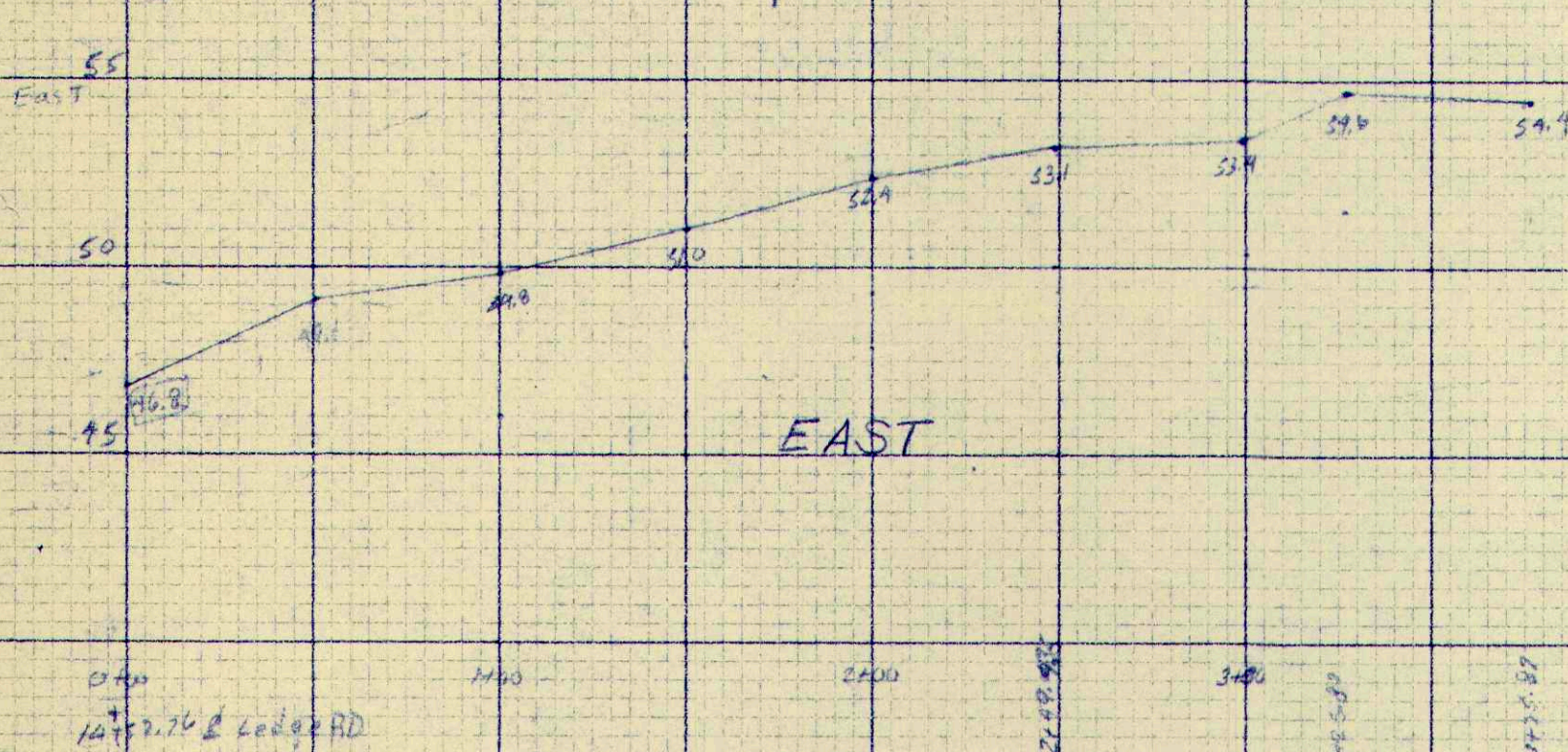
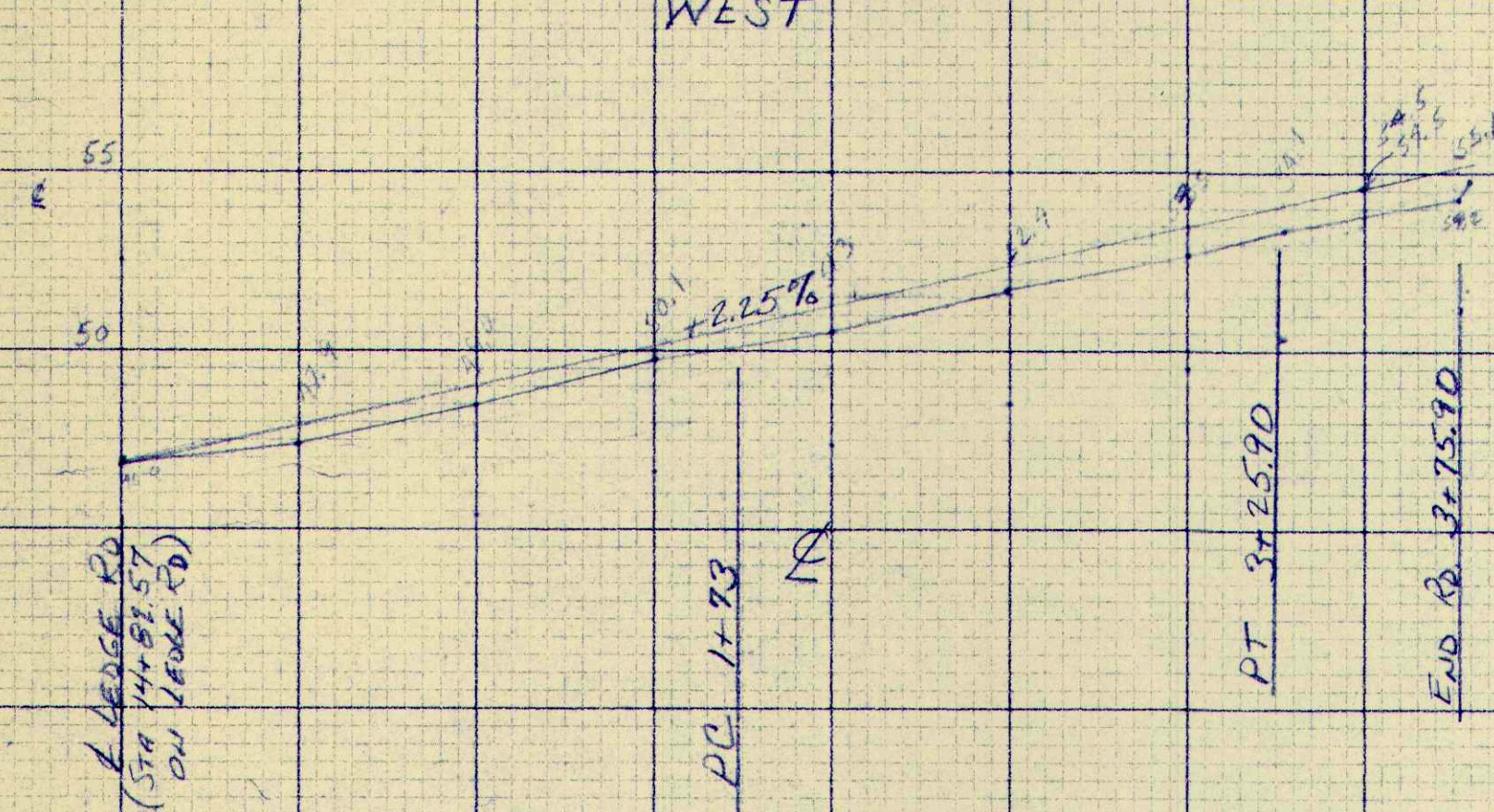
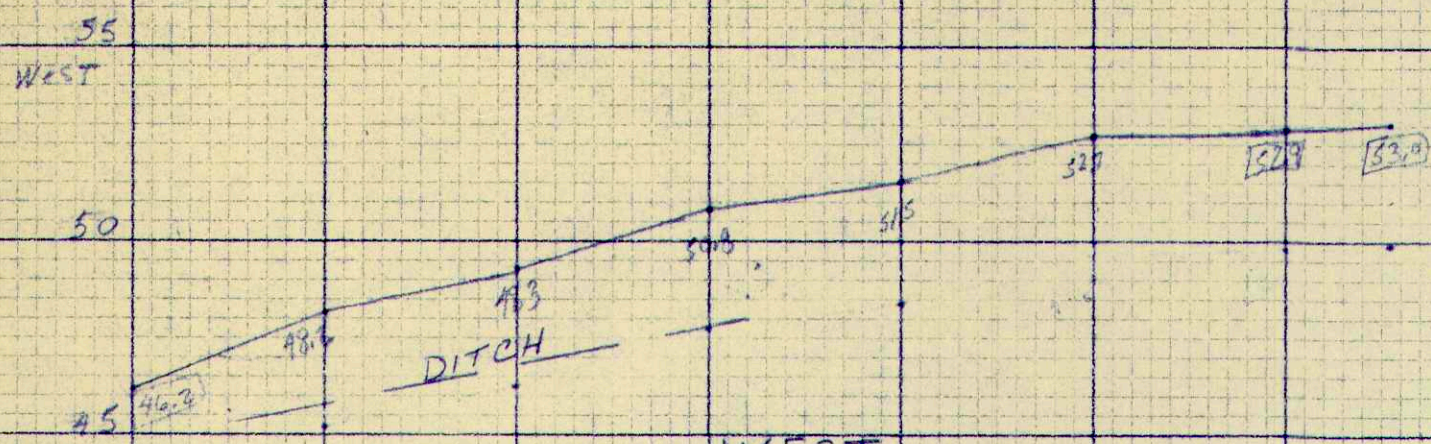

Approved by Planning Board
 7-7-65 James H. Fisher Chairman

PROFILE
 BLUE HERON LANE
 SCHOONER ROCKS
 CUMBERLAND, MAINE

OWEN HASKELL
 CIVIL ENGINEER
 CAPE ELIZABETH, ME.

JOB 6424
 APRIL 14, 1965