

Forrest
Dorsey

PRELIMINARY

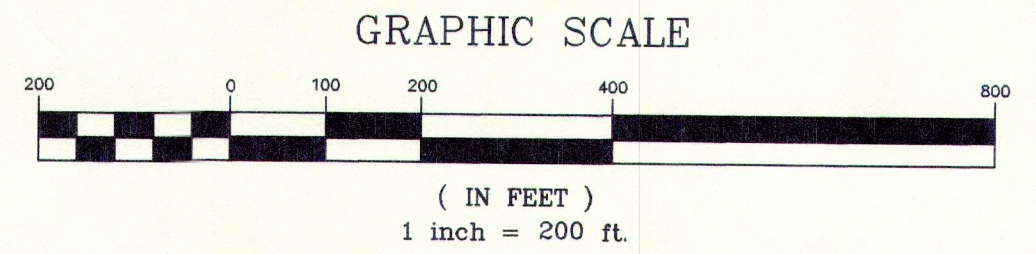

I CERTIFY THIS SURVEY CONFORMS TO THE STANDARDS OF
THE MAINE BOARD OF LICENSURE FOR PROFESSIONAL LAND
SURVEYORS AS CATEGORY 1, CONDITION III
WITH THE FOLLOWING EXCEPTIONS:
MARKERS NOT SIZED
MARKERS NOT SET AT EVERY ANGLE POINT
NO REPORT WRITTEN

STANDARD BOUNDARY SURVEY	REV 3:
ON	REV 2:
GREELY ROAD	REV 1:
CUMBERLAND, CUMBERLAND COUNTY, MAINE	BY:
FOR	DATE 9/9/1996
THE TOWN OF CUMBERLAND	FID/DSK 5
OWNER OF RECORD: GREGORY & KATHERINE FOWLER	JOB # 96015C
168 GREELY RD	
CUMBERLAND ME 04021	
WALT DUNLAP, PLS PO BOX 377 * CUMBERLAND * ME * 04021 TEL/FAX 207-829-4200	

PARADISE

- LEGEND
- IRON ROD SET
 - IRON ROD FOUND
 - GRANITE MARKER FOUND
 - UTILITY POLE
 - TREE WITH WIRE EMBEDDED
 - FLOWAGE
 - FENCE LINE

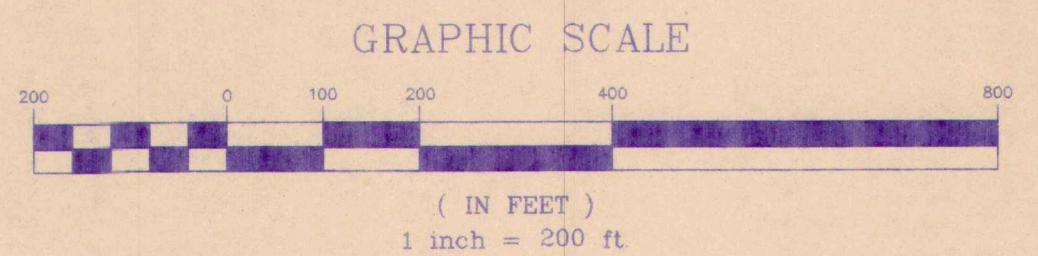

NOTES

1. LOCUS DEEDS, CORD 10357/131, 7676/77, 4369/345
2. DEEDS TO RR INTEREST, CORD 882/220, 420/253
3. IN PRINCIPLE THE RELATIONSHIP BETWEEN PROPRIETORS' LOTS IS PERFECTLY RECTANGULAR, THIS PARCEL COMPRISING IN PART ALL OF LOT 81. THE LOSS OF ANY ANCIENT MONUMENTS IN SUPPORT OF THESE LINES CREATES AN ASSUMPTION TO HOLD LINES OF LONG-ESTABLISHED OCCUPATION AS INDICATED BY WALL LINES, WIRE REMNANTS AND OTHER PHYSICAL INDICATIONS. THIS SURVEYOR HAS DONE THAT IN THE CASE OF THE LINES COMMON WITH DILLENBACK, GORMAN, MINING AND SWEETSER THE SURVEYED LINE OF DILLENBACK (SEE PLAN REFERENCES) IS ACCEPTED HERE AS SHOWN. THE LINE COMMON WITH OTHERS IS DRAWN FROM THE DILLENBACK/GORMAN CORNER TREE TO THE IRON ROD FOUND AT THE APPROXIMATE RR RIGHT OF WAY.
4. THE BROOK AS BOUNDARY IS SUBJECT TO CHANGE. IT WAS LOCATED 8/8/96.
5. THE WIRE LINE WAS HELD AS THE FORMER BOUNDARY BETWEEN KINNEY AND BLANCHARD AND 400' IS MEASURED ALONG THE ROAD TO REFLECT THE LANGUAGE OF CORD 4369/345 (MANS TO FOWLER).
6. RE-CALCULATION OF THE RR RIGHT OF WAY IS IMPAIRED BY THE COMPLETE REMOVAL OF THE TRACK THAT SERVED AS A BASELINE AND THE MONUMENTS THAT ACCOMPANIED IT. THIS SURVEY USES MILE POST MARKER 185 AS STATION 344+11.0 AND SETS THE TRACK BASELINE 13.2' FROM, AND PARALLEL TO, THE EXISTING TRACK CENTERLINE.
7. WATER RIGHTS TO SPRING NOT DETERMINED.
8. GREELY ROAD SIDELINE IS ASSUMED.

PLAN REFERENCES

1. MAINE CENTRAL RR VALUATION SHEET V1/7, DATED 6/30/1906
2. PLAN OF LAND FOR ZANICKOWSKY BY HODKINS, CORD PLAN BK 196, PAGE 263
3. PLAN FOR ROBERT DILLENBACK BY CARPENTIER, CORD PLAN BK 194, PAGE 113
4. MERRILL'S PLAN, CORD PLAN BK 24, PAGE 14

I CERTIFY THIS SURVEY CONFORMS TO THE STANDARDS OF THE MAINE BOARD OF LICENSURE FOR PROFESSIONAL LAND SURVEYORS AS CATEGORY 1, CONDITION II WITH THE FOLLOWING EXCEPTIONS:
MARKERS NOT SET AT EVERY ANGLE POINT
NO REPORT WRITTEN

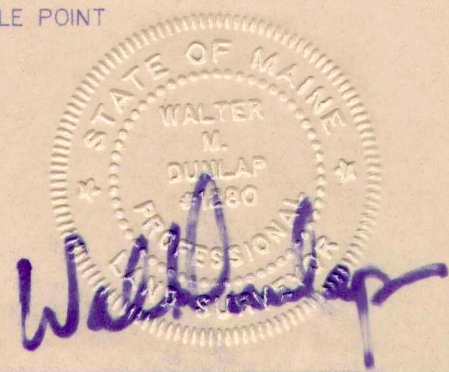

STANDARD BOUNDARY SURVEY	REV. 3
ON	REV. 2
GREELY ROAD	REV. 1
CUMBERLAND, CUMBERLAND COUNTY, MAINE	BY:
FOR	DATE 6/18/1996
THE TOWN OF CUMBERLAND	FB/DSK 5
OWNER OF RECORD: GREGORY & KATHERINE FOWLER	JOB # 96015C
168 GREELY RD CUMBERLAND ME 04021	
WALT DUNLAP, PLS PO BOX 377 • CUMBERLAND • ME • 04021 TEL/FAX 207-829-4200	

Walt Dunlap, Land Surveyor
PO Box 377 - Cumberland - ME - 04021
Phone/Fax: 207-829-4200

Legal Description for Gregory and Katherine Fowler

A certain parcel of land westerly of, and adjacent to, Greely Road in the Town of Cumberland, Cumberland County, Maine, more particularly described as follows:

Beginning at an iron rod set and the intersection of the westerly sideline of Greely Road and the southerly sideline of the right of way now or formerly of the Maine Central Railroad;
Thence S 23°23'43" E along said westerly sideline a distance of 563.23' to an iron rod set;
Thence S 56°53'07" W across land of the grantors a distance of 320.00' to an iron rod set;
Thence S 28°19'17" W across land of the grantors a distance of 492.64' to an iron rod set;
Thence S 26°27'25" W across land of the grantors a distance of 446.47' to an iron rod set;
Thence S 10°02'50" W across land of the grantors a distance of 295.12' to an iron rod set;
Thence S 34°08'46" E across land of the grantors a distance of 349.70' to an iron rod set;
Thence N 70°39'48" E across land of the grantors a distance of 375.12' to an iron rod set;
Thence N 51°22'37" E across land of the grantors a distance of 794.51' to an iron rod set
and the westerly sideline of said road;

Thence S 23°23'43" E along said westerly sideline a distance of 666.10' to an iron rod set
and land now or formerly of Stephen Smith as described in Cumberland County Registry of Deeds (CCRD) book 10834, page 37;

Thence S 66°36'17" W along the land of said Smith a distance of 698.24' to an iron rod set;

Thence S 23°03'40" E along the land of said Smith and land now or formerly of Janet

Zanichkowsky, as described in CCRD book 4887, page 75, a distance of 594.19' to an iron rod set;

Thence S 23°03'40" E along the land of said Zanichkowsky a distance of 25', more or less,
to the thread of a brook;

Thence westerly by the thread of said brook a distance of 1,263', more or less, to a point
and land now or formerly of Eugenia Dillenback, as described in CCRD book 1837, page 99;

Thence N 41°06'15" W along the land of said Dillenback a distance of 25', more or less, to
an iron rod set;

Thence N 41°06'15" W along the land of said Dillenback a distance of 768.11' to a corner
tree with embedded wire and land now or formerly of William and Dawn Gorman as described in
CCRD book 11274, page 169;

Thence N 38°33'27" W along the land of said Gorman and land now or formerly of Claire
and Gregory Vining as described in CCRD book 6720, page 180, and land now or formerly of
Constance and Richard Sweetser as described in CCRD book 2845, page 13, a distance of
1,991.76' to an iron rod set and the southerly right of way of said Railroad;

Thence Northeasterly by said right of way a distance of 2,435.5', more or less, to the point
of beginning;

Said parcel contains 100 acres, more or less, according to a survey by Walt Dunlap, PLS
of Cumberland, Maine, to be recorded in the Cumberland County Registry of Deeds, to which
reference is made for the basis of bearing.



- A Baseball
- B Softball
- C Multi Purpose Field
- D Existing Fields
- E Parking 125 Cars
- F Parking 200 Cars
- G Concessions / Storage
- H Toilets / Storage
- I Field House / Pool
- J Ice Hockey

- Tree Line
- Property Line
- 5' Contour

Note: Base information for planning purposes only. Follenbach boundary by Walt Dunlap, D. Bay. Additional survey by Squawam COG.

North

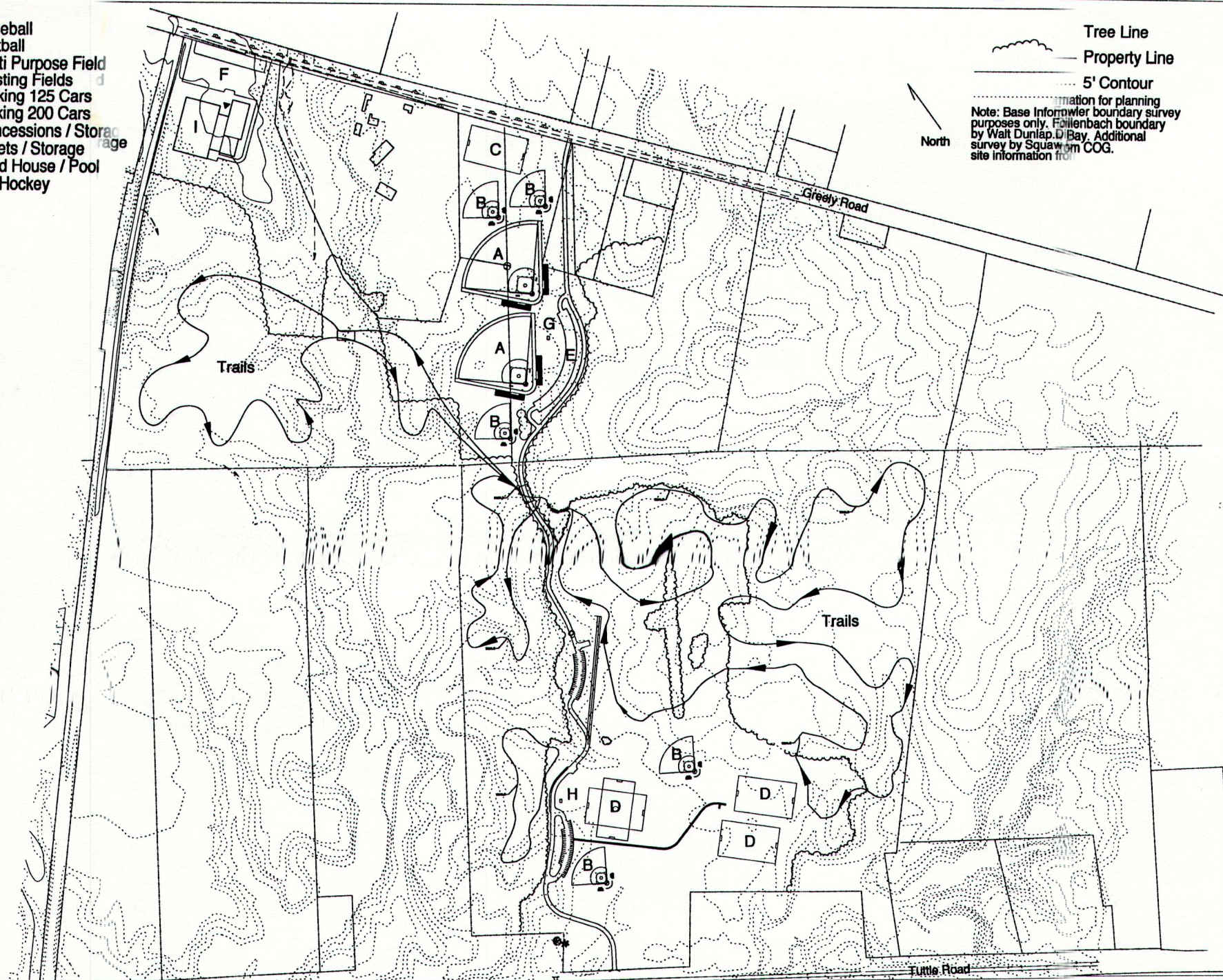

Orcutt
A s s o c i a t e s

Planning
Architecture
Landscape Architecture
Interior Design

25 Bridge Street
Yarmouth, Maine 04096

Telephone 207 846 7702
Facsimile 207 846 5107

Transmittal

Date: 6/13/97
Job Number / Name: Cumberland Recreation Master Plan

To: Bob Benson

Address: Town Hall

Sent via: hand

Items sent:	Date:	Quantity:	Title:
	June, 1997	5	8 1/2 x 11 Recreation Master Plan
	June, 1997	4	30 x 42 Recreation Master Plan

sent by: Mitchell Rasor