

# Summertime in the Belgrades



... Serving the Central Maine Lakes & Kennebec River Corridor

— A Cider Mill Press Publication —

VOLUME 17, NUMBER 7

## Come Celebrate Smithfield's 175th Anniversary!

**M**aine's only leap year town is celebrating 175 years and we want you to join us for an unforgettable celebration! Mark your calendar for Friday, July 31 through Sunday, August 2nd, 2015. More on this later...let's start with a bit of Smithfield's history so you can get to know us a little better before you arrive!

Smithfield was incorporated on February 29, 1840 making it "Maine's only Leap Year Town." It was incorporated from parts of Dearborn to the south, Mercer to the west and East Pond Plantation to the north and east. Prior to the incorporation, this area was known as "Greeley's Mill," a farming and lumbering community. There were numerous farms back then with two still in operation today along with a few family owned lumbering businesses as well. Smithfield has since become a favorite destination for travelers from all over the world who come to recreate on North and East Ponds located on either side of our beautiful town.

In the late 1800s and early 1900s the town boasted a hotel, store, post office, restaurant, and blacksmith shop; a true destination. In 1895 the town built its first and only church, the Smithfield Baptist Church. In the early 1900s two major fires in the Village of Smithfield changed the center of town and many businesses did not rebuild. Today in the village there is still a mechanic for hire, a public beach at Sunset Camps, where families have returned to the



same cabins each summer for 100 years and the Sunbeam Roller Rink. Starting out as a dance pavilion known as North Pond Casino and later North Pond Roller Skating Rink, it is Maine's only open air, wooden floor rink. Built in 1922, most children who come to enjoy the fast paced action today are direct descendents of original roller skaters.

Another piece of history in the heart of the village is the Fairview Grange #342. It's managed by an active and lively group of volunteers who have grown the membership and visibility over the past few years with collaborative efforts from the North Pond Association and Duratherm

Windows. The original hall, built in 1913, burned in 1915. That structure was destroyed again in 1986; the current hall was built on the same spot along the shore of North Pond.

The rock is chiefly a variety of granite. The soil is a clay loam, yielding well in hay, oats, and potatoes, --which are the crops principally cultivated. The beech, birch and maple are the principal forest trees. The manufactories consist of one saw-mill for long lumber, one shingle-mill, a grist-mill and a fuel saw-mill. The nearest railroad station is at south Norridgewock, 5 miles distant. The stations at North Belgrade and at West Waterville are each 8 miles. Smithfield was formed from parts of Mercer and Dearborn, and called East Pond Plantation. It was incorporated under its present name Feb. 29, 1840. Among the valued citizens should be mentioned Rev. Henry Smith, Caleb Gilman, John Copeland, Francis Allen, Wales Gould, Dennison Haynes, Peter Libbey, Barnabas Allen, S.N. Marston, John Piper, Oliver Parsons and others. The town has quite a number of residents over 70 years of age, and one that is 93. It sent about 70 men to aid in the war for the Union, and lost 14 of them. There are two Free Baptist societies which sustain meetings in Smithfield. The number of school-houses is seven, --valued at \$1,125. The population in 1870 was 704. In 1880 it was 564. The valuation in 1870 was \$168,599. In 1880 it was \$142,662. The rate of taxation is 23 mills on the dollar.



**Mid-Maine Marine Inc.**  
885 Kennedy Memorial Drive, Oakland, ME 04963  
1/2 Mile West of Exit 127 off I-95 • 1-800-649-2628  
[www.midmainmarine.com](http://www.midmainmarine.com)

**INFLATABLES SALE**

**10% OFF**  
IN STOCK  
TUBES & TOWABLES

*Wings Hill*  
*Inn & Restaurant*

Gourmet Dining  
Culinary Institute Chefs  
Casually Elegant Accommodations  
Attentive Service

BELGRADE LAKES  
[www.wingshillinn.com](http://www.wingshillinn.com)  
207-495-2400

CIRCA 1800

**Paddleboards Sales & Rentals**  
**Thule Car Racks (Installed)**  
#1 INDEPENDENT OLD TOWN DEALER IN THE WORLD

*Old Town*

**Kayaks and Canoes**

**DEMO POND**

KAYAK & CANOE RENTALS  
Great Selection of Paddles and Life Jackets  
Belgrade Lakes and Stream Group Tours  
Outlet Prices  
• Old Town • Necky • Ocean Kayak

**BELGRADE CANOE & KAYAK**  
[www.kayakandcanoe.com](http://www.kayakandcanoe.com)  
Route 27 North, 9 Miles from Augusta Civic Center  
495-2005

100's in Stock





## CALENDAR OF EVENTS

### Friday, July 31

LOCATION: Fairview Grange #342 5-7pm -"Saturday Night Supper on a Friday Night" Featuring.... BEAN HOLE BEANS/franks/brown bread/biscuits

5-7pm -Live Music by Maine's Blues Guitarist Dave Mello and Kevin James

### Saturday, August 1

LOCATION: Smithfield Post Office -commemorative 175th cancellation stamp>>> today only! Get yours now!

LOCATION: Smithfield Baptist Church Loon Call 5k - 7:30am registration \$5 ... 8am Start Time

LOCATION: Fairview Grange #342 OUTSIDE 10-2pm North Pond Association Booth, Information, 10am & 1pm Float Boat Tours, first come, first serve (weather & water condition dependent), NPA merchandise for sale, Are You Buff Enough? How to Become LakeSmart-er, Buffer Plant Sale, membership drive East Pond Association Booth, Information, EPA merchandise for sale, LakeSmart information, membership drive

LOCATION: Sunbeam Roller Rink 2-4pm \$2 suggested donation to benefit SVFD

LOCATION: Municipal Complex-ONGOING activities FREE Family FUN , Historical Reading, Smithfield Library Open House, Antique Tractors, Antique

Motors, Fonzo's Concessions on sale all day, Balloon Twister, Face Painting, 70 ft inflatable Obstacle Course, Bounce House, Dunk Tank and so much more!

10-2 pm SVFD PIE IN THE FACE > Get your ticket to vote on whom should WIN the PIE IN THE FACE! & Theme Raffle Baskets! Tickets available at the Fire House! Drawing for both events -2pm

10-2pm Face Painting, Inflatable Obstacle Course, Bounce House, Free Cotton Candy, Free Sno Cones, Balloon Twister

10-2pm Smithfield Library Open House, Children's Corner, Get a library card and use the Free WiFi

11:30am Presentation of The Making of Smithfield, by Mel Croft and Richard Witham - Buy a book & get yours signed today!

12-1pm Magician Walk About...Now you see it, now you don't!

1-2pm The Great Stephan Magic Show! Come be amazed at this Award Winning Magic Show! FREE Family FUN! ABRACADABRA!

4-6pm -ELVIS PRESLEY REVUE!! Featuring Don Boudreau LOCATION: Sunset Camps Dollar Days -\$1 gets you a day at the beach and a variety of menu items at The Snack Shack for just \$1

LOCATION: Fairview Grange #342 INSIDE - Refreshments for purchase all day; coffee, tea, soft drinks and snacks

ARTS & CRAFTS FAIR 9am-1pm -Local Artists, Live Music, Crafts, Demonstrations, home/garden skills, something for all ages

4-5pm -"Poetry in the Grange -Carrying the Torch" Hosted by published local poet Douglas "Woody" Woodsum with very special guest, Maine's Poet Laureate, Wesley McNair

7-10pm -Dance to the music of Shiloh Creek

LOCATION: Smithfield Maine Historical Society 9-3pm Open House & Tours -History comes alive!

LOCATION: Morrow's Garage & The Old Fire Station 10am - 2pm -Classic Car Show -Sponsored/presented by Ray Morrow's Garage

### Sunday, August 2

10am -12pm SVFD Fire Attack Demonstration, stop by and check out the fire trucks and learn what it takes to fight a fire.

10am - Special 175<sup>th</sup> Smithfield Baptist Church Service ~*MAKING JOYFUL NOISE* - featuring Chime Choir, Vocal Choir and Worship Band, Hymns Praise Choruses

**1:30pm Leap Year Town Parade!**  
**Grand Marshal - Smithfield's returning son, Brigadier General Darren Hartford**

Parade Route - Lake View Drive through the Village of Smithfield  
4pm - Re-Dedication of the Municipal Complex - 926 Village Road

Speakers -Timothy Downing and Town Selectmen  
For More Information please call (207) 362 4772 or email: [fieldmaine.us](mailto:fieldmaine.us) [office@smithfieldmaine.us](mailto:office@smithfieldmaine.us)  
*Anniversary Celebration Cake for everyone!*



*The best relationships begin with a good conversation.*

At Inland Family Care, we don't just talk. We listen. And we want to involve you in your care – helping you stay healthy and well while treating you with respect, compassion and concern.

So give us a call and *tell us about yourself!*

**Now Accepting New Patients!**

**465-7342**

 **Inland Family Care**  
A Department of Inland Hospital  
EMHS MEMBER

74 Water Street • Oakland, ME • 465-7342  
[inlandhospital.org](http://inlandhospital.org)



Inland is a member of EMHS and connected to EMMC to benefit our patients and communities.





Table of Contents

Smithfield Turns 175!.....1-2

Table of Contents..... 3

Great Pond Film Connection.....3

Oakland's Awesome OakFest.....4

LakeSmart Tip; Satellite Flyovers..... 5

Directory of Not-To-Miss Places.....6-7

Calendar of Events, Outings and More..... 8-9

Upcoming: Great Doings Ahead..... 10

Kennebec Corridor Map..... 11

Belgrades and Beyond Map.....12-13

Cobbossee Watershed Map..... 14

MIFF Final Days.....15-16

Take It Outside by Pete Kallin..... 17

Accommodations: Sleeping Well.....18

Notebook, News Trivia, Announcements.....18

Dining and Deli: The Best of the Region.....19

Open Farm Day Coming Up.....19

Business Directory: Services, Shops, Stops..... 20-21

Common Arts; Colby Art..... 22

Conservation Too: The Importance of Soil..... 23

Angkor's Children: MIFF Film With a Great Pond Connection

Angkor's Children is a beautiful, moving, thought-provoking film that transports viewers to the other side of the world - Cambodia - yet has very strong Maine connections. Directed by Lauren Shaw, a long-time enthusiastic seasonal resident of Great Pond and a third-time MIFF veteran, the film follows three young Cambodian women as they create new cultural identities through traditional ("smot" singing), survival (circus) and contemporary (pop band) art disciplines.

In a country where 50% of the population is under the age of 21 and 90% of artists and intellectuals were eliminated by the Khmer Rouge, there is a tremendous void of cultural identity - and of hope, hope for the future and hope for women. "We needed to tell the world there is hope," Shaw states. "Art brings back souls, brings back hope."

Sponsored by the Mid-Maine Global Forum, "Angkor's Children will be shown on Saturday, July 18 at 12:15 pm at Railroad Square Cinema. Lauren Shaw will be at the screening along with Mu Sochua, a Cambodian politician and rights activist who appears in the film, to answer questions and discuss Cambodia today.

MIFF Offers Unique Day-Long Series of Events for Maine Filmmakers

On Saturday, July 18, MIFF will offer Maine filmmakers a chance to showcase their work and network with each other during Making It In Maine Day

The day-long event will include a brunch and panel discussion at the Colby College Museum of Art, multiple screenings of Maine-based films and the annual Maine Student Film and Video Festival.

"MIFF always seeks to include locally made films, both short films and feature length, and it is nice to host a day on which you can see a Maine-associated film in any time slot during the festival," said Shannon Haines, Festival Director.

The days starts off with a networking brunch where filmmakers can meet each other as well as representatives from the Maine Film Center, the Maine Film & Video Association, the Maine Film Office, and the Maine Public Broadcasting Network. Following the brunch, there will be panel discussion, entitled "Indie Filmmaking and Social Change: The Global Challenge." Facilitated by Louise Rosen of the Maine Jewish Film Festival, the panel will include international filmmakers Claus Drexel, Huseyin Karabey, and Nick Brandestini along with Maine filmmakers Alban Maino and Craig Saddlemire.

On Making It in Maine Day, MIFF will screen a series of Maine-made and associated films, including Michael Boucher's The Hungry Years, The Strange Eyes of Dr. Myes and a series of Maine shorts.

Summertime in the Belgrades

--A Cider Mill Press Publication--

PO Box 290, Belgrade Lakes, ME 04918

Editor: Esther J. Perne, 207-495-3777 • ebelnews@earthlink.net

Advertising Director: Erle Morse, 207-495-3777 • ebelnews@earthlink.net

Layout Design: Michael Breault, 207-578-0226 • mo.breault@gmail.com

Webmaster : Gregor Smith • gregor@roadrunner.com

www.sumbelnews.com

This publication is copyrighted ©MMXV, Cider Mill Press Publications, All Rights Reserved.

CSS Cayer

Security Services, Inc.

COMMERCIAL & RESIDENTIAL

Burglary & Fire Alarm Systems

Video Surveillance & CCTV

Access Control

24 Hour UL Listed Monitoring Service

453-9177

www.cayersecurity.com

NORTH BAY ESTATES

ROUTE 8 • NORTH BELGRADE

~ FOR SALE ~

Custom Built Homes

by Craig's Carpentry

1 & 2 acre lots

with lake views from

Great Pond overlook

Craig Alexander

cell (207) 649-3749 • crgsnbe@yahoo.com

Join us...and help protect our lakes!

Protect and Preserve

B.L.A.

EST. 1908

Belgrade Lakes Association

137 Main Street, Belgrade Lakes, Maine 04918

207-512-5150 • www.belgradelakesassociation.org





## — Legacies —

Oakland will be bringing back an old tradition of community celebrations this summer with lots of fun and activities for the entire family July 24-26th with its first annual OakFest! A three day celebration is planned centering around family fun for all ages. Plan to come and join us and meet and celebrate with others right here in your neighborhood. .

We will be kicking off our celebration July 24th, Friday evening at 6pm with a HOME TOWN SUMMERTIME PARADE! Onlookers can expect to see many floats, antique and specialized cars, fire trucks, marching units and an old-time favorite! We are encouraging our community to help us gather nonperishable food items for our local food pantry, so all parade entries are asked to bring an item per participant ...AND... we are asking everyone along the parade route to bring items that we will have folks collecting as well. We are calling it our CANNED DEED! We have also added an old time favorite – a Children’s Bike Parade sponsored by Century 21 and Mathieu’s Cycle! Children and bikes are asked to gather at the cycle shop on Main Street and proceed to Century 21 for the award of prizes for the kids. . Hardy Taylor was selected as this year’s GRAND MARSHALL and he will lead us off with pride! The parade will line up at Messalonskee High School and head down to Pleasant Street crossing over to West Pleasant and up Main and Church Streets. Anyone interested in joining us can find a registration form on the OakFestMaine website.

Directly following the parade we will be putting on our dancing shoes and turning the music up! Upper Main Street will be closed off and we will be hosting a community Street Dance for all ages. DJ/Comedian Seth "Coocha" Couture will be rockin’ the block and promises to keep you all up and moving and keeping spirits high. Valley Distributors & The Thirsty Mule will be sponsoring this event along with a beer tent for those over 21. We will have plenty of food vendors and soft drinks available for all ages.

Saturday brings a full day of events starting with a Pancake Breakfast at the Oakland United Baptist Church 7am to 9am with all the fixings for just \$5. All the proceeds will be donated to their Ministries programs. The grounds of Williams Elementary and Messalonskee Middle Schools on Pleasant Street will come alive at 10 am with something for everyone!! Visitors will have a chance to eat some great local foods from Fresh Ellas Ice Cream, Spiro Greek Foods, Laurie’s Lunch, Flatlanders BBQ, Korner Store and the Gray Goose Gourmets just to mention a few! Local artists such as Rosie’s Artistry, My Monkey Closet, Nora’s Crafts, Bette Robjents Felted Animals and so many more will be selling and demonstrating their wares. Many civic groups will be on hand as well as a variety of others with items to showcase. A stage area will be set up with many different performances from our local signing police officer, dance troupes, guitarist and many more scheduled throughout the day. We haven’t forgotten the kids,

as we will have a large children’s area available, with a bounce house, petting zoo, games and crafts. It is not too late to grab a spot if you want to showcase your items. Vendor/Crafter registration is also available on the website.

We will wrap up our events with the first annual Paddle \* Pedal \* Pound the Pavement Triathlon! This event is for all ages and will feature three legs including: a 2.5 paddle on Messalonskee Lake, a 12 mile bike leg around the outskirts of Oakland and a 3.1 mile run though our trails and streets! Participants can do the event solo or in teams of 2 or 3, choosing to break the legs up among teammates. This is meant to be fun and enjoyable as well as a way to showcase our great outdoor activities here in Oakland. Ribbons will be awarded to all that participate and prizes will be awarded for various age groups. Information to register can be found at Active.com or on the OakFest Maine website.

Our festival really is made possible by all the support of local business and community leaders and is meant to celebrate all Oakland has to offer! We are grateful for all the support and encouragement from committee members and citizens. We look forward to this being a very successful annual event and hope you will join us. Visit our website for more information at [www.oakfest-maine.com](http://www.oakfest-maine.com) or see us on Facebook at OakFest Oakland Maine! For further information, please contact the Oakland Town Office 465-7357.



2015



# FARMINGTON SUMMER FEST

MAINE

## Saturday, July 25

DOWNTOWN FARMINGTON

*Proudly brought to you by the Farmington Downtown Association*

Time	Event	Location
9:00am - 2:00pm	Farmer's Market	Lower Broadway
10:00am - 12:00pm	Northwoods Law	Broadway
10:00am - 5:00pm	Store Sales, Contests & Events	Downtown
10:00am - 5:00pm	Vendors & Demonstrations	Broadway & Park
10:00am - 9:30pm	Live Performances	Broadway, Park, Main St.
10:00am - 5:00pm	Old Tyme Fun & Games	Meetinghouse Park
10:30am - 1:30pm	Historic Horse & Wagon Tour	Downtown
1:00pm - 3:00pm	Fire Truck Rides	Front Street
1:00pm - 4:30pm	The Great Float Race	Sandy River
1:00pm - 5:00pm	Pie on the Porch	Holman House Main St.
2:00pm - 4:30pm	Disc Golf	Lower Field off Front St.
5:30 and 6:15	Road Race	Broadway
7:00pm - 8:00pm	Street Dance	Broadway
8:00pm - 9:30pm	Evening Concert	Meetinghouse Park



Sponsors

# Experience the Legend



Absinthe Verre

[www.treespiritsofmaine.com](http://www.treespiritsofmaine.com)

Bronze Medal NY International Spirits Competition 2015  
Tree Spirits, New England's only distiller of Absinthe. Oakland, ME





—Conservation—

A Tip from LakeSmart



Prevent run-off from your property by installing infiltration steps. They absorb and slow water down to reduce phosphorus from polluting the lake.

For more information contact the Youth Conservation Corp at [brcacc@belgradelakes.org](mailto:brcacc@belgradelakes.org) or call 495-6039

Monitoring Lakes by Satellite

Groundtruthing Landsat Satellite Images with Secchi Readings



The efforts of volunteers to collect Secchi data matching flyover dates of the Landsat 8 satellite is paying off, according to DEP Biologist Linda Bacon. This technology has the potential to be able to identify algae blooms from space! Bacon says that "volunteer data will be more valuable than ever to help calibrate the satellite."\_As the Landsat 8 satellite orbits the earth it takes photos of Maine lakes and ponds (as well as other features of the earth's surface). The satellite images could be used to help characterize the transparency for many Maine lakes (thousands!) for which we do not have current water quality data. Volunteer lake monitors can play an important role in helping to "ground truth", or calibrate the satellite images by taking Secchi disk transparency readings on the days when the satellite passes over Maine.

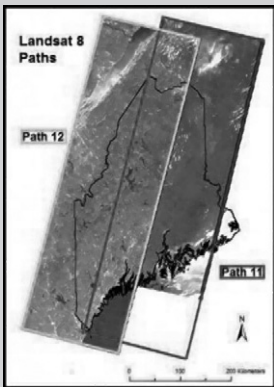

Path 11 Dates	Path 12 Dates
7/20/2015	7/27/2015
8/5/2015	8/12/2015
8/21/2015	8/28/2015
9/6/2015	9/13/2015
9/22/2015	9/29/2015
10/8/2015	10/15/2015
10/24/2015	10/31/2015

You Enjoy Your Home Away From Home



Heather Ryan NMLS #407596  
[hryan@mainestatecu.org](mailto:hryan@mainestatecu.org)



Todd LaPlante NMLS #407682  
[tlaplante@mainestatecu.org](mailto:tlaplante@mainestatecu.org)

Why Not Keep Your Mortgage At Home With Us?

Competitive Rates  
Low Closing Costs  
Your Mortgage Stays Local



1-800-540-8707 | [www.mainestatecu.org](http://www.mainestatecu.org)







## Calendar Directory

### TOWN BY TOWN...

GREAT VISITS, AWESOME OUTINGS – ART, MUSIC, CULTURE, HISTORY, RECREATION, FARMERS' MARKETS, TRAILS, SCENIC SITES, AND MORE...

#### AUGUSTA

- **Viles Arboretum**, 224 acres with 6 miles of year round walking trails, including art and sculpture trail, open dawn to dusk, Visitor Center open Monday-Friday, 9 am-4 pm, admission free, 626-7989, [www.vilesarboretum.org](http://www.vilesarboretum.org), 153 Hospital Street
- **Farmers' Market at the Arboretum**, indoors, Friday 1-5 pm
- **Art in the Capitol**, Maine Arts Commission monthly self-guided exhibits in State House hallways (Mon-Fri 8 am-5 pm), Blaine House (call for times), and Maine Arts Commission Office (8:30am-4:30 pm), 287-6746, [mainearts.maine.gov](http://mainearts.maine.gov)
- **Children's Discovery Museum, CDM**, hands-on displays, activities, Tuesday-Thursday 10 am-4 pm, Friday-Saturday 10 am-5 pm, Sunday 11 am-4 pm, admission, 622-2209, [www.childrensdiscoverymuseum.org](http://www.childrensdiscoverymuseum.org), 171 Capitol Street
- **Danforth Gallery**, Jewett Hall, art exhibits, UMA-1234, [www.uma.edu](http://www.uma.edu)
- **Governor's Mansion**, 1830 Blaine House, Tuesday-Thursday 2-4 pm, 287-2121, [www.blainehouse.org](http://www.blainehouse.org), State Street
- **Holocaust and Human Rights Center of Maine**, Michael Klahr Center, Monday-Friday 8 am-4 pm, 621-3530, [www.hhrc.uma.edu](http://www.hhrc.uma.edu), University of Maine at Augusta, off Route 27
- **Kennebec Historical Society**, Wednesday-Friday 10 am-2 pm, 622-7718, [www.kennebechistorical.org](http://www.kennebechistorical.org), 107 Winthrop Street
- **Maine State Museum**, Tuesday-Friday 9 am-5 pm, Saturday 10 am-4 pm, \$2 adults, \$1 ages 6-18, 287-2301, [www.maine statemuseum.org](http://www.maine statemuseum.org)
- **Maine State House**, Hall of Flags, House and Senate Rooms, Klir Beck dioramas, Monday-Friday 8 am-5 pm, book tours at Maine State Museum, walk-ins welcome 9 am-1 pm, 287-5600, [www.maine.gov](http://www.maine.gov), State Street
- **Maine State Library**, Monday-Saturday opens 9 am, 287-5600, [www.maine.gov/msl/](http://www.maine.gov/msl/), State Street
- **Museum in the Streets**, walking/history tour, [www.augustamaine.gov](http://www.augustamaine.gov), Water Street/downtown.
- **Old Fort Western**, 1754 fort, house, store, 1-4 pm daily, admission \$6, 4-14 years \$4, 626-2385, [www.oldfortwestern.org](http://www.oldfortwestern.org), Cony Street
- **Riverfront Park**, boat launch, Greenway Trail, playground, eastside Kennebec River
- **Kennebec River Rail Trailhead**, Maine State Housing Authority parking lot, 623-8162, [www.krrt.org](http://www.krrt.org), Water Street
- **UMA Fitness Trail**, 2 miles of wooded trails, near Civic Center, Route 27
- **Farmers' Market at Mill Park**, Tuesday 2-6 pm, 626-2305, [www.farmersmarketmillpark.org/](http://www.farmersmarketmillpark.org/), North Water Street
- **Farmers' Market at Turnpike Mall**, 549-5112, Wednesday and Saturday 10 am-1 pm, Western Avenue

#### BELGRADE LAKES

- **Great Pond Mailboat**, 592-1537, Monday-Saturday 9 am, Post Office, Main St.
- **Spring Gallery**, cast bronze display at MLRC, 495-3113,

[www.springgallerymaine.com](http://www.springgallerymaine.com), 137 Main Street

- **The Belgrade Community Center for All Seasons**, pool and lakefront, gym, playground, picnic area, rec programs, 495-3481, [www.belgrademaine.com](http://www.belgrademaine.com), 1 Center Drive
- **Union Church Coffee House**, check for schedule, 7:00 pm, \$5, 495-3599, [www.unionchurchmaine.org](http://www.unionchurchmaine.org), Main Street
- **Belgrade Historical Society**, 465-7924, [belgradehistoricalsociety.org](http://belgradehistoricalsociety.org)
- **Farmers' Market**, Sun 8 am-1 pm, 465-7058, [www.belgradelakesfarmersmarket.org](http://www.belgradelakesfarmersmarket.org), Main Street
- **Peninsula Park on Long Pond**, picnic tables, Main Street
- **Maine Lakes Resource Center**, 512-5150, [www.maine lakesresourcecenter.org](http://www.maine lakesresourcecenter.org), 137 Main Street

#### FAIRFIELD

- **Fairfield Historical Society**, 1890 Cotton-Smith History House, every Tuesday 9 am-12 noon and 1-4 pm and second Saturday of month, 453-2998, [www.fairfieldmehistoricalociety.net](http://www.fairfieldmehistoricalociety.net), 42 High Street
- **Farmers' Market**, 948-5724, Wednesday 2-6 pm, Saturday 9:30 am-1:30 pm, Nazarene Church parking lot, 81 Main Street

#### FARMINGTON

- **Farmington Historical Society**, Titcomb House Museum, 778-4275, Wednesday and Saturday, 11 am-2 pm, July-August, [www.farmingtonhistory.org](http://www.farmingtonhistory.org), 118 Academy Street
- **Nordica Homestead Museum**, opera singer Lillian Nordica costumes, jewelry, mementos, 778-2042, Tuesday-Saturday 10 am-12 noon and 1-5 pm, Sunday 1-5 pm, [www.lilliannordica.com](http://www.lilliannordica.com), 116 Nordica Lane, Holley Road
- **Contra Dance**, 491-9928, [www.starleft.org](http://www.starleft.org) 2nd Saturday of the month, all welcome, 6:30-7:30 pm family dance, 8-11 pm regular dance, admission, Grange Hall, Bridge Street, Route 43, West Farmington
- **University of Maine campus and Arboretum**, four walking tours with informal guide pamphlet to campus trees, 581-1541, [www.umaine.edu/arboretum/](http://www.umaine.edu/arboretum/), downtown
- **Farmers' Market**, 778-6602, Friday 9 am-2 pm, Better Living Center parking lot, Front Street; Saturday 8 am-12 noon, Main Street
- **Meetinghouse Park and Gazebo**, weekly concerts throughout summer, downtown
- **Fairgrounds**, events throughout summer, Franklin County Fair in September, High Street

#### GARDINER

- **Artdogs and Circling the Square Fine Art Press**, Friday 1-5 pm, Saturday 10 am-4 pm, 582-6600, [www.theartdogs.com](http://www.theartdogs.com), 275-277 Water Street
- **Johnson Hall Performing Arts Center**, 582-7144, [www.johnsonhall.org](http://www.johnsonhall.org) 280 Water Street
- **Monkitree**, art exhibits, 512-4679, [www.monkitree.com](http://www.monkitree.com), Tuesday-Friday 10 am-6 pm, Saturday 12-6 pm, 263 Water Street
- **SpinOff Studio**, 588-7297, [spinoffstudio.org](http://spinoffstudio.org), Monday-Friday 8:30 am-4:30 pm, 405 Water Street
- **Farmers' Market**, 512-8022, [www.gardinerfarmersmarket.org](http://www.gardinerfarmersmarket.org), Wednesday 2-6 pm, rain or shine, The Common
- **Kennebec River Rail Trail**, 623-8162, [www.krrt.org](http://www.krrt.org), access near Gardiner/Randolph Bridge, 6.5 miles to Augusta
- **Waterfront Park**, picnicking, events throughout summer, Kennebec River
- **The Center for Maine Craft**, 9 am-8 pm daily, 588-0021,

[www.mainecrafts.org](http://www.mainecrafts.org), West Gardiner Service Plaza, Route 126 off Routes 95 and 295

#### GREENE

- **Araxine Wilkins Sawyer Memorial**, free entertainment programs, monthly - Fri 2 and 7 pm, 946-5311, [www.sawyer-foundation.com](http://www.sawyer-foundation.com), 371 Sawyer Rd, off Rt 202

#### HALLOWELL

- **Harlow Gallery**, Kennebec Valley Art Association, 622-3813, [www.harlowgallery.org](http://www.harlowgallery.org) Wed- Sat, 12-6 pm, 160 Water Street
- **Gaslight Theater**, 626-3698, [www.gaslighttheater.org](http://www.gaslighttheater.org) City Hall, 1 Winthrop Street
- **Museum in the Streets**, history / walking tour, [www.historichallowell.org](http://www.historichallowell.org), downtown
- **Farmers' Market**, 622-1350, Sun 3-6 pm, Water Street
- **Vaughn Woods**, 166 acre park / trails / homestead, Middle Street
- **Kennebec River Rail Trail**, [www.krrt.org](http://www.krrt.org), to Augusta, Farmingdale/Gardiner, Water Street
- **Waterfront Park**, North Water Street

#### HINCKLEY

- **L.C. Bates Museum** at Good Will-Hinckley School, early 20th century natural history and cultural exhibits, nature trails and camps, adults \$3, up to 17 years \$1, 238-4250, [www.gwh.org](http://www.gwh.org) Wednesday-Saturday 10 am-4:30 pm, Sunday 1-4:30 pm, Route 201

#### KINGFIELD

- **High Peaks Artisan Guild and Gallery**, local artwork and crafts, 245 Main St., Friday, Saturday and Sunday 11-5
- **Ski Museum of Maine**, 265-2023, [www.skimusuemofmaine.org](http://www.skimusuemofmaine.org), 256 Main Street
- **Stanley Museum**, 265-2729, [www.stanleymuseum.org](http://www.stanleymuseum.org), memorabilia/displays on photographs, violins and Stanley Steamers, Tuesday-Sunday 1-4 pm, 40 School Street

#### LIVERMORE

- **Washburn-Norlands Living History Center**, 18th-19th century mansion / farmstead / schoolhouse, library, chapel, 897-4366, [www.norlands.org](http://www.norlands.org), admission, living history tours Tuesday and Thursday 1-4 pm, 290 Norlands Road

#### MADISON

- **Lakewood Theater**, Maine's Summer Theater, Young Performers Camp, 474-7176, [www.lakewoodtheater.org](http://www.lakewoodtheater.org), Route 201
- **Skowhegan School of Painting and Sculpture**, 474-9345, [www.skowheganart.org](http://www.skowheganart.org), summer evening artists lecture series, East Madison Road

#### MONMOUTH

- **Monmouth Museum**, local and regional Maine history, Wednesday-Sunday 1-4 pm, 933-2287, [www.monmouthmuseuminc.org](http://www.monmouthmuseuminc.org), 751 Main Street
- **The Theater At Monmouth**, The Shakespeare Theater of Maine, Cumston Hall, 933-9999, [www.theateratmonmouth.org](http://www.theateratmonmouth.org), Main Street

#### MOUNT VERNON

- **D.E.W Animal Kingdom**, Zoo, 293-2837, 918 Pond Rd, Route 41
- **Villages Market**, farmers/crafters, Saturday 10 am-2 pm (start 6/29), next to Flying Pond Store, [sharihamilton@gmail.com](mailto:sharihamilton@gmail.com), Route 41

## PAUL HANNA'S PLUMBING



**207-495-3805**

New Homes and Remodels ~ Camps  
Water and Sewer Pumps ~ Water Filtration  
Paul Hanna, Licensed Master Plumber



Elliot B. Thayer, PLS, PE  
Andrew Dunbar, PLS, LPF, LSE

PROFESSIONALS WITH  
LONGSTANDING TIES TO THE  
BELGRADE LAKES REGION

17 Hasson Street  
Farmingdale, ME 04344-1613  
582-7762  
[www.thayereng.com](http://www.thayereng.com)

## G & L CONTRACTING

New Construction, Additions, Renovations

Dock Installation and Construction

[www.gandlcontractingmaine.com](http://www.gandlcontractingmaine.com)

**207-495-9009**





NEW PORTLAND

- **Nowetah's American Indian Museum and Craft Shop**, 628-4981, [www.nowetahs.webs.com/](http://www.nowetahs.webs.com/), daily 10 am-5 pm, free, 2 Colegrove Road, Route 27
- **Wire Bridge**, 1864, probably only wire suspension bridge in U.S., off Route 27

NEW SHARON

- **Farmers' Market**, Saturday 9 am-1 pm, Douin's Market, 491-9025, 150 Mercer Road, Routes 2/27
- **New Sharon Historical Society**, Saturday 1-3, Routes 778-4167, 2/27

NORRIDGEWOCK

- **Norridgewock Historical Society Museum**, 1838 building, Saturday 10 am-1 pm, 634-5032, [www.norridgewock.com](http://www.norridgewock.com), Mercer Road, Route 2
- **Oosoola Park**, picnic area, great playground, boat launch, on Kennebec River, Route 8

OAKLAND

- **Macartney House Museum**, Oakland Area Historical Society, 465-7549, Wednesday 1:30-4:30 pm, 1815 home with antique furnishings and Oakland artifacts, 25 Main Street
- **Town Parks**, playground, picnic tables, swimming area, boat launch area, Belgrade Road on Lake Messalonskee and McGrath Pond Road on McGrath Lake
- **Farmer's Market**, Friday 2-6 pm, 465-3094, Pine Acres Parking Lot, 895 Kennedy Memorial Drive

READFIELD

- **Readfield Historical Society and Museum** in 1853 school-house, 685-4662, [www.readfieldhistorical.org](http://www.readfieldhistorical.org), Thursday and Saturday 10 am-2 pm or by appointment, Route 17, Readfield Depot

ROME

- **Mt. Philip Grange**, suppers 3rd Sat of month, 4:30-6 pm, all you can eat beans, cornbread, rolls, chop suey, pies, Routes 135/225
- **Trails: Mount Philip**, Route 225; The Mountain, Route 27; **French's Mountain** and **Kennebec Highlands**, Watson Pond Road; for information call 495-6039 or visit [www.belgradelakes.org](http://www.belgradelakes.org); maps available at BRCA, 137 Main Street, Belgrade Lakes

SIDNEY

- **New England Music Camp**, concerts free and open to the public, Bowl-in-the-Pines on Lake Messalonskee, 465-3025, [www.nemusiccamp.com](http://www.nemusiccamp.com), 8 Goldenrod Lane, Route 23
- **Sidney Historical Society**, 724-8032, [www.sidneyhistoricalsociety.org](http://www.sidneyhistoricalsociety.org), 2986 Middle Road
- **Silver Spur Riding Club**, horse shows, River Road, Route 104

SKOWHEGAN

- **Margaret Chase Smith Library**, residence, home, museum exhibits, 474-7133, [www.mcslibrary.org](http://www.mcslibrary.org), free, Monday-Friday, 10 am-4 pm, 54 Norridgewock Ave.
- **History House Museum**, 1800s local history and culture, heirloom gardens, free, Tuesday-Saturday, 10 am-4 pm, 474-6632, [www.skowheganhistoryhouse.org](http://www.skowheganhistoryhouse.org), 66 Elm Street
- **Fairgrounds**, weekly horse shows/competitions, free public

events, covered arena, Skowhegan State Fair in August, 474-3621, Madison Avenue, Route 201

- **Farmers' Market**, Wednesday 3-6 pm, Saturday 9 am-1 pm, weekly entertainment, 938-3906, Somerset Gristmill parking lot, downtown

SMITHFIELD

- **Fairview Grange**, 362-2791, Route 8
- **Smithfield History Society** "The Groves House," 634-4392, 21 Lakeview Drive
- **Sunbeam Roller Rink**, 362-4951, 830 Village Rd, Route 8
- **Sunset Camps**, public beach, 362-2611, [www.sunsetcamps.com](http://www.sunsetcamps.com), 834 Village Road, Route 8

UNITY

- **Unity College Centre for the Performing Arts**, folk genre music, 568-3147, [www.unitymaine.org](http://www.unitymaine.org), 42 Depot Street.

WATERVILLE

- **Aqua City Actor's Theatre (ACAT)**, 873-7000, [www.acattheatre.org](http://www.acattheatre.org). Waterville Opera House Studio Theater, Main Street
- **Museum in the Streets**, downtown history / walking tour, [www.themuseuminthestreets.com/waterville.htm](http://www.themuseuminthestreets.com/waterville.htm)
- **Head of Falls Park/Two Cent Bridge**, historic foot bridge over Kennebec River connecting Waterville and Winslow, Front Street
- **Common Street Arts**, 872-2787, [www.commonstreetarts.org](http://www.commonstreetarts.org), Wednesday-Saturday 12-6 pm, 16 Common Street
- **Colby College Museum of Art**, 859-5600, [www.colby.edu/museum/](http://www.colby.edu/museum/) Tuesday-Saturday 10 am-5 pm, Sunday 12-5 pm, free admission, Colby College Campus, Mayflower Hill
- **Colby College Special Collections**, Miller Library, Monday-Friday 10 am-12 noon and 1-4 pm, free admission
- **Thomas College Art Gallery**, 180 West River Road
- **Waterville Historical Society and Redington Museum**, 1814 home and pharmacy, 872-9439, [www.redingtonmuseum.org](http://www.redingtonmuseum.org). Tuesday-Saturday tours at 10 and 11 am, 1 and 2 pm, 62 Silver Street
- **Waterville Opera House**, 873-7000, [www.operahouse.com](http://www.operahouse.com), 93 Main Street
- **Farmers' Market**, Thursday 2-6 pm, 680-2055, [www.watervillefarmersmarket.org](http://www.watervillefarmersmarket.org), The Concourse parking lot

WAYNE

- **Farmers' Market**, 685-4657, <http://waynefarmersmarket.weebly.com>, Saturday 9 am-noon, Town Green, at the Mill Pond, Main Street

WILTON

- **Wilton Farm & Home Museum**, 645-2091, 645-4578, [www.thewiltonfarmandhomemuseum.org](http://www.thewiltonfarmandhomemuseum.org), Saturday 1-4 pm or by appointment, 10 Canal Street

WINSLOW

- **Fort Halifax on the Kennebec River**, historic fort tower, park, Route 201

WINTHROP

- **Norcross Park**, playground, picnic site, boat launch on Maranacook Lake
- **Farmers' Market**, 446-2899, Tuesday and Saturday 9 am-1 pm, town office parking lot, 17 Highland Avenue

ASSOCIATIONS/GROUPS

THE BELGRADES...

- **East Pond Association**, Smithfield/Oakland, [www.eastpond.org](http://www.eastpond.org)
- **North Pond Association**, Smithfield/Rome/Mercer, [www.northpond.net](http://www.northpond.net)
- **McGrath Pond/Salmon Lake Association (MPSLA)**, Belgrade/Oakland, PO Box 576, Oakland, 04963, 873-5285, [www.mcgrathpond-salmonlake.org](http://www.mcgrathpond-salmonlake.org)
- **Great/Long Ponds: Belgrade Lakes Association (BLA)**, Belgrade/Rome/Mount Vernon, PO Box 551, 137 Main Street, Belgrade Lakes, 04918, 512-5150, [www.belgradelakesassociation.com](http://www.belgradelakesassociation.com)
- **Friends of Messalonskee Lake Watershed**, Oakland/Belgrade/Sidney, PO Box 532, Oakland, 04963, 465-4622, [www.snowpond.org](http://www.snowpond.org)
- **Belgrade Regional Conservation Alliance and BRCA Conservation Corps**, PO Box 250, 137 Main Street, Belgrade Lakes, 04918, 495-6039, [www.belgradelakes.org](http://www.belgradelakes.org)
- **Belgrade Lakes Region Business Group (BLRBG)**, PO Box 518, Belgrade Lakes, 04917, 465-4915, [www.belgradelakesmaine.com](http://www.belgradelakesmaine.com)
- **Maine Lakes Resource Center/Docks to Doorways**, PO Box 431, 137 Main Street, Belgrade Lakes, 04918, 495-3617, 620-6029, [www.minelakesresourcecenter.org](http://www.minelakesresourcecenter.org)

BEYOND...

- **Friends of the Cobbossee Watershed**, PO Box 5003, Augusta, 04332-5003, 621-4100, [www.watershedfriends.com](http://www.watershedfriends.com)
- **Franklin County Soil & Water Conservation District**, 107 Park Street, Farmington 04938, 778-4279, [www.franklincswcd.org](http://www.franklincswcd.org)
- **Kennebec County Soil & Water Conservation District**, 21 Enterprise Drive, Augusta 04330, 622-7847, ext. 3, [www.kcswcd.org](http://www.kcswcd.org)
- **Somerset County Soil & Water Conservation District**, 12 High Street, Skowhegan 04976, 474-8324, [www.somersetswcd.org](http://www.somersetswcd.org)
- **Kennebec Land Trust (KLT)**, PO Box 261, 331 Main Street, Winthrop, 04364, 377-2848, [www.tkl.org](http://www.tkl.org)
- **Kennebec Messalonskee Trails**, PO Box 2388, Waterville, 04903, 873-6443, [www.kmtrails.org](http://www.kmtrails.org)
- **Kennebec River Rail Trail**, PO Box 2195, Augusta, 04338, 623-8162, [www.krrt.org](http://www.krrt.org)
- **30 Mile River Watershed Association (30 MRWA)**, Kimball Pond in Vienna to the Androscoggin River, PO Box 132, Mt Vernon, 04352, 685-4956, [www.30mileriver.org](http://www.30mileriver.org)
- **Maine Lakes Society**, formerly Congress of Lake Associations, PO Box 447, 137 Main Street, Belgrade Lakes, 04918, 1-855-463-2652
- **Central Maine chapter of the New England Mountain Bike Association (CeMeNEMBA)**, 441-6227, [www.cemenemba.org](http://www.cemenemba.org)



Additions/Updates/Corrections: Please contact Summertime in the Belgrades, 495-3777, with changes to this Directory.



**622-6353**

Cut to order  
in lengths from 14" to 23"

**Green Certified Wood, Seasoned, & Ash**  
Cut, Split & Delivered

853 Civic Center Drive, Augusta, ME 04330



**BELGRADE BOAT STORAGE**

FREE LAKESIDE BOAT PICKUP & DELIVERY

**DARE TO COMPARE**  
Best Prices on Inside, Outside Boat Storage.  
Shrinkwrapping & Winterization

Craig Pooler  
Cell 207-314-3287 • Office 207-495-3421  
Email: [cpooler1@myfairpoint.net](mailto:cpooler1@myfairpoint.net)  
[www.BelgradeBoatStorage.com](http://www.BelgradeBoatStorage.com)

WATCHES • DIAMONDS  
EXPERT WATCH REPAIR • STONESETTING • GOLDSMITHING

**Larsen's Jewelry**

SERVING YOU SINCE 1962



57 MAIN STREET  
WATERVILLE, MAINE 04901

MARK A. LARSEN

207-872-6301  
1-800-697-1874





## — Calendar —

...Through Sunday 7/19 - Maine International Film Festival (MIFF), full daily schedules, [www.miff.org](http://www.miff.org), downtown Waterville.

...Thursday 7/16 and Friday 7/17 - "Fallen Angels," by Noel Coward, preview on Thursday, opening on Friday, 7:30 pm, 933-9999, Cumston Hall, The Theater at Monmouth.

...Wednesday 7/15 through Saturday 7/18 - "One Blue Tarp," 474-7176, Lakewood Theater, Route 201, Madison.

...Friday 7/17 through Sunday 7/19 - ASAM Summer Spectacular Horse Show, free and open to the public, covered arena, barns to visit, concessions, 272-0082, Skowhegan Fairgrounds, Route 201 North, Madison Avenue, Skowhegan.

...Friday 7/17 - Ashley Liberty and Daniel Strange, classical and original jazz and bluegrass, free and open to the public, 2 and 7 pm, 946-5311, Araxine Wilkins Sawyer Foundation, Greene.

...Friday 7/17 - July Poetry Reading at the

Harlow Gallery: Marcia Brown and Dennis Camire, \$3 donation, refreshments served, 7 pm, 622-3813, Harlow Gallery, 160 Water Street, Hallowell.

...Friday 7/17 - Atlantic Music Festival, Chamber Music, free, open to the public, 7 pm, 888-704-1311, Lorimer Chapel, Colby College, Waterville.

...Friday 7/17 - New England Music Camp Student Recital, open to the public and free of charge, everyone welcome, 7:30 pm, 465-3025, Alumni Hall, NEMC, Route 23, Sidney.

...Saturday 7/18 - Maine Audubon Society Loon Count day, to volunteer call a local lake association or Maine Audubon at 781-6180 or email [sgallo@maineaudubon.org](mailto:sgallo@maineaudubon.org), statewide.

...Saturday 7/18 - Flea Market, 8 am-2 pm, 293-3150, Lockwoods, 78 Pond Road, Vienna.

...Saturday 7/18 - Mushroom Foray with Michaeline Mulvey of the Maine Mycological Society, identification, explanation of the role of mushrooms in the forest ecosystem, ethical harvesting, free event, no need to pre-register, just show up, be prepared for bushwhacking, useful to bring knife, paper bags, hand lens, notebook, field guide, 9 am, 592-2238, Somerset County

Extension office, 7 County Drive, off the Back Road, Skowhegan.

...Saturday 7/18 - Old Hallowell Day, 3rd Saturday in July since 1968, activities Friday-Sunday, art, food, music, large parade and celebration of all things Hallowellian, oldhallowellday.org, Water Street, Kennebec Riverfront, and downtown Hallowell.

...Saturday 7/18 - Book Sale, to benefit Dr. Shaw Memorial Library, 9 am-2 pm, 293-2502, Community Center, downtown Mount Vernon.

...Saturday 7/18 - "Kilroy Was Here," a musical salute to the G.I. Joes and Jills of the 1940s, Young Performers Camp teen production, 10 am, 474-7176, Lakewood Theater, Route 201, Madison.

...Saturday 7/18 - East Pond Association Annual Meeting, open to all, [www.EastPond.org](http://www.EastPond.org), 10 am, Birchcrest, off Bricket Point Road, East Pond Road, Oakland.

...Saturday 7/18 - A Taste of the Past, come and enjoy the 'nibbling' and spinning, several historic treats available for sampling, spinning demonstration by Sallie Wilder and Julie Drever, 10 am-1 pm, 634-5032,

Norridgewock Historical Society Museum, Route 2, Norridgewock.

...Saturday 7/18 - A Taste of the Past, A Popular Cookie Treat: Molasses cookies, taste cookies and see kitchen equipment from the past, 10 M-4:30 pm, 238-4250, L.C. Bates Museum, Route 201, Hinckley.

...Saturday 7/18 - Old Time Toys, fun for all ages, use graces, hoops and sticks and more on the museum lawn, 10 am, 238-4250, L.C. Bates Museum, Route 201, Hinckley.

...Saturday 7/18 - Wildlife Encounters, join wildlife experts and wildlife - Serval Cat, Crested Porcupine, Arctic Fox, Indigo Snake, Alligator Snapping Turtle, Giant Bullfrog or Egyptian Fruit Bat - and learn how they are connected to Maine's resident wildlife, 11 am-2 pm, 657-4977, Maine Wildlife Park, Route 26, Gray.

...Saturday 7/18 - "Fool of the World and the Flying Ship," Family Show, 1 pm. 933-9999, Cumston Hall, The Theater at Monmouth.

...Saturday 7/18 - A Taste of the Past, sweets from traditional family recipes, for a donation a copy of the original recipe will be available, 2-4 pm, 453-9768, Taconnett Falls Genealogy Library, Winslow.

**SNOW POND**  
CENTER FOR THE ARTS

**36TH ANNUAL  
NEMC POPS CONCERT**

**July 18th  
7:30 p.m.  
Messalonskee  
Performing  
Arts Center**

**2015  
SUMMER  
CONCERT  
SERIES**

**AIR FORCE STRINGS**

With BBQ Picnic  
**July 31**  
5:00 Gates open  
& BBQ  
6:00 Free Concert  
Bowl in the Pines

*BBQ Picnic Reservations Recommended*

**Complete schedules of performances at  
SnowPond.org**

8 Goldenrod Lane, Sidney, Maine 04330 844-476-6976

**Expanded in 2014 to Better Serve Our Customers**

**Belgrade Lakes  
Marine & Storage, Inc.**

**Winter Storage for Summer Vehicles**

Secure newer storage facilities accommodate boats on trailers, autos, and the largest RVs in 3 buildings totaling over 21,000 sq. ft. Electrical charging outlets are available. Reasonable rates for real protection from extreme winter storms and sun damage.

**207-495-2378 • [www.belgradelakesmarine.com](http://www.belgradelakesmarine.com)**

366 Augusta Road, Route 27, Belgrade, ME

# MAINE~LY ELDER CARE

**"Caring for the ones who cared for us"**

*In - Home Nursing • Personal Care Services • Homemakers  
• Emergency Response Systems • Transportation Services*

**STATE REGISTERED PERSONAL CARE  
AND HOMEMAKER AGENCY**

**465-3249** 28 Center St., Oakland, Me 04963

[www.Maine-lyElderCare.com](http://www.Maine-lyElderCare.com) [denise@Maine-lyElderCare.com](mailto:denise@Maine-lyElderCare.com)

## DAY'S REAL ESTATE

**"The Waterfront Specialists" 207-495-3111**

262 Augusta Road (Route 27) • Belgrade Lakes, Maine 04918 •

Web: [www.daysrealestate.com](http://www.daysrealestate.com) • e-mail: [daysrealestate@roadrunner.com](mailto:daysrealestate@roadrunner.com)

**McGRATH POND** ~ Totally renovated yr-rnd 3 BR home with 115' +/- of waterfront. Exquisite gathering room, open concept, stone fireplace, granite countertops, screened porch, deck, dock. **\$369,900**

**BELGRADE** ~ Build your dream home in this wonderful subdivision with a view of Great Pond. Private 1.3 acre +/- wooded lot. Easy commute to Waterville, Augusta, Farmington and Skowhegan. **\$32,000**

**GREAT POND ACCESS** ~ Affordable 3 BR cottage in lakeside community with grassy common area and 100' of shared lakefront. Cottage is well maintained, furnished and ready to move into. **\$145,000**





...**Saturday 7/18** – Monthly Bean Supper, 3 kinds of beans, chop suey, hot dogs, bread, homemade pies, all you can eat, \$7 adults, under 5 free, family of 4 or more \$20, 4:30-6 pm, Mt. Philip Grange, Routes 27 and 225, Rome.

...**Saturday 7/18** - Dinner on the Farm, local food and fun, family-friendly meal, live music, dancing, kids' activities, 5 pm, advance tickets required, 649-3331, Winterberry Farm, Route 27, Belgrade.

...**Saturday 7/18** – 36th Annual New England Music Camp Pops Concert, presented by Snow Pond Center for the Arts, \$20 general admission, 7:30 pm, 465-3025, Messalonskee Performing Arts Center, 131 Messalonskee High Drive, off Oak Street, Oakland.

...**Saturday 7/18** - Atlantic Music Festival, Chamber Music, 7 pm, open to the public free, 888-704-1311, Lorimer Chapel, Colby College, Waterville.

...**Saturday 7/18** - The Maranacook String Band, Appalachian-sounding vocal harmonies, 7-9 pm, \$10 adults, \$5 students, children 5 and under free, Phillips Area Community Center, 1 Depot Street, Phillips.

...**Saturday 7/18** - Foxwell Brothers and Friends Concert, benefit for Meals on

Wheels, 7 pm, concert free, donations accepted, refreshments served, 660-1066, All Saints Episcopal Church, 169 Malbons Mills Road, Skowhegan.

...**Saturday 7/18** - "The Winter's Tale," by William Shakespeare, 7:30 pm, 033-9999, Cumston Hall, Theater at Monmouth.

...**Sunday 7/19** - Atlantic Music Festival, Chamber Music, 2 pm, 859-4353. In the lobby, Colby College Museum of Art, Waterville.

...**Sunday 7/19** - Dave Gutter, Concerts at Norcross Point, 2-4 pm, 620-6231, Norcross Point, Lake Maranacook, downtown Winthrop.

...**Sunday 7/19** - New England Music Camp Student Concert at Bowl in the Pines, 3 pm, free to the public, everyone welcome, in case of rain concert still scheduled, 465-3025, Route 23, Sidney.

...**Sunday 7/19** – Coburn Park Concert Series, "Borderline Express," 5 pm, 474-0527, Philbrick Gazebo, Coburn Park, Water Street, Skowhegan.

...**Sunday 7/19** - Atlantic Music Festival, Salon at The Bar, Manchester Blue Light Pub, Cotter Union, informal gathering, features a variety of chamber and solo favorites, 7 pm, 888-704-1311, 859-4353, Colby College,

Waterville.

...**Monday 7/20** - Atlantic Music Festival, free and open to the public, 7 pm, 859-4353, Lorimer Chapel, Colby College, Waterville.

...**Tuesday 7/21** - Chewonki Bugmobile, 2-3 pm, sponsored by the Belgrade Lakes Association, 512-5150, at the Maine Lakes Resource Center, Main Street, Belgrade Lakes.

...**Tuesday 7/21** - Youth Conservation Corps Party, sponsored by the Belgrade Regional Conservation Alliance, RSVP 495-6039, brca@belgradelakes.org, Maine Lakes Resource Center, Main Street, Belgrade Lakes.

...**Tuesday 7/21** – Atlantic Music Festival, free and open to the public, 7 pm, 888-704-1311, Lorimer Chapel, Colby College, Waterville.

...**Tuesday 7/21** - Concert on the River, 7-8:30 pm, North Water Street, Hallowell.

...**Wednesday 7/22** - Interlopers Art Exhibition Opening, artist Toni Jo Copps, features sculptures of fantastical creatures, activity book - great for groups and families, through October 8, 238-4250, L.C. Bates Museum, Route 201, Hinckley.

...**Wednesday 7/22** – Workshop on the Art of

Fresco with artist Barbara Sullivan, teens or adults, 1-4 pm, free, pre-register at 238-4250, L.C. Bates Museum, Route 201, Hinckley.

...**Wednesday 7/22** – Public supper, entrée, beverage, homemade dessert, \$8 adults, \$4 children under 10, 5 pm, Fairview Grange, Route 8, Smithfield.

...**Wednesday 7/22** – "Lexi James," country, Waterfront Wednesday Concert Series, free event, 6 pm to sunset, 626-2352, Waterfront Park, Augusta.

...**Wednesday 7/22** - Atlantic Music Festival, Chamber Music Series III, organized in conjunction with Colby's Alumni College, 7 pm, 888-704-1311, Lorimer Chapel, Colby College, Waterville.

...**Wednesday 7/22** - New England Music Camp Student Recital, open to the public, free of charge, everyone welcome, 7:30 pm, 465-3025, Alumni Hall, NEMC, Pond Road, Route 23, Sidney.

...**Thursday 7/23** - Free Child Identification program, provides fingerprints, DNA and detailed descriptions of child, free and open to the public, 11 am-4 pm, 495-3508, Belgrade Public Library, 124 Depot Road, Belgrade.

...**Thursday 7/23** - Open Mic, Joey Charles

Continued on page 11...



When your provider is not available, you have two choices:



MaineGeneral Express Care for non-life-threatening symptoms

Including

- Minor injuries, illnesses, aches or pains
- Colds, flu, fever, seasonal allergies
- Cuts, rashes & other skin problems
- Sprains & strains
- Infections

Costs

- Similar to provider practice costs

Hours

- Open 7 days a week
- Monday - Friday: 8 a.m. - 7:30 p.m.
- Saturday, Sunday and Holidays: 8 a.m. - 5 p.m.
- Closed Thanksgiving and Christmas

Convenience

- Walk-in care: no appointment needed
- We update your medical records
- If you do not have a primary care provider, we will treat you and help you find a provider

Or

Emergency Department for severe or life-threatening symptoms

Including

- A hard time breathing
- Sudden or severe pain
- Chest pain
- Sudden weakness or trouble speaking
- Bleeding that won't stop
- Severe headache
- Thoughts of harming yourself or others

Costs

- Higher costs than MaineGeneral Express Care
- Co-payments can vary widely

Hours

- Open 24/7

Convenience

- Wait time varies. Patients with the most severe symptoms are treated first.

Make the smart choice for you.







## BELGRADE REGIONAL HEALTH CENTER

*New Patients  
of All Ages  
Welcome*

4 Clement Way, Belgrade  
207-495-3323 | BelgradeCHC.org



### ACME LAND SURVEYING, LLC

Professional Land Surveyors – Professional Foresters  
Property Surveys, Subdivisions, Topographic Surveys, MLLs,  
Elevation Certificates/LOMs, ALTA/ACS Surveys,  
Deed Research, Wetland Delineation, Forest Management

108 Fairbanks Rd., Suite 5  
Farmington, ME 04938

Website: [www.acmelandsurveying.com](http://www.acmelandsurveying.com)

Tel. (207) 778-4081  
Toll Free (800) 778-4081

Email: [info@acmelandsurveying.com](mailto:info@acmelandsurveying.com)



**Installed, Sanded and Finished  
Old wood floors made to look new**

**(207) 313-6600**

*Contact Summertime with ads  
and event information.*

**207-495-3777**

**[ebelnews@earthlink.net](mailto:ebelnews@earthlink.net)**

**[www.sumbelnews.com](http://www.sumbelnews.com)**

David J. Auclair  
[www.auclaircycle.com](http://www.auclaircycle.com)

### AUCLAIR CYCLE & SKI

64-66 BANGOR ST. AUGUSTA, ME 04330  
623-4351 / 800-734-7171 • Fast Professional Service  
Bicycles • Skateboards • Roof Racks • Rentals

### Barbara's Antiques & Collectibles Group Shoppe

Multi Dealer Shop Unique Variety of Antiques and Collectibles  
3 Miles North of Skowhegan on Route 201  
414 Lakewood Rd., Madison

Open Monday & Wednesday to Saturday 10-5  
474-2550



The Jewelry Enthusiast's Jeweler.

L. TARDIF JEWELER  
62 Main Street Waterville, Me.

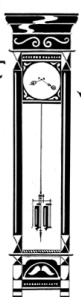

Tues - Sat

est. 1935

9 - 5

## — Upcoming —

### JULY

• The Bossov Ballet Theatre brings the beloved fairytale of Sleeping Beauty to the Waterville Opera House stage on Friday, July 24 at 7 pm and Saturday, July 25 at 2 pm. 873-7000

• The Farmington Summer Fest in downtown Farmington on Saturday, July 25, 9 am-9:30 pm, will include sales, competitions, live entertainment and a street dance.

• Celebrating Oakfest, Oakland United Baptist Church, 45-47 Church Street, will be holding a home cooked Pancake Breakfast on Saturday, July 25, 7-9 am in the Fellowship Area. \$5 donation for ages 5 and older. 465-7828

• The Belgrade Lakes Association will meet on Sunday, July 26, 6-8 pm at the Old Lakeshore Hotel in downtown Belgrade Lakes. 512-5150

• Ameranouche will perform at Cabaret Night on Sunday, July 26, 6:30-9 pm at Riverside Farm in Oakland. Tickets \$15, reserved seating. 465-4439

• An Air Force Strings concert will be presented at New England Music Camp Bowl in the Pines on Friday, July 31 at 5 pm, along with a BBQ Picnic. The concert is free; reservations are recommended for the BBQ picnic. 465-3739

### AUGUST

• Paddle Trek sponsored by the 30 Mile River Watershed Association from Mount Vernon to Wayne is scheduled for Saturday, August 1. 860-4043

• The Annual Belgrade Lakes Loon Calling contest and the Belgrade Fire Department Bean Hole Bean Supper will be on Saturday, August 1 in Belgrade Lakes. The supper is 5-7 pm at the Center for All Seasons; the Loon Calling sign-up is 6:30 pm, the contest at 7 pm at the bridge in Belgrade Lakes. The 2nd Belgrade Lakeside Artisan Show will be at the Center for All Seasons on August 2. 495-3312

• The theme of the 33rd Annual Wilton Blueberry Festival on August 7 and 8 is "Maine, All About Reading & Writing." The event will include sales and competitions, food - especially blueberries, a pedestrians-only Main Street, a parade and fireworks.

*Please visit our website  
[www.sumbelnews.com](http://www.sumbelnews.com)*



### BOOKS, PUZZLES, TOYS, GAMES

A store for children of all ages,  
the young and the young at heart.

Open Monday 12 to 5 • Tues. - Sat. 9 to 5  
52 Main St. Waterville 872-4543

• On Saturday, August 8, at 7 pm Simons & Goodwin return for their ninth appearance as headliners at the Union Coffeehouse in Belgrade Lakes, followed by open mic.

• The Harold Alfond Memorial Pro Am Golf Tournament sponsored by the Belgrade Regional Conservation Alliance will be held at the Belgrade Lakes Golf Club on Sunday, August 9. 495-6039

• Matt Venuti in Concert (designed for adults) is coming to the Mount Vernon Community Center on Sunday, August 9 at 7 pm. Tickets \$20 at the door only. 465-3524

• Tricky Britches will perform on Thursday, August 13 at 6 pm at the Gardiner Waterfront Park.

• The second Ice Cream Social and RB Hall Band Concert of the summer hosted by the Oakland Area Historical Society will be on Tuesday, August 18 at 6:30 pm. 639-4942

• "Picasso at the Lapin Agile" will be performed at Gaslight Theater in Hallowell August 21-23 and 28-30. 626-3698

• August 26 through 29 the 45th Blistered Fingers Family Bluegrass Music Festival will be presented at Litchfield Fairgrounds. 873-6539

### SEPTEMBER

• The 8th Annual 5K Race for the Lakes will be held on Saturday, September 5 in Belgrade Lakes. 495-6039

• Father and son duo, Ralph and Averill Lovely, return to the Sawyer Memorial in Greene for a free performance of bluegrass, country and hill-billy swing on Friday, September 11 at 2 and 7 pm. 946-5311

• On September 16 the 3rd Annual Power of 3 golf tournament to benefit Make-A-Wish will be held at Natanis Golf Course; 9 am shotgun start. 557-0224 or 557-0216

• The 22nd Annual Rise 'N Shine 5K road race will be held on Friday, September 25 at 6:29 am (sunrise) beginning and ending at the Kennebec Valley YMCA in Augusta. 622-9622



## DAVID STEVENS

Excavation & Septic Systems

LOAM GRAVEL SAND

**465-3815**  
Cell: 314-0314

P.O. Box 146 • Belgrade, Maine 04917  
DEP Certified Erosion and Sedimentation Control Practices





## Kennebec Corridor

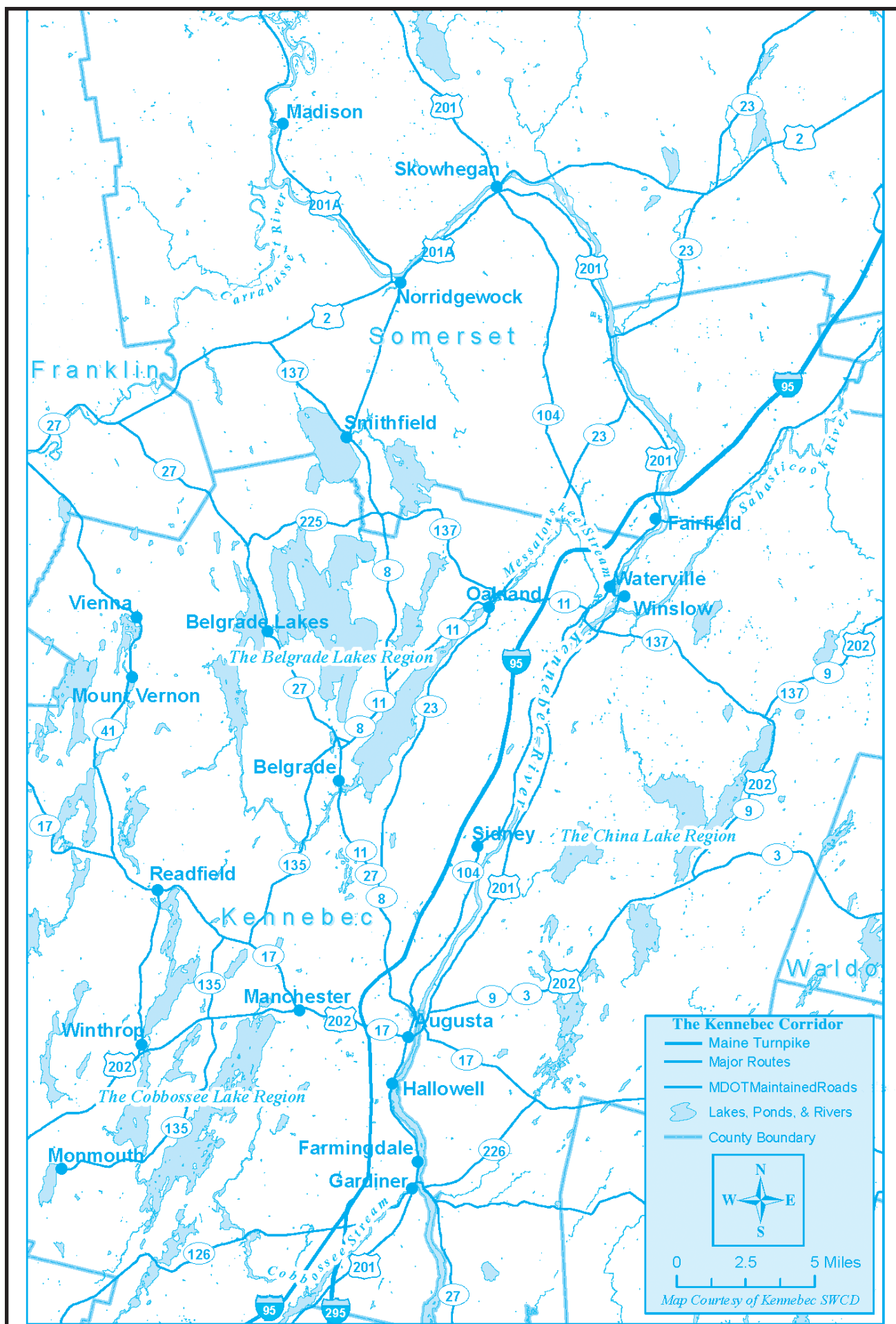

...Calendar continued from page 9  
(le professeur music), 6-9 pm, 495-2205, in back of Day's Store, on Long Pond, Main Street, Belgrade Lakes.

...Thursday 7/23 through Sunday 7/26 – "Damn Yankees," sporty musical comedy, 474-7176, Lakewood Theater, Route 201, Madison.

...Wednesday 7/22 – "The Winter's Tale," by William Shakespeare, 7:30 pm, 933-9999, Cumston Hall, The Theater at Monmouth.

...Thursday 7/23 through Sunday 7/26 – Pittston Fair, small family-oriented country fair, midway, animal and mechanical pulling events, Exhibition Hall, children's

games, strawberry festival, concert, admission, Route 194, Pittston.

...Thursday 7/23 - Electrical wizard, entertainment for the Summer Reading Program 2 pm, 465-7533, Oakland Public Library, Church Street, Oakland.

...Thursday 7/23 - Wayne's Got Ukles, come and join the Wayne Ukulele group, beginners and experienced and more voices, 6:30 pm, 524-3841, the Williams House, across from the Cary Memorial Library, 14 Old Winthrop Road, downtown Wayne.

...Thursday 7/23 through Saturday 7/25 - Vienna Historical Society

Annual Plays, "Nellie Belle's Hotel" by Beverly Wight Smith and "Something Hilarious" by Cheryl Herr-Reins, evenings 7 pm, Saturday matinee 2 pm, Union Hall, Route 41, Vienna.

...Thursday 7/23 – Atlantic Music Festival, 7 pm, free and open to the public, 888-704-1311, www.atlantic-musicfestival.org, Colby College, Waterville.

...Thursday 7/23 and Friday 7/24 – "A Midsummer Night's Dream," by William Shakespeare, 7:30 pm, pre-view Thursday, opening Friday, 933-9999, Cumston Hall, Main Street, The Theater At Monmouth.



Just here for  
the summer,  
or new to the area?  
Looking for a vet?  
Maybe we can help



**Lakeside**  
VETERINARY  
CLINIC

www.lakevets.com

Hours 7:30 to 5:00  
Monday thru Friday  
8:00 to 12:00 Saturday

Dr. Eleanor C. Sabeau  
Dr. Donelle C. Paine

88 Libby Hill Rd • Oakland, Maine 04963

(207) 465-PETS (7387) (207) 465-VETS (8387)

Call or visit us  
at the head of  
Snow Pond in  
Oakland (Rt. 23)!

**LakeHouse™**  
Renovations

Design • Build • Renovate



Traditional Style Camps,  
Cottages and Lakefront Homes  
207.242.3663

www.lakehousedesignbuild.com

COLBY  
MUSEUM  
OF ART



**BRAND-NEW & TERRIFIC**  
**ALEX KATZ IN THE 1950s**

July 11–October 18, 2015

Colby College Museum of Art, Waterville, Maine  
colby.edu/museum 207.859.5600

Advertising in  
Summertime in the Belgrades  
really works! Call 207-495-3777  
for rates and information.







## Lynch

LANDSCAPING INC  
FOR THOSE WHO DESIRE QUALITY

**Design - Install - Maintain**

**Lake Smart Certified for all your Waterfront Needs**

Plant Installation, Patios, Walks, Permeable Pavers Driveways, Plant Maintenance, Mowing, Fertilizing, Spring & Fall Clean Up

**Serving all of Central Maine**

**474-2420**

[www.lynchlandscaping.com](http://www.lynchlandscaping.com)





### Belgrade Vacation Rentals

**CAMP & COTTAGE RENTALS**

**Located next to Pete's Pig Barbecue!**

**Contact Us Today!**

**(207) 495-4011**

[www.BelgradeVacationRentals.com](http://www.BelgradeVacationRentals.com)

**Own A Property? We Will Rent it for You!**



### RAILROAD SQUARE CINEMA

**Showing the Best of World and American Cinema**

17 Railroad Square, Waterville, Maine, 04901

24-hour movie info:  
**207-873-6526**

[www.railroadsquarecinema.com](http://www.railroadsquarecinema.com)



**Home of the Maine International Film Festival**  
(July 10 - 19, 2014)  
[www.MIFF.org](http://www.MIFF.org)

*Don't miss the boat. Sign up and advertise in*  
**Summertime in the Belgrades**

**Call 495-3777**  
*or send information to*  
**PO Box 290,**  
**Belgrade Lakes, ME 04918.**





## ST. MICHAEL SCHOOL

56 Sewall Street • Augusta • (207) 623-3491 • [smsmaine.org](http://smsmaine.org)

**Currently Accepting Enrollments for Pre-K Through Grade 8**

St. Michael School is a robust Catholic school offering a quality, faith-filled education to grades Pre-K through grade 8. Our students' lives are molded and transformed through strong academics, excellent sports and activities programs, and a commitment to community service. We welcome both Catholic and non-Catholic students.

*Where Futures Begin!*

**WE OFFER:**

- Maine State Certified Faculty and Staff
- Music, Chorus, Art and Physical Education
- Title I Reading and Speech Services
- Full Day Kindergarten and Full Day Pre-K
- Excellent Lunch and Extended Day Programs
- Study of French for Grades PK - 8
- Intramural Sports and Healthy Activities
- Strong Athletics Program
- Science Fair and Environmental Projects
- Children's Stage Adventure
- Adventure Club for Grades 6 - 8
- Community Service Projects
- Civic Oration, Math Team, DAR Essay Contest, Spelling and Geography Bee

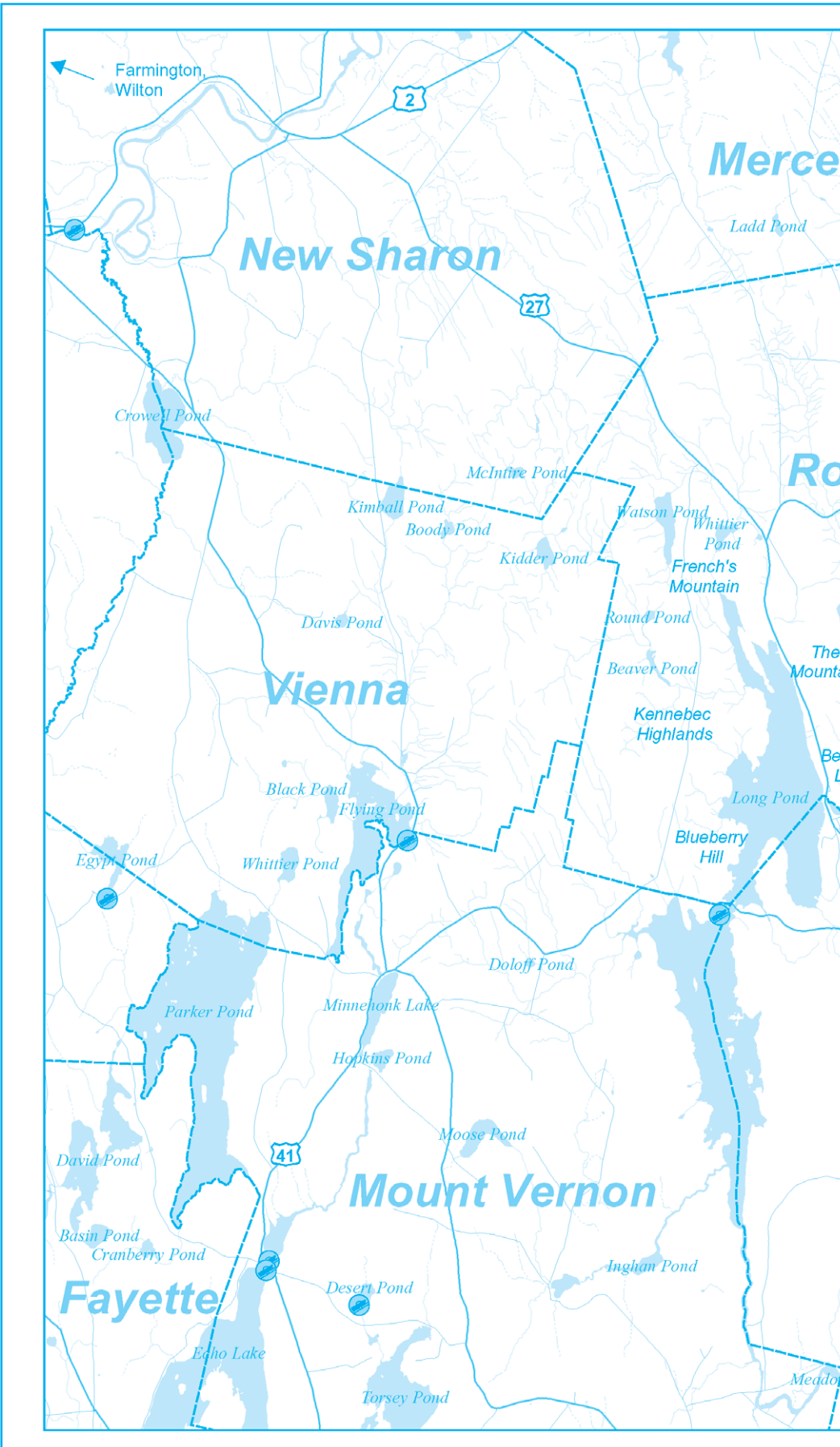

### EYE CARE OF MAINE

"Your Sight is Our Vision"

- Comprehensive Eye Exams
- Eyewear Center / Contact Lenses
- State of the Art Cataract Surgery
- Retinal Diseases and Glaucoma
- LASIK Refractive Surgery
- Laser Surgery
- Oculoplastic Diseases
- Botox, Juvederm and Latisse

**Ambulatory Surgery Center**

[www.Maine2020.com](http://www.Maine2020.com)



Steve R. Witkin, M.D.



Peter C. Kohler, M.D.



James R. Putnam, M.D.



Marc B. Daniels, M.D.



Helen Bell-Necevski, O.D.



Lorie Lepley Parks, O.D.



Michael C. Parks, O.D.



Ian M. Jones, O.D.

325A Kennedy Memorial Drive  
Waterville, Maine 04901

**873-2731**  
**(800) 660-3403**

## RIVERSIDE FARM

RESTAURANT & WINE MARKET

**Restaurant Hours:**

**Brunch**  
Sundays - 10am-2pm

**Lunch**  
Tuesdays - Saturdays - 11am-3pm

**Dinner**  
Thursdays -- Sunday - 5:30pm-8:30pm

**Wine Market Hours:**  
Tuesdays - Fridays - 10am-6pm  
Saturday - 10am-4pm

291 Fairfield Street  
Oakland, ME 04963

For reservations call 207-465-4439

[RiversideFarmMarket.com](http://RiversideFarmMarket.com)





## RIVERFRONT BARBEQUE & GRILLE

### WORLD CLASS BARBEQUE

SEAFOOD, PASTA, & VEGETARIAN ENTREES

207.622.8899

300 WATER STREET, AUGUSTA, MAINE

WWW.RIVERFRONTBBQ.COM

FULL SERVICE DINING \* CATERING \* BULK TAKE OUT



## The Gin Mill

Augusta, Maine

Augusta's finest upscale lounge featuring  
fine wine, martinis, and over 100 brands  
of beer from Germany to Japan

Thursday thru Saturday 3:00pm until Midnight,  
Above the Riverfront Barbeque & Grille  
at 300 Water Street  
207.620.9200

## Lakepoint REAL ESTATE

"Put The Team to Work For You"

207.495.3700

GAIL RIZZO 207-242-8119  
gail@gailrizzo.com



PAT DONAHUE 207-730-2331  
pdcamp@msn.com



**LONG POND, ROME:**  
17.30 acres, 387' +/- water-  
front. Pvt wooded, near to  
Kennebec Highlands hik-  
ing/biking trails, Belgrade  
Lakes Golf Club. #1208298  
\$395,000



**GREAT POND, ROME:**  
Unique Maine Compound,  
w/cottage, stable, dining  
bldg, sleeping bldg, to  
name a few, all on 20 acres  
w/800' frontage.  
#1146489 \$1,550,000



**LONG POND, BELGRADE:**  
1.990 ac building lot with  
206' waterfront. Great  
sunsets, walk to Belgrade  
Lakes Village, private area.  
#1158851 \$349,000



**LONG POND, BELGRADE:**  
Quaint cottage at water's  
edge. Kitchen, living room,  
2BR +loft/1 bath, 140'  
western exposure on a pri-  
vate lot. MLS #1221430  
\$349,000

NEW LISTING

221 Main Street, Belgrade Lakes, Maine 04918

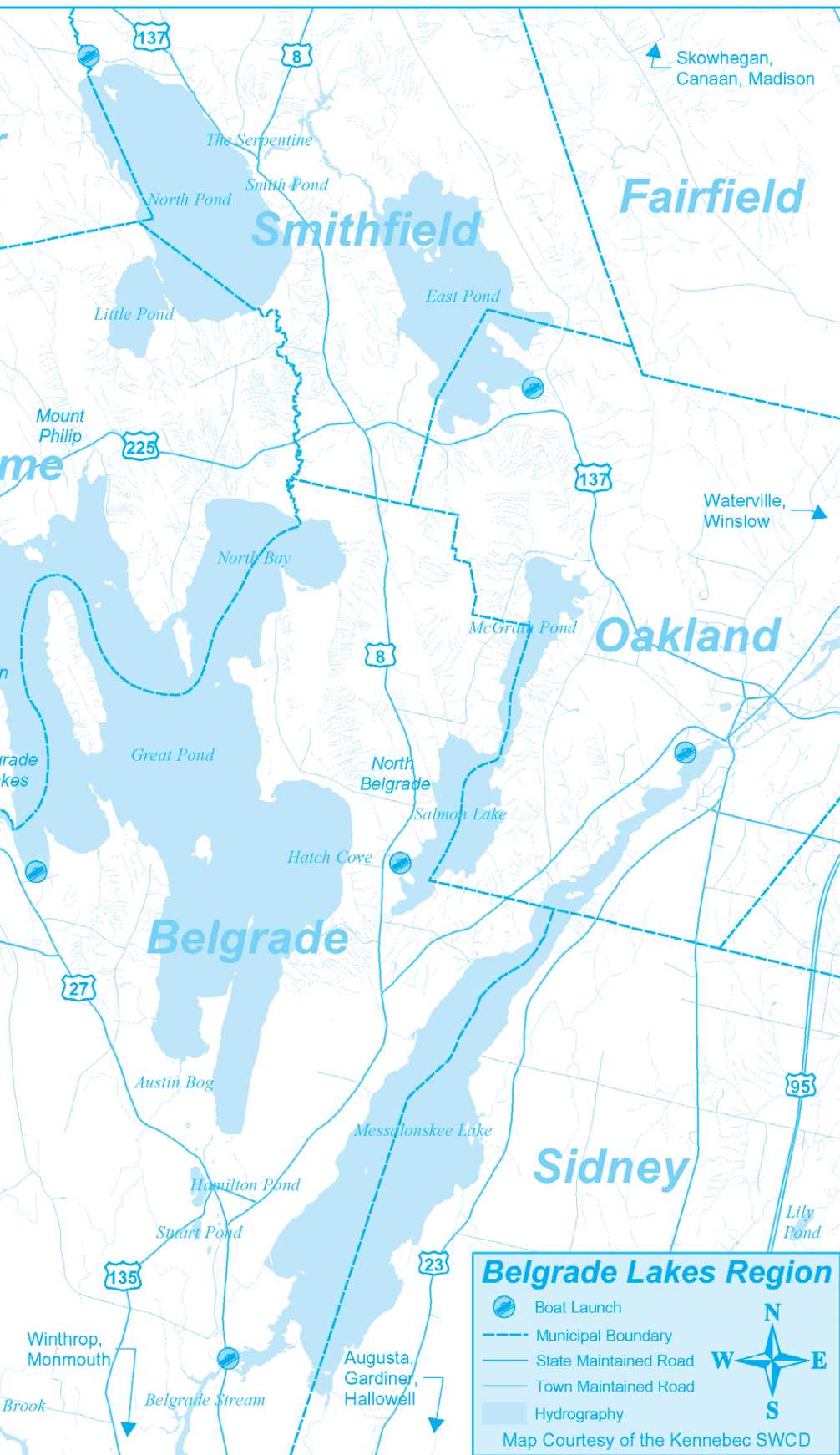

## MICHAEL BREAU

Creative  
solutions for  
all your Mac needs

### "If you want a pro, call Bro"

Robert Lockwood, Designer, Painter, Author, Musician  
designer of Newspapers Around the World



### Macintosh and iOS support, based in Western Maine, working onsite through- out Maine

If you have Macs, iOS devices, software or network problems,  
websites you'd like built, or any ideas you would like to  
implement using Macintosh computers, give me a call and  
we can discuss if I can help...

207-578-0226 • www.michaelbreault.net

## Family Fun Days BOAT RENTALS



GREAT  
POND  
MARINA  
INCORPORATED

SALES • SERVICE • STORAGE • RENTAL

Don't Be Left  
Standing On  
The Dock

Call for  
Reservations:  
495-2213

www.greatpondmarina.com  
Belgrade Lakes

Open Every Day 8-5



## Day's Store

182 Main Street PO Box 277 Belgrade Lakes, ME 04918 207-495-2205

FRESH MEATS • LOBSTERS • BAKERY •  
PIZZAS • SANDWICHES • ATM • AGENCY LIQUOR

LAKESIDE  
SCOOPS

Featuring



CONES SUNDAES

On Long Pond behind Day's Store

## Clark Marine

Manchester - Monmouth - Belgrade

We Service  
Honda, Mercury, Evinrude,  
and Yamaha Motors

Keeping You On The Water!

207-622-7011

57 Puddledock Rd.

Manchester, Me.



Check-Out Our  
New Boats



www.ClarkMarineMaine.com





## MIFF *Tumbledown* Opening Nearly Sold Out!



Friday night's opening performance of *Tumbledown* at the Waterville Opera House was virtually sold out. Pictured above are left, Sean Mewshaw, director, and right, Desi Van Til, screenwriter, of the new movie *Tumbledown*. Desi grew up in Farmington and used her memories and knowledge of the Franklin county area of Farmington and Weld to write the screenplay. A large part of the audience were friends and acquaintances of Desi, eager to see the movie she has been working on with her husband, Sean, for at least eight years. The movie was very well received and will return to the Railroad Square for the nationwide movie opening around Valentine's Day, 2016

## Cobbossee Watershed

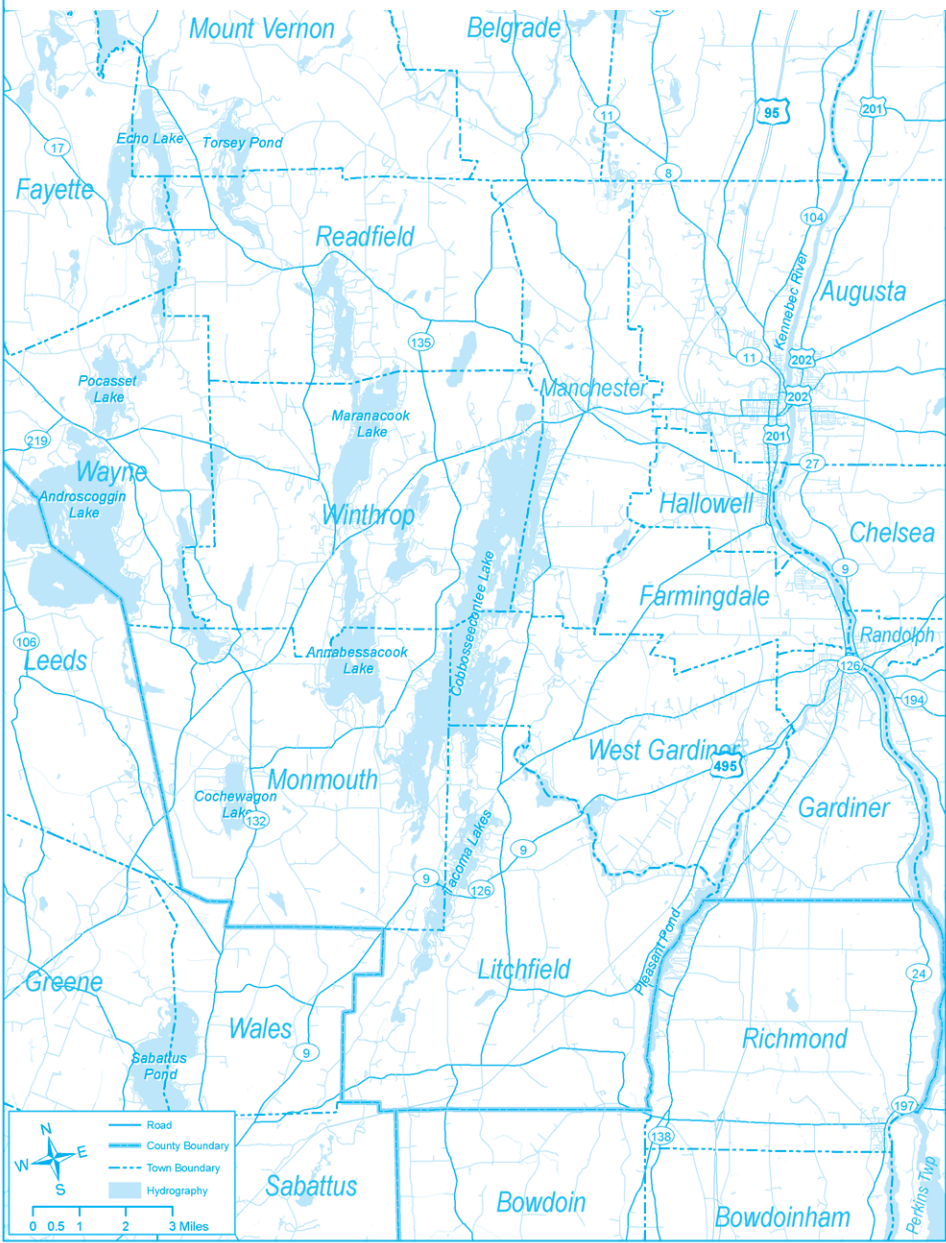

**Smile**  
YOU'RE AMONG FRIENDS AT KENNEBEC SAVINGS

You know us ... maybe not as Directors of Kennebec Savings Bank, but as your neighbors, local business people and members of your community organizations.

Kennebec Savings Bank has been serving and supporting you under the same name for over 145 years. We're a mutual organization; we belong to the community.

Our decisions are always about our customers' best interests.



Directors (L to R) Diane Hastings, Mark Johnston, Dick O'Connor, Mary Denison, Andrew Silsby, Doug Reinhardt, Bill Mitchell, Norm Elvin, Chuck Hays, Jr., & Bill Sprague, Jr.

### Kennebec Savings Bank



Augusta 622-5801 • Waterville 872-5563  
Winthrop 377-5801 • Farmingdale 588-5801  
[www.kennebecsavings.com](http://www.kennebecsavings.com)



**33rd Annual Wilton Blueberry Festival**  
August 7th & 8th 2015  
Maine, All About Reading & Writing

Please visit our website [www.sumbelnews.com](http://www.sumbelnews.com)

### Call Us For Boat Tops, Covers & Interiors

Keep You and Your Boat Clean & Dry

Protect the Interior  
Repairs & Alterations  
Welcome!

**Pontoon Boats Too!**

### WATERVILLE UPHOLSTERY & CANVAS

(Waterville Auto Top)

1 1/2 Miles West Exit 127, I-95, KMD, Oakland  
465 - 7847







## A Cinematic Swan Song: The Final Days of This Year's MIFF

By Gregor Smith



*The Third Man*

Seven days down, three more to go. It's hard to believe that the eighteenth annual Maine International Film Festival is almost over, but there's still plenty to see during the festival's closing weekend, especially for aficionados of Maine-made and vintage films.

On Friday at 6:30 at the Opera House, Kathryn Altman will introduce a screening of *MASH* (1970), the Korean War satire directed by Robert Altman (1925 – 2006) that spawned the long-running television series. The film stars Elliot Gould and Donald Sutherland and features this year's Mid-Life Achievement Award honoree Michael Murphy. The movie also has a local connection: it was adapted from a novel by H. Richard Hornberger (1924 – 1997), a thoracic surgeon who practiced at Mid-Maine Medical Center (now part of MaineGeneral Health) and who wrote under the pseudonym Richard Hooker. After the screening, Kathryn Altman will sign copies of *Altman*, an anthology of photographs of and essays about her late husband, along with archival documents from his files.

Also at 6:30 on Friday, but at Railroad Square, will be the U.S. premiere of the final Maine feature, *The Strange Eyes of Dr. Myes*. Mixing live action and animation, this psychedelic romp chronicles the attempts of the fictional female scientist to, in the words of the MIFF website, "create medical/scientific treatments and body augmentations that elevate an individual's consciousness by enhancing their senses to go beyond the normal human range of vision, hearing, smell and touch. . . . It is a classic gothic horror, mad scientist movie, but with elements of musical, animation and experimental cinema."

The film features original music, and the director and lead actress, among others, will treat the audience to a concert after the showing. Those who decide to go to *MASH* instead can see *Strange Eyes* Saturday night at 6:00, but without the post-screening performance.

On Saturday, the Maine theme continues with the Maine Student Film and Video Festival at 12:30 at the Opera House. Now in its 38th year, the festival accepts short films on any subject from Mainers 19 and younger. Submissions can be fiction or nonfiction, live-action or animated, but must not be longer than 10 minutes. At each year's MIFF, the top student films are screened; the winners are announced; and the prizes awarded. This year's prizes include a \$500 cash award, a one-year subscription to an online suite of video editing software, and full-festival passes to next year's MIFF.

Following the screening and award presentation, one can see a collection of six shorts by grown-up Mainers at Railroad Square. Ranging from 6 to 24 minutes — 90 minutes total — these films tell the stories of two burnt-out Olympians trying to find a new purpose for their lives, an artist who channels her grief at the death of her epileptic son to build stained glass pyramids in his memory, American POWs in World War II Germany who escape with inspiration from Greta Garbo, an elderly man whose dreams may portend tragedy, a fiddle duo that plays Franco-American contradance music, and the 1971 U.S. Alpine Championships at Sugarloaf Mountain, the only downhill skiing World Cup event ever to be held in Maine.

*Continued on page 16...*

**Snow Pond Cruises**  
& HISTORICAL TOURS

[www.snowpondcruises.com](http://www.snowpondcruises.com)

Onboard Weddings,  
or just a day on the lake.  
All cruises are private.

Captain Gary Bennett,  
Registered Maine Guide  
97 Rocky Shore Lane  
Oakland, ME 04963  
207-314-3520

**Quality Used Books**

8,000 Gently Used,  
Hand Picked, Eclectic  
and Popular Books

605 Wings Mill Road  
Mount Vernon - 620-2392

hosehead51@roadrunner.com

Open 12 - 5:30 every day  
except Mon. & Tues.

**Vienna - WATERFRONT Home**  
455' on Whittier Pond and 30'  
dock! Three bedroom, 2 1/2 bath  
home built in 2005 on 13+ A.  
Great room with vaulted ceiling.  
Large, heated porch with "wall  
of windows", and sunset views! All flooring wood or tile. Trex deck & front  
porch. 1 1/2 car garage. Swimming, fishing, kayaking, and loons.  
677' on town road. \$349,500. 207.293.2025 for appointment, or  
directions to Open Houses July 12 & Aug. 15, 12-4 pm.

Advertising in  
*Summertime in the Belgrades*  
really works! Call  
207-495-3777 for rates  
and information.

**WOODEN BOATS KEPT AFLOAT**  
Restoration of small wooden and wood canvas  
Boats and Canoes

**KIMBALL POND BOAT BARN**

VIENNA, ME  
207-578-0876  
kpboatbarn@yahoo.com • <http://boatbarn.wcha.org>

**THIRTY-SIX  
GREAT REASONS**  
MAINE'S ONLY 36-HOLE  
PUBLIC GOLF COURSE  
THE LARGEST GOLF FACILITY  
NORTH OF BOSTON

Championship Golf, Full Pro Shop,  
Driving Range, & Modern Clubhouse.  
Groups Welcome

Webber Pond Road,  
Vassalboro, ME • 207-622-3561

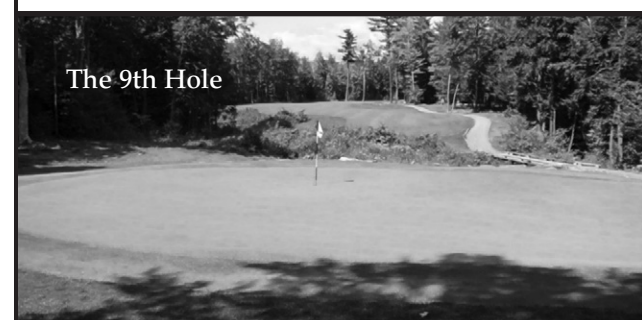





... Continued from page 15



*Mash*

Besides the Strange Eyes reprise, Saturday evening and Sunday afternoon offer a second chance to see one of the other Maine features

and two newly restored classic films shown earlier in the festival. They are The Hungry Years (Sat., 9:15), a documentary about a struggling,

young Portland rock musician; The Epic of Everest (Sun., 12:15), a video diary of a failed 1924 British attempt to conquer the world's highest peak; and Imitation of Life (Sun., 3:00), a 1959 melodrama about mothers and daughters and race relations. All three screenings are at Railroad Square Cinema.

The festival closes Sunday evening with a 7:00 screening at Opera House of a digitally restored 1949 noir classic, The Third Man, in which a pulp fiction writer (Joseph Cotten) arrives in post-War Vienna to take a job offered by an old school chum (Orson Welles) only to learn that his host has just been killed in a mysterious traffic accident. The novelist now turns sleuth to try to uncover what was behind this "accident."

Admission to any of the above-mentioned screenings is \$9, except for The Third Man, which costs \$3 more, and the Maine Student Film and Video Festival, which is free. To get full descriptions of any of these films or buy advance tickets, visit [www.miff.org](http://www.miff.org). As an alternative, one can pick up a copy of the festival's program booklet at either Railroad Square Cinema or the Waterville Opera House and may buy advance tickets at Railroad Square.



## Use your imagination! How will YOU use your Skowhegan Savings Home Equity Line of Credit?



Variable Rate Home Equity Line of Credit

**2.99% APR\***

FOR THE FIRST 24 MONTHS

After first 24 months, rate will be variable based on the Prime Rate, minimum

**3.99% APR\***

**New deck? Vacation? New boat?  
New kitchen? College tuition?**

Take advantage of the equity in your home to pay for life's upcoming events at a great rate! Home renovations, unexpected expenses, wedding, honeymoon, new boat, college tuition - the possibilities are endless.

Call 800.303.9511 to discuss your options today!



**Skowhegan Savings**  
Straight Talk. Fair Deals.  
800.303.9511 **FDIC**  
[SkowheganSavings.com](http://SkowheganSavings.com)

\*Offer good through July 15, 2015. APR rates based on a minimum draw of \$10,000 of new money and no closing costs for customers with an Integrity Plus checking account unless an appraisal is required. Appraisal required for loan amounts of \$250,000 or greater. Introductory rate of 2.99% APR for 24 months after the date of closing then convert to a variable rate based on the Wall Street Prime rate at that time. This rate will be subject to change but will not be lower than 3.99% APR or higher than 18% APR. Maximum loan-to-value is 89% on a 1-4 family, owner-occupied residence. Usual closing costs range from \$300-400. All loans subject to credit approval. Other restrictions may apply. **How's that for straight talk?**

## RAY SKOLFIELD

The Art of Raymond White Skolfield

June 11 - August 1, 2015

Opening Reception June 11, 5pm - 7pm

Emery Community Arts Center

University of Maine at Farmington

Open Monday-Saturday, Noon - 6pm







## — Take It Outside —

This week I finally got my sailboat into the water. As I towed it slowly up the lake from the Castle Island boat launch, I was scanning the shoreline and noticed a camp where I don't usually see one this time of year. I looked through my binoculars and spotted a family busily clearing vegetation and spreading mulch in the shoreland zone. I quickly attached my boat to a mooring and headed back down the lake to make sure the family understood the rules. They were very surprised that what they were doing was wrong. They had asked a few neighbors and even gone on line to find the rules without success. Someone told them to use erosion control mulch (a good idea) and someone told them they couldn't cut anything larger than 3 inches in diameter (not quite true) but no one told them that they couldn't cut anything less than three feet tall near the water except for a six foot wide meandering path. They were replacing woody shrubs with deep roots that hold the soil with flowers that have almost no root structure. They were filling in depressions that slow and infiltrate water flowing toward the lake. I offered to bring them an official copy of the rules and headed down the lake to the Belgrade Regional Conservation Alliance (BRCA) office in the Maine Lakes Resource Center (MLRC) to pick up a copy of the "DEP Issue Profile: Clearing vegetation in the shoreland zone" (4 pages) and a copy of the "Citizens Guide to Maine Shoreland Zoning-A Handbook for shoreland owners" (42 pages).

As I was motoring up the lake to deliver these documents, my fishfinder detected a large fish all by itself 27 feet down in 45 feet of water. I knew this was just below the thermocline where large trout, salmon, and pike like to hang out. I happened to have a flyrod with me with a sinking line, already rigged with a white zonker streamer fly. I cut the motor, cast my fly out and let it sink to the right depth. I then motored a slow circle around where I had spotted the fish, twitching the fly like a wounded minnow. I soon had a jolting strike and about ten minutes later landed Walter's younger brother, a 23-inch, 5-pound Brown trout. I spotted a friend of mine on the end of her dock and motored over so she could snap a picture of me with the fish. I then continued up the lake to deliver the vegetation rules. The vegetation clearing rules are complex and to ensure compliance shore-front property owners should check with their local code enforcement officer before starting any landscaping projects. Stop into the BRCA office at the MLRC to pick up copies of the relevant rules. They are also available on line at:

## Good Deed Gets Rewarded

by Pete Kallin



Five pound Brown trout caught while delivering vegetation rules



Ben with his pike



Two adult Sandhill cranes and a chick checking out a loon on a nest and vice versa.



Grandma Sue with Heather, Kate, and Garrison.

<http://www.maine.gov/dep/land/slz/citizen-guide.pdf>

That evening as I was headed out for some crepuscular fishing, I spotted 16-year old Ben Landry of Virginia and Tracy Cove on the end of his grandparents' dock getting ready to clean a nice Northern pike he had caught. I admired the fish and offered to show him how to filet it cleanly around the y-bones the way my uncle had taught me over 50 years ago. Ben said, "Thanks but I just watched a couple of u-tube videos on how to do it. I think I'm good." Just goes to show that kids are still learning outdoor skills but sometimes in slightly different ways than their elders.

One afternoon I decided to stretch my legs for a

bit and headed to French Mountain for a quick hike. As I was headed up the hill I met Sue Greenan coming down, celebrating her birthday (she didn't say which one) by taking a hike with her daughter, Heather Hartley, and grandkids, Kate and Garrison. Big smiles all around.

The BRCA "Geology of the Kennebec Highlands" hike with Mel Croft that was rained out last month has been rescheduled. It will take place on Thursday the 16th of July at 10 AM at The Mountain. Please call 495-6039 to register. Check the BRCA website and Facebook page for other guided trips ([www.belgradelakes.org](http://www.belgradelakes.org)) or get out and explore on your own. And take a kid or two along.



**Call Us For Boat Tops, Covers & Interiors**

Keep You and Your Boat Clean & Dry

Protect the Interior Repairs & Alterations Welcome!

Pontoon Boats Too!

**WATERVILLE UPHOLSTERY & CANVAS**  
(Waterville Auto Top)

1 1/2 Miles West Exit 127, I-95, KMD, Oakland  
465-7847

VISA MasterCard

**Bear Spring Camps**

- Waterfront cottages
- Home-style meals
- Bass, pike, and brown-trout fishing
- Boats, motors, docks
- Sandy beach
- 3.5 hours from Boston
- May-September

on Great Pond in the  
**Belgrade Lakes Region**  
[www.bearspringcamps.com](http://www.bearspringcamps.com)  
207-397-2341

**BELGRADE Boat Shop**  
RENTALS • SALES • SERVICE  
207.485.6953

**Let us take the hassle out of boating!**  
Daily, 3-Day, and  
Weekly Rentals Available

**Rentals • Sales • Service**  
[www.belgradeboatshop.com](http://www.belgradeboatshop.com)  
**485-6953**  
769 Oakland Rd.,  
Belgrade ME





## — Accommodations —

**Alden Camps**, lakeside cottages on East Pond, established 1911, American Plan meals, boat and motor rentals, dining and lobster bake open to public by reservation, 3 Alden Camps Cove, Oakland, 465-7703, [www.aldencamps.com](http://www.aldencamps.com)

**Bear Spring Camps**, waterfront cottages on Great Pond, home-style meals, sandy beach, boats, motors, docks, 60 Jamaica Point

Road, Rome, 397-2341, [www.bearspringcamps.com](http://www.bearspringcamps.com)

**Belgrade Vacation Rentals**, lakeside camp and cottage rentals throughout the area, long and short stays, many size accommodations and rates, 81 Main Street, downtown Belgrade Lakes, 495-4011, [www.belgradevacationrentals.com](http://www.belgradevacationrentals.com)

**Castle Island Camps**, cottages on the water, Long Pond, American Plan meals, boat and kayak rentals, Castle Island Road, Belgrade Lakes, 495-3312, [www.castleislandcamps.com](http://www.castleislandcamps.com)

**Whisperwood Cottages**, overlooking Salmon Lake, American Plan meals, fishing boat rentals, open to the public for dining by reservation only, 103 Taylor Woods Road, North Belgrade, 465-3983, [www.whisperwoodlodge.com](http://www.whisperwoodlodge.com)

**Wings Hill Inn**, historic Inn & Restaurant, casually elegant accommodations, centrally located in Belgrade Lakes Village, Route 27, Belgrade Lakes, 495-2400, 866-495-2400, [www.wingshillinn.com](http://www.wingshillinn.com)



## — Notebook —

### 2015 Big Tree Contest

• The Franklin County Big Tree Contest will run through September 30. Individuals who nominate a big tree will receive a "Forest Trees of Maine" booklet. Anyone who finds a tree that becomes a state winner will be awarded a certificate at the annual meeting of the Franklin County Soil and Water Conservation District. A nomination form can be picked up at 107 Park Street, Farmington or at [info@franklinswcd.org](mailto:info@franklinswcd.org). Information is needed on the person nominating the tree, the property owner and on the tree itself. 778-4279 or 592-2238

### Mid-Maine Global Forum

• Waterville's esteemed native son, George Mitchell, will be the guest speaker at the annual dinner of the Mid-Maine Global Forum on Thursday, August 6 at Colby College. Mitchell has had a long career of prestigious political assignments, was US Senator from Maine from 1980 to 1995, Senate Majority Leader from 1989 to

1995, instrumental in peace negotiations in Northern Ireland in the 90s and most recently was special envoy to the Middle East. Copies of his latest book, "The Negotiator: A Memoir," will be available for purchase and signing. [www.mid-maine-globalforum.org](http://www.mid-maine-globalforum.org), 859-4730

### Camp Kennebec Reunion

• It's potluck reunion time for everyone with a Camp Kennebec connection, the last Saturday in July, the 25th, 5-8 pm at the Belgrade Community Center for All Seasons. New owner of the former Camp Kennebec, Bob Siff, will be present. To cover expenses, \$5 per person or \$10 per family will be charged. RSVP to [mal.dawson@gmail.com](mailto:mal.dawson@gmail.com)

### Belgrade

• The Friends of the Belgrade Public Library will host their 6th annual Friends of the Belgrade Public Library 5K Road Race on Saturday, July 25 at 8 am at the Belgrade Public Library on Depot Street. This will be the 2nd year featuring The Summer Camp Challenge, with a special award for the winning camp. Race day registration at Belgrade Central School begins at 7 am; the race starts at 8 am. Race day fee is \$20; pre-race \$15 at [RunReg.com](http://RunReg.com). Awards will be presented to the overall male and female winners and to the top two finishers in each age category. 465-3524

...The Belgrade Historical Society is holding its first annual Belgrade Fair on Saturday, August 8, 10 am-4 pm, at the Old Town Meeting House on Cemetery Road to celebrate the Meeting House's 200th Anniversary. The Fair will include a lawn sale, plants, baked items, crafts and a food booth. The Old Town Meeting House will be open and historical items will be on display. Donations for the lawn sale may be dropped off at the Town House. 495-2973

..."Children and War" will be presented by Scott Erb at the Belgrade Public Library on Wednesday, August 19, 6-8 pm. In recent years the public has become aware of the increased use of children in war by examining the psychological impact on children of being in a war zone. The discussion will include the methods by which child soldiers are recruited, trained, used and manipulated, rehabbed and reintegrated. 495-3508

### Hinckley

• The Interlopers exhibit by Maine artist Toni Jo Coppa at the L.C. Bates Museum features the unique approach of works by Coppa mingled throughout the display of specimens at the natural history museum, as if they were part of the permanent collection. The exhibit, which will run through October 8, also is supported by an activity book created by Coppa, made specifically for the groups of children visiting with their schools. The museum is open Wednesday-Saturday, 10 am-4:30 pm and Sunday 1-4:30 pm. 238-4250

### Monmouth

• Ruddigore, or the Witch's Curse will be presented September 17-27 at the Theater at Monmouth. The Fall Musical, directed by Richard Sewell, will feature talented voices and musicians from Maine and professional actors from away. This production marks the first time Sewell has returned to Monmouth in more than 20 years. 933-9999

### Mount Vernon

• A multi-family Flea Market will be held on Saturday, July 18, 8 am-2 pm at Lockwood's on 78 Pond Road, 1 mile north of Mt. Vernon Village. The market will offer antiques, collectibles, household items and much more. Dealers are welcome - no early birds. Table rentals will benefit the Vienna Union Hall Association. To reserve a table please call 293-3150.

### Oakland

• The OakFest Triathlon 2015, Paddle Pedal Pound the Pavement, will be held on Sunday, July 26 at the Oakland Boat Landing on Belgrade. This tri is a fun, dynamic race that challenges any racer with a 2.5 mile paddle, 12 mile bike and a combo 3.1 mile road/trail run. It is perfect for racing newcomers as the swimming leg has been replaced with a paddle leg. It is a great way to get out and enjoy what Oakland has to offer. Start time is 7:30-8:30 am. Entry fee \$60. [www.oakfestmaine.com](http://www.oakfestmaine.com)

### Readfield

• Donations wanted for a large lawn sale on Saturday, August 8 to benefit the ongoing restoration of the Union Meeting House. Plenty of storage space available for advance donations. 685-4537

• Soccer Summer Camp coming up. Boys & Girls Soccer Camp, grades 4-8 is being offered July 27-August 31 and Little Kickers Soccer Camp, ages 5-8 is being offered August 10-13, both through RSU 38 Maranacook Adult Education. Contact [adulthood@maranacook.org](mailto:adulthood@maranacook.org) or 685-4923, x 1065

### Sidney

• The New England Music Camp will present "Into The Woods" on Thursday, Friday and Saturday, August 6, 8 and 9 at Alumni Hall at 7:30 pm. For information about special ticket reservations visit [www.nemusiccamp.com](http://www.nemusiccamp.com) or [www.snowpond.org](http://www.snowpond.org). 465-3025

### Skowhegan

• Skowhegan History House Museum & Research Center on Elm Street will host "Raising Grain and Baking Bread in the mid-1800s" on Thursday, July 30. A presenter from the 2015 Kneading Conference will speak. The 7 pm event is in conjunction with the conference. 474-6632

### Smithfield

• Call for poets!! Poets and readers/reciters of poetry interested in presenting their own or

*Continued on page 19...*

**ALDEN CAMPS**  
Est. 1911

- Lobster Bakes on Friday nights by Reservation
- Lakeside Cottages • Boats & Motors
- Full American Plan
- Dining on the Porch by reservation Saturday through Wednesday

E-mail: [info@aldencamps.com](mailto:info@aldencamps.com) • Website: [www.aldencamps.com](http://www.aldencamps.com)

**3 Alden Camps Cove**  
**Oakland, Me 04963**  
**(207-465-7703)**

**CASTLE ISLAND CAMPS**

Boats, Bait, Tackle, Gas, Kayaks

Boats, Daily or Weekly  
**495-3312**  
Rentals for Long Pond Only

**Brightside**  
WOODEN BOAT SERVICES

**Boat rentals,  
classic & contemporary.  
Sail or power,  
kayaks & canoes.  
Restoration & Brokerage**

**495-3680 office, 778-1706 cell,**  
[www.brightsidewoodenboat.com](http://www.brightsidewoodenboat.com)

21 Hulin Rd., Belgrade Lakes, Maine 04918





## Dining

### Augusta

• **Riverfront Barbeque & Grille and Gin Mill Lounge**, world class barbeque, seafood, pasta and vegetarian entrees, full service dining, catering, bulk take out, 300 Water Street, Augusta, 622-8899, [www.riverfrontbbq.com](http://www.riverfrontbbq.com)

### Belgrade

• **Pete's Pig**, 81 Main Street, sandwiches and platters for picnic-style eating on the premises or to go, , also offering a full range of catering, Main Street, Belgrade Lakes Village, 495-4095, [www.petespig.com](http://www.petespig.com)

• **Whisperwood Lodge and Cottages**, Salmon Lake/McGrath Pond, homestyle cooking, traditional fishing camp diningroom, open to the public by reservation only, 103 Taylor Woods Road, Belgrade, 465-3983, [www.whisperwoodlodge.com](http://www.whisperwoodlodge.com)

• **Wings Hill Inn and Restaurant**, gourmet fine dining in historic inn, daily culinary chef's specialties, Route 27/Main Street, Belgrade Lakes Village, 495-2400 or 800-495-2400, [www.wing-shillinn.com](http://www.wing-shillinn.com)

### Oakland

• **Alden Camps**, lunch or dinner by reservation Saturday-Wednesday space permitting, lobster bakes on Friday night by reservation, 3 Alden Camps Cove, Oakland, 465-7703, [www.aldencamps.com](http://www.aldencamps.com)

• **Riverside Farm Restaurant & Wine Market**, simple, wholesome food and drink since 1990, 291 Fairfield Street, Oakland, 465-4439, [www.riversidefarmmarket.com](http://www.riversidefarmmarket.com)

### Wines & Spirits Oakland

• **Tree Spirits**, tasting room for award winning wines and spirits made from local apples, pears and maple syrup, tours available, 152 Fairfield Street, Oakland, [www.treespiritsofmaine.com](http://www.treespiritsofmaine.com)

### Pizza & Picnic Fare North Augusta

• **Tree Spirits**, tasting room for award winning wines and spirits made from local apples, pears and maple syrup, tours available, 152 Fairfield Street, Oakland, [www.treespiritsofmaine.com](http://www.treespiritsofmaine.com)

### Belgrade Lakes

• **Day's Store**, pizza, sandwiches, desserts, beverages, to go, tables in store and lakeside, docks available from Great and Long Ponds, 180 Main Street, Belgrade Lakes, 495-2205, [www.go2days.com](http://www.go2days.com)

### Smithfield

• **Smithfield Village Store**, breakfast, lunch, and picnic foods drinks candies, 858 Village Road, Smithfield, 362-5022



## 2015 Open Farm Day: 26th Annual, 26th of July

Open Farm Day is an annual family adventure in which farms throughout the State of Maine open their gates to the public. The 26th annual Open Farm Day is set for Sunday, July 26 with more than 60 farms open. Open Farms near The Belgrades include:

#### Belgrade:

Winterberry Farm, organic diversified, 10 am-5 pm, 495-2593, 538 Augusta Road, Route 27.

#### Mount Vernon:

Dream on a Stream Ranch, alpacas/llamas, 10 am-3 pm. 293-1003, 443 Bartlett Road, off Route 135.

#### Sidney:

Misty Acres, alpacas, 10 am-3 pm, 547-2268, 3071 West River Road, Route 104.

#### Gardiner:

Andrews Farm, diversifies, 10 am-3 pm, 183 West Hill Road

Butting Heads Farm, goats, 10 am-3 pm, 462-

1637, 281 Costello Road.

#### Livermore:

Boothby's Orchard, apples, wine, maple syrup, 10 am-3 pm, 754-3500, 396 Boothby Road.

#### Monmouth:

Friends' Folly Farm, angora and dairy goats, 10 am-3 pm, 632-3115, 319 Norris Hill Road.

#### Leeds:

From the Country Farm, diversified, goats, 10 am-3 pm, 212-9911, 23 Austin Road.

#### Wilton:

Black Acres Farm, diversified, beef, chickens, pork, honey, 10 am-3 pm, 491-5443, 123 Black Road.

#### Vassalboro:

47 Daisies, fruits, vegetables, eggs, 10 am-3 pm, 213-6277, 552 Webber Pond Road.

Fieldstone Gardens, Inc., perennial nursery, 923-3836, 9 am-5 pm, 55 Quaker Lane.

For a complete list visit [getrealmaine.com](http://getrealmaine.com)

...Continued from page 18

selected poetry are invited to "Poetry in the Grange - Carrying the Torch," on Saturday, August 1, 4-5 pm at Fairview Grange. Each participant will have approximately 3 minutes. This event is part of Smithfield's 175th Anniversary Celebration, July 31-August 2. Please contact Kevin James at 612-9357.

### Waterville

• Be a part of the Taste of Waterville sponsored by the Mid-Maine Chamber of Commerce. Vendor booths, restaurant booths and sponsorships are still available for the 2015 Taste of Waterville on Wednesday, August 5. Bite booths are sold out. Also needed are volunteers for shifts throughout the day - which is fun!! 873-3315

• Join walkers around downtown every

Wednesday at noon to participate in Waterville Walks, a program of Inland Hospital. Take a short 15-20 walk to connect, get fit and take a break from the workday. [meetup.com](http://meetup.com)

### Wayne

• The Cary Memorial Library's traditional Silent Auction will begin with a festive Opening Reception on Thursday evening, July 30, 5-7 pm at the Williams House across from the Library and will run until Saturday, August 8, with bids closing at noon. Included will be many estate items as well as wonderful donations contributed by the library community. On display will be china, glassware, handcrafted items including jewelry and baskets, fine needlework, framed art and photography. Donations prior to Tuesday, July 28 are welcome and appreciated. 685-3612

**Whisperwood Lodge & Cottages**

Located on the South end of Salmon Lake in North Belgrade

**Fishing Boat Rentals on Salmon Lake & McGrath Pond**

All boats shown on our website

**Now open to the Public for Dining by reservation only. 465-3983**

Breakfast 8:am - 9:am, Dinner served at 5:pm

Daily menu listed on our website

Boat docking available for Lake Residents

[www.whisperwoodlodge.com](http://www.whisperwoodlodge.com)

**Brown House Appliance**

71 Francis St., Waterville, Maine 04901

**207-873-4777**

[brownhouseappliance.com](http://brownhouseappliance.com)

**Winterberry Farm**

your family's local Organic Farmstand

[www.winterberryfarmstand.com](http://www.winterberryfarmstand.com)

**PIES!!!**

**PIES!!!**

**PIES!!!**

We've been making PIES for the Belgrade area for **FOURTEEN YEARS**

**Farm grown ingredients**

Stop and visit our horse and oxen powered farm

Open daily 9-6

Rt. 27 Belgrade, ME • 207.649.3331

**DAMON'S Quick Stop**

**Deli & Gas**

DELI - PIZZA, SANDWICHES & MORE

M-F 5AM-9PM • SAT 6AM-9PM • SUN 7AM-9PM

**207-622-3334**

M-SAT 8AM-6PM • SUN 10AM-4PM

Advertising in Summertime in the Belgrades

**REALLY WORKS!**

Call 207-495-3777 for rates and information.

**Pete's Pig**

**CATERING & BARBEQUE**

Now Booking for 2015

- Corporate Functions
- Weddings & Rehearsals
- Special Events

Call (877) 860-1503 (207) 495-4095

[www.petespig.com](http://www.petespig.com)

**Maple Leaf Self Storage**

Belgrade Me - 3.3 mi off Rte 27 on Route 135

**495-2191**

Various size units  
Owners live on site

Boat / Auto Storage  
By foot or unit





## -Business Directory-

### ACCOMMODATIONS

See page 18

### ADVENTURE

**Belgrade Canoe & Kayak**, Route 27, Belgrade, 495-2005, [www.kayakandcanoe.com](http://www.kayakandcanoe.com)

### ANTIQUES

**Barbara's Antique & Collectibles Group Shoppe**, Rt 201, 414 Lakewood Rd, Madison, 474-2550, 474-8357

### APPLIANCES

**Brown House Appliances**, 71 Francis St, Waterville, 873-4777, [www.brownhouseproperties.com](http://www.brownhouseproperties.com)

### ART MUSEUMS

**Colby College Museum of Art**, 5600 Mayflower Hill, Waterville, 859-4000, [www.colby.edu/museum/](http://www.colby.edu/museum/)

### BANKING

**Kennebec Savings Bank**, 150 State Street, Augusta, 622-5801, [www.kennebecsavings.com](http://www.kennebecsavings.com)

**Maine State Credit Union**, 200 Capitol Street, Augusta, 623-1851, [www.maine-state-cu.org](http://www.maine-state-cu.org)

**Skowhegan Savings Bank**, 450 Civic Center Drive, Route 27, Augusta, 1-800-303-9511, 623-2300, [www.skowsavings.com](http://www.skowsavings.com)

### BEVERAGES

**Tree Spirits**, 152 Fairfield St, Oakland, 861-2723, [www.treespiritsofmaine.com](http://www.treespiritsofmaine.com)

### BICYCLES

**Auclair Cycle & Ski**, 64 Bangor St, Augusta, 623-4351, [www.auclaircycle.com](http://www.auclaircycle.com)

### BOAT COVERS

**Waterville Upholstery & Canvas**, 1042 Kennedy Memorial Dr, Oakland, 465-7847, [www.watervilleupholstery.com](http://www.watervilleupholstery.com)

### BOAT CRUISES

**Snow Pond Cruises**, Lake Messalonskee/Snow Pond, 97 Rocky Shore Lane, Oakland, 314-3520, [www.snowpondcruises.com](http://www.snowpondcruises.com)

### BOAT LIFTS

**Hammond Lumber Company**, Auburn, Bangor, Belgrade, Boothbay Harbor, Brunswick, Damariscotta, Fairfield, Farmington, Greenville, Pemaquid, Portland, Skowhegan, Wilton, 866-HAMMOND, [www.hammondlumber.com](http://www.hammondlumber.com)

### BOAT MOORINGS

**Great Pond Marina**, 25 Marina Drive, Route 27, Belgrade Lakes, 495-2213, [www.greatpondmarina.com](http://www.greatpondmarina.com)

### BOAT RENTALS

**Belgrade Canoe & Kayak**, Route 27, Belgrade, 495-2005, [www.kayakandcanoe.com](http://www.kayakandcanoe.com)

**Brightside Wooden Boat Services**, Great Pond, 21 Hulin Road, Belgrade Lakes, 495-3680, 778-1706, [www.brightsidewoodenboat.com](http://www.brightsidewoodenboat.com)

**Castle Island Camps**, Long Pond, 441 Castle Island Road, Belgrade Lakes, 495-3312, [www.castleislandcamps.com](http://www.castleislandcamps.com)

**Great Pond Marina**, 25 Marina Drive, Route 27, Belgrade Lakes, 495-2213, [www.greatpondmarina.com](http://www.greatpondmarina.com)

**Sunset Camps**, North Pond, 834 Village Road, Smithfield, 362-2611, [www.sunsecamps.com](http://www.sunsecamps.com)

**Whisperwood Cottages**, Salmon Lake/McGrath Pond, 103 Taylor Woods Road, Belgrade, 465-3983, [www.whisperwoodlodge.com](http://www.whisperwoodlodge.com)

### BOAT REPAIR AND RESTORATION

**Belgrade Boat Shop**, 769 Oakland Road, Belgrade, 465-9720, 485-6953

**Brightside Wooden Boat Services**, 21 Hulin Road, Belgrade Lakes, 495-3680, 778-1706, [www.brightsidewoodenboat.com](http://www.brightsidewoodenboat.com)

### BOAT SALES AND SERVICES

**Belgrade Canoe & Kayak**, Route 27, Belgrade, 495-2005, [www.kayakandcanoe.com](http://www.kayakandcanoe.com)

**Clark Marine**, 57 Puddledock Road, Manchester, 622-7011, [mail@clarkmarine.biz](mailto:mail@clarkmarine.biz), [funonthewaterstartshere.com](http://funonthewaterstartshere.com)

**Hamlin's Marine**, 290 West River Road, Waterville, 872-5660, [www.hamlinsmarine.com](http://www.hamlinsmarine.com)

**Mid-Maine Marine and RV**, 885 Kennedy Memorial Drive, Oakland, 465-2146, [www.midmainemarine.com](http://www.midmainemarine.com)

### BOAT STORAGE

**Belgrade Boat Storage**, 46 Oakland Road, Belgrade, 495-3421, 314-3287, [www.belgradeboatstorage.com](http://www.belgradeboatstorage.com)

**Belgrade Lakes Marine and Storage, Inc**, 366 Augusta Road, Belgrade, 495-2378, [www.belgradelakesmarine.com](http://www.belgradelakesmarine.com)

**Clark Marine**, 57 Puddledock Road, Manchester, 622-7011; and Route 202, Monmouth, [mail@clarkmarine.biz](mailto:mail@clarkmarine.biz), [funonthewaterstartshere.com](http://funonthewaterstartshere.com)

**Great Pond Marina**, 25 Marina Drive, Route 27, Belgrade Lakes, 495-2213, [www.greatpondmarina.com](http://www.greatpondmarina.com)

**Hamlin's Marine**, 290 West River Road, Waterville, 872-5660, [www.hamlinsmarine.com](http://www.hamlinsmarine.com)

**Maple Leaf Self Storage**, 688 Manchester Road, Route 135, Belgrade, 495-2191, 441-5529

**Mid-Maine Marine and RV**, 885 Kennedy Memorial Drive, Oakland, 465-2146, [www.midmainemarine.com](http://www.midmainemarine.com)

### BOOKS

**Children's Book Cellar**, 52 Main Street, Waterville, 872-4543, [childrensbookcellar.com](http://childrensbookcellar.com)

**The People's Book Shop**, 605 Wings Mill Road, Mount Vernon/Belgrade line, 620-2392

### BUILDERS

**Craig's Carpentry/North Bay Estates**, Route 8, North Belgrade, Craig Alexander, 649-3749

**G&L Contracting**, 116 Lakeshore Drive, Belgrade Lakes, 215-7951, 495-2325, 233-7408, [gandlcontractingmaine.com](http://gandlcontractingmaine.com)

**LakeHouse Renovations**, 242-3663, [www.lakehousedesignbuild.com](http://www.lakehousedesignbuild.com)

### BUILDING MATERIALS

**Gagne and Son**, 28 Old Route 27 Road, Belgrade, 495-3313, [www.gagneandson.com](http://www.gagneandson.com)

**Hammond Lumber Company**, Auburn, Bangor, Belgrade, Boothbay Harbor, Brunswick, Damariscotta, Fairfield, Farmington, Greenville, Pemaquid, Portland, Skowhegan, Wilton, 866-HAMMOND, [www.hammondlumber.com](http://www.hammondlumber.com)

### CANOES AND KAYAKS

**Belgrade Canoe & Kayak**, sales and rentals, 1005 Augusta Road /Route 27, Belgrade, 495-2005, [www.kayakandcanoe.com](http://www.kayakandcanoe.com), [www.belgradecanoeandkayak.com](http://www.belgradecanoeandkayak.com)

### CANOE REPAIR AND RESTORATION

**Kimball Pond Boat Barn**, 21 Day Road, Vienna, 578-0876, [boatbarn.wcha.org](http://boatbarn.wcha.org)

### COMPUTER CONSULTANTS

**Macintosh Solutions**, **Michael Breault**, 24 Welch Road, Wilton, 645-5083, cell 578-0226, [m.o.breault@michaelbreault.net](mailto:m.o.breault@michaelbreault.net), [www.michaelbreault.net](http://www.michaelbreault.net)

### DINING

See Dining Directory on page 19

### DOCKS

**G&L Contracting**, 116 Lakeshore Drive, Belgrade Lakes, 495-2325, 215-7951, 233-7408, [gandlcontractingmaine.com](http://gandlcontractingmaine.com)

**Hammond Lumber Company**, Auburn, Bangor, Belgrade, Boothbay Harbor, Brunswick, Damariscotta, Fairfield, Farmington, Greenville, Pemaquid, Portland, Skowhegan, Wilton, 866-HAMMOND, [www.hammondlumber.com](http://www.hammondlumber.com)

### ELDER CARE

**Maine-ly Elder Care**, 28 Center Street, Oakland, 465-3249, [www.maine-lyeldercare.com](http://www.maine-lyeldercare.com)

### ENGINEERING

**Thayer Engineering**, septic design, storm water mitigation, permitting, 17 Hasson Street, Farmingdale, 582-7762, [www.thayereng.com](http://www.thayereng.com)

### EXCAVATING

**Belgrade Boat Storage**, 46 Oakland Road, Belgrade, 495-3421, 314-3287, [belgradeboatrentals.com](http://belgradeboatrentals.com)

**David Stevens**, P0 Box 146, Belgrade, 465-3815, cell 314-0314





EYE CARE

Eye Care of Maine, 325 E. Kennedy Memorial Drive, Waterville, 873-2731, [www.Maine2020.com](http://www.Maine2020.com)

FARMSTANDS

Winterberry Farm, 538 Augusta Road, Route 27, Belgrade, 495-2593, 649-3331, [www.winterberryfarmstand.com](http://www.winterberryfarmstand.com)

FINANCIAL PLANNING

Golden Pond Wealth Management, 129 Silver Street, Waterville, 873-2200, [www.goldenpondwealth.com](http://www.goldenpondwealth.com)

FIREWOOD

J & M Logging, Inc. 853 Civic Center Drive, Augusta, 622-6353

FLOORING

Hammond Lumber Company, Auburn, Bangor, Belgrade, Boothbay, Brunswick, Damariscotta, Fairfield, Farmington, Greenville, Pemaquid, Portland, Skowhegan, Wilton, 866-HAMMOND, [www.hammondlumber.com](http://www.hammondlumber.com)  
Maine Hardwood Floors, 313-6600

GIFTS

Day's Store, 180 Main Street, Route 27, Belgrade Lakes, 495-2205, [www.go2days.com](http://www.go2days.com)

GOLF

Natanis Golf Course, 735 Webber Pond Road, Vassalboro, 622-3561, [www.natanisgc.com](http://www.natanisgc.com)

GROCERIES

Damon's Quick Stop, 670 Civic Center Drive/Route 27, North Augusta, 622-3334  
Day's Store, 180 Main Street, Route 27, Belgrade Lakes, 495-2205, [www.go2days.com](http://www.go2days.com)

HEALTH CENTERS

Belgrade Regional Health Center, 4 Clement Way, Belgrade Lakes, 495-3323, [www.healthreachchc.org](http://www.healthreachchc.org), [belgradechc.org](http://belgradechc.org)  
Inland Hospital, 200 Kennedy Memorial Drive, Waterville, 861-3000, 1-800-491-8600, [www.inlandhospital.org](http://www.inlandhospital.org)  
MaineGeneral Medical Center, Alfond Center for Health, 35 Medical Center Parkway, Augusta; Thayer Center for Health, 149 North Street, Waterville, 1-855-4463, [www.mainegeneral.org](http://www.mainegeneral.org)

ICE CREAM

Day's Store, 180 Main Street/Route 27, Belgrade Lakes, 495-2205, [www.go2days.com](http://www.go2days.com)

JEWELRY

Larsen's Jewelers, 57 Main Street, Waterville, 872-6301,

800-697-1874, [www.larsensjewelers.com](http://www.larsensjewelers.com)  
L.Tardif Jeweler, 62 Main Street, Waterville, 872-7542, 800-834-3638

KITCHENS

Hammond Lumber Company, Auburn, Bangor, Belgrade, Boothbay, Brunswick, Damariscotta, Fairfield, Farmington, Greenville, Pemaquid, Portland, Skowhegan, Wilton, 866-HAMMOND, [www.hammondlumber.com](http://www.hammondlumber.com)

LAKE ASSOCIATIONS

Belgrade Lakes Association (BLA), Long Pond and Great Pond, PO Box 551, 137 Main Street, Belgrade Lakes, 512-5150, [www.belgradelakesassociation.com](http://www.belgradelakesassociation.com)

LANDSCAPING

G&L Contracting, Belgrade Lakes, 215-7951, 495-2325, 233-7408, [gandlcontractingmaine.com](http://gandlcontractingmaine.com)  
Lynch Landscaping, Skowhegan, 474-2420, [lynchlandscaping.com](http://lynchlandscaping.com)

MEATS

Day's Store, 180 Main Street, Belgrade Lakes, 495-2205, [www.go2days.com](http://www.go2days.com)

MOVIE THEATERS

Railroad Square Cinema, call for titles and times, 17 Railroad Square, Waterville, 873-6526, [www.railroad-squarecinema.com](http://www.railroad-squarecinema.com)

MUSEUMS

Colby College Museum of Art, Mayflower Hill, Waterville, 859-4000, [www.colby.edu/museum/](http://www.colby.edu/museum/)

MUSICAL PERFORMANCE

Snow Pond Center For The Arts, New England Music Camp, 8 Goldenrod Lane, Sidney, 465-3025, [www.snowpond.org](http://www.snowpond.org)

PHYSICAL THERAPY

Dockside Physical Therapy, 47 Main Street, Belgrade Lakes, 495-3195, 512-2544, Fax 512-2545

PIANO ENJOYMENT

Diane Gorman, 906 Manchester Road, Belgrade, 495-3222,

PLUMBING

Paul Hanna's Plumbing, Belgrade, 495-3805

REAL ESTATE DEVELOPMENTS

North Bay Estates, Belgrade, 649-3749, [crgsnbe@yahoo.com](mailto:crgsnbe@yahoo.com)

REAL ESTATE

Coldwell Banker Thomas Agency, 75 Main Street, Winthrop, 377-2121, [www.coldwellbankerthomas.com](http://www.coldwellbankerthomas.com)  
Day's Real Estate, 262 Augusta Road, Route 27,

Belgrade Lakes, 495-3111, 1-888-495-3111, [www.daysrealestate.com](http://www.daysrealestate.com)  
Lakepoint Real Estate, 221 Main Street, Belgrade Lakes, 495-3700, [www.belgradelakepoint.com](http://www.belgradelakepoint.com)  
Sprague & Curtis Real Estate, 75 Western Avenue, Augusta, 623-1123, [www.spragueandcurtis.com](http://www.spragueandcurtis.com)

LODGING RESERVATIONS

See page 18

RESTAURANTS

See Dining Directory on page 19

RETIREMENT COMMUNITIES

Granite Hill Estates, 60 Balsam Drive, Hallowell, 626-7786, 1-888-321-1119, [www.granitehillestates.com](http://www.granitehillestates.com)

SCHOOLS

St. Michael School, grades pre-K through 8th, 56 Sewell Street, Augusta, 623-3491, [www.smsmaine.org](http://www.smsmaine.org)

SEAFOOD

Day's Store, 180 Main Street, Belgrade Lakes, 495-2205, [www.go2days.com](http://www.go2days.com)

SECURITY SYSTEMS

Cayer Security Services, Inc, 208 College Avenue, Waterville, 453-9177, [www.cayersecurity.com](http://www.cayersecurity.com)

SELF STORAGE

Maple Leaf Self Storage, 688 Manchester Road., Route 135, Belgrade, 495-2191

STONEWORK

Gagne and Son, 28 Old Route 27, Belgrade, 495-3313, 1-800-339-3313, [www.gagneandson.com](http://www.gagneandson.com)

SURVEYING

Acme Land Surveying, 108 Fairbanks Road, Suite 5, Farmington, 778-4081, [www.acmelandsurveying.com](http://www.acmelandsurveying.com)

VETERINARY SERVICES

Lakeside Veterinary Clinic, 88 Libby Hill Road, Oakland, 465-7387, 465-8387, [www.lakevets.com](http://www.lakevets.com)

WINDOWS

Hammond Lumber Company. Auburn, Bangor, Belgrade, Boothbay, Brunswick, Damariscotta, Fairfield, Farmington, Greenville, Pemaquid, Portland, Skowhegan, Wilton, 1-866-HAMMOND, [www.hammondlumber.com](http://www.hammondlumber.com)



Advertising in  
Summertime in the Belgrades  
really works! Call 207-495-3777  
for rates and information.





## Expressions

### Cutting Edge Exhibit to be Featured During the Maine International Film Festival

A cutting edge exhibit that explores the intersection of art and film will once again accompany the Maine International Film Festival.

MIFFONEDGE Vol. 3 brings together six artists' work in one exhibit, which opened July 11 and is open daily from 2:00-9:00 p.m. through July 18 at Common Street Arts, in Waterville. Featuring exciting and innovative work spanning decades of moving image history, MIFFONEDGE pushes the boundaries of commonly accepted notions of cinema.

"We are really excited about the continuation of MIFFONEDGE, which we launched in 2013 and continues to grow in popularity each year," said Festival Director Shannon Haines. "MIFFONEDGE gives audience members the opportunity to explore experimental and multi-media works in a very accessible and welcoming environment."

The artists and works featured in the exhibit are: Nancy Andrews, The Institute of Higher Nervous Activities, Department of Bioinformation, presents Film Studies 1.0 and 1.2; David Colagiovanni, Dinner Music, Banaras and Found Reel: History of



Alex Katz, American (b. 1927), *Bather*, 1959, oil on linen, 48 x 72 in. (121.92 x 182.88 cm). Paul J. Schupf L.L.D. '06, Hamilton, N.Y. Lifetime Trust, Gregory O. Koerner Trustee. Art © Alex Katz/Licensed by VAGA, New York, N.Y.

operating the recording apparatus in Southeast Ohio; Judith Larsen, XIBIPIO; Chris Pearce, The Archive of the Movements of Inanimate Objects; Heddi Vaughan Siebel, Far, and Further; and Stan VenDerBeek, Science Friction and Achooo Mr. Kerrooshchev.

An opening party for MIFFONEDGE Vol. 3 on Saturday, July 11th featured a live performance by Audrey Harrer of her cinematic art songs for voice, harp, and electronics.



## Brand-New & Terrific: Alex Katz in the 1950s

First Museum Survey of Early Work by Alex Katz Includes  
Many Rarely Seen Loans from the Artist and Other Collections  
On View Through October 18, 2015 in Waterville, Maine

The early work of artist Alex Katz (b. 1927) is the subject of a major new exhibition at the Colby College Museum of Art, on view for free through October 18, 2015. Brand-New & Terrific: Alex Katz in the 1950s explores the first decade of the artist's career, a period characterized by fierce experimentation and innovation from which Katz's signature style emerged. The exhibition is the first museum survey to focus on the artist's output from this formative decade. Curated by Diana Tuite, Katz Curator at the Colby Museum, Brand-New & Terrific draws from the Colby Museum's deep collection of artworks by Alex Katz and includes many rarely seen loans from the artist and other public and private collections. Installed chronologically in the museum's 9,000-square-foot Paul J. Schupf Wing for the Works of Alex Katz, *Brand-New & Terrific* includes more than 60 paintings, collages, and cutouts that trace Katz's technical and stylistic evolution over the course of the decade.

The exhibit runs through October 18, 2015 Tuesday-Saturday from 10 a.m. – 5 p.m., Sunday, Noon-5 p.m. Closed Mondays. For more information Please visit <http://www.colby.edu/museum/exhibition/view/upcoming/>



## BELGRADE REGIONAL HEALTH CENTER

4 Clement Way, Belgrade, ME 04917 • 207.495.3323 • Fax: 207.495.3353 • BelgradeCHC.org

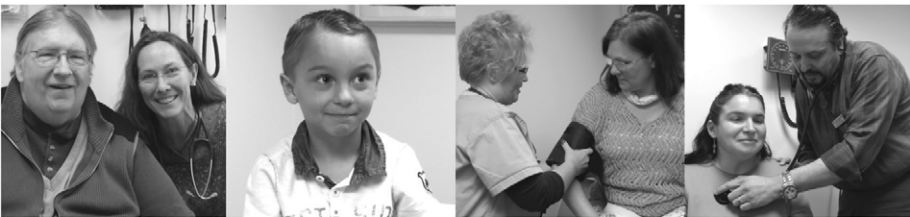

Dear Friends,

Welcome to the spectacular Belgrade Lakes Region. We at Belgrade Regional Health Center hope that your visit is memorable and that you enjoy good health during your stay. We look forward to the return of our summer residents as well as visitors to the area.

**In case you do have a health concern while visiting,** we are available to treat acute problems as well as chronic health conditions. Please call us for an appointment at (207) 495-3323, and we will see you as soon as possible at the health center. Our appointment hours are Monday through Friday, 7:30 a.m. to 12:30 p.m. and 1:30 to 4:30 p.m., and Tuesday evening 4:30 to 7:00 p.m.

If you have a major medical emergency such as chest pain, a severe breathing problem, cardiac condition, or major trauma, please call 911 or go to the nearest emergency room.

If you have a minor health condition such as poison ivy, a fish hook or laceration, please try to call before arriving at the health center. We accept patients on a walk-in basis, but you will be asked to wait until our regularly scheduled patients are seen. If you call ahead, we can give you a scheduled appointment and likely reduce your wait.

**We are located at 4 Clement Way,** just off Route 27, 3 miles north of the intersection of Routes 27 and 135. We look forward to seeing you for any of your healthcare concerns.

Sincerely,

Robert Cianfarano, PA      Lisa LaGrange, FNP      Amy Madden, MD

HealthReach  
Community Health Centers    207.495.3323 | BelgradeCHC.org



## Sprague & Curtis Real Estate

spragueandcurtis.com

6 2 3 . 1 1 2 3

75 Western Ave. • Augusta, ME



**NEW LISTING- FLYING POND- MOUNT VERNON-** Beautiful sunsets from this lovely yr round home w/123+/- feet of shore frontage. Some original features by artist Klir Beck. Eat-in kitchen w/bar, formal DR w/water views, lg back deck. 2 car attach grg & separate shed/boat-house. Brick hearth w/woodstove in LR. Priced to sell! **MLS 1227339 \$249,000**



**COBBOSSEE LAKE- WINTHROP-** Spectacular 2BR, 2BA Condo with fantastic views. Beautiful Cherry kitchen, lg LR w/wood burning fireplace & built-ins. Very quiet end unit w/own boat slip, screened-in porch, 1 car grg right next to the unit. Come enjoy the sandy beach and water views! **MLS 1204538 \$210,000**



**AUGUSTA-** Lots to offer w/many amenities. In-town Colonial located at end of dead end street. Many updates, 4-5BR, 3.5BA, newer boiler, house roof & electrical box. Formal DR, lg LR w/fireplace & pellet stove, family rm w/BA & laundry in walkout basement, lg MBR w/BA. Very private, nice yard w/cov-ered patio. **MLS 1210352 \$179,900**



**NEW LISTING- MARANCOOK LAKE- READ-FIELD-** Gorgeous setting comes w/this 3BR, 2.5BA Cape on 10 ac w/850' +/- of water frontage. Spacious home w/2 car grg, daylight lower level, and 28'x36' barn w/storage. Formal DR, LR w/fireplace, 1st floor Master BR, 2 BS, 1st fl FR, sunroom, lower level rec room, more! A unique offering. **MLS 12277801 \$599,000**



**UPPER NARROWS LAKE- WINTHROP-** Here is a Classic Maine Farmhouse Cape with lots of land & frontage. Offering a spacious LR w/ woodstove & HW floors, office, DR & sunny kitchen. Lg attach garage w/overhead storage, an office area & workshop. Beautiful setting! Unique w/lg parcel of land & lake frontage! **MLS 1221252 \$285,000**



**FARMINGDALE-** Beautiful Cape in wonderful neighborhood. 2,100 sq ft. 3 BR, 2.5 BA. Great floor plan. Open DR/LR w/ stone fireplace, appliances kitchen w/red birch cabinets, delightful screened porch for summer fun. Large MB suite. Walkout basement could easily be finished. 1.49 ac. **MLS 1209636 \$279,000**



**COBBOSSEE LAKE- MONMOUTH-** Fabulous waterfront property- beautiful home AND cottage included! Immaculate condition, 3-4BR, 3BA, in-law apt, pretty kitchen w/DR, nice landscaping/yard, HUGE heated grg, cottage w/1BR, sandy beach, outdoor fireplace. MUCH MORE, MUST SEE! **MLS 1227463 \$429,900**



**AUGUSTA-** Warm & inviting classic Cape Cod on 10.45 park-like ac. This well maintained 3-4BR, 2BA home has been beautifully updated w/new kitchen that opens into spacious FR w/vaulted ceiling & loads of windows to appreciate the beauty & privacy. **MLS 1086790 \$199,900**

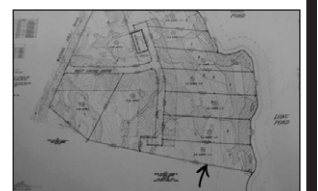

**LAND- LONG POND- LIVERMORE -** Beautiful waterfront parcel on lovely Long Pond. A wonderful place to build a new home. Septic tank has been installed, driveway & electric poles are in. Pristine waterfront. Surveyed. A wonderful opportunity! **MLS 1225639 \$165,000**





## —Conservation Too—

## Conservation in Soil Health

by Bianca Diaz-Deliz (Soil Conservationist, USDA, NRCS)

When I hear the word conservation the first thought that comes to mind is protect and maintain a particular thing. In this case: soil. Why should people be aware of soils? Growing up people are educated on what percentage of the Earth is covered by water. Now, when we think about the remaining percentage available as dry land... is all of it fertile and productive land? Even if that was the case, the reality is that this available land might present conditions where using it for agricultural purposes is not an option, or where special attention and management is required to achieve a desired outcome.

According to (USDA) Natural Resources Conservation Service "Soil quality is how well soil does what we want it to do". In order to do this, taking the time to know your soil is critical. Online soil data and information is available through the USDA Web Soil Survey web page (included in the reference section of this article). This information can be used for general farm, local and wider area planning. In addition, taking a sample of your soil and having it tested is always recommended. Soil sample form and box can be obtained at any NRCS local service center. A healthy soil provides substantial crops, wide-ranging wildlife, clean water and

air as well as productive lands.

Some conservation practices that can help increase the overall conditions of the soil are no till, crop rotation and cover cropping which help reduce soil erosion, increase soil organic matter, promote weed suppression and increase plant available moisture among other healthy soil characteristics. More information about these practices will be discussed in upcoming articles.

I would also like to invite you to save the date and participate in Maine Farm Days to be held at Misty Meadows Farm in Clinton, Maine, where the 2015 ME Soils Conference will take place on August 27, 2015. This conference is free of charge but space is limited, so please, if interested contact [lindsay.hodgman@me.usda.gov](mailto:lindsay.hodgman@me.usda.gov) by August 14, 2015. Topics like soil activities from NRCS and other Maine agencies and organizations will be held as well as input on future directions and approaches. More information can be accessed on the following link: [http://kcsxcd.org/?page\\_id=176](http://kcsxcd.org/?page_id=176).

Conservation plans are developed and implemented to protect, conserve, and/or enhance natural resources within the client's social and economic interests and abilities. If you would like to get more information about

any of our conservation projects and what could be done to improve your soils please contact Dale Finseth at 622-7847 ext. 3 or checkout our website at [www.kswcd.org](http://www.kswcd.org).

Remember, there is a lot to do in order to protect water quality.

Sources of information include:

- **Environmental Defense Fund**- <http://blogs.edf.org/growingreturns/2015/01/29/no-till-farming-can-reduce-input-costs-and-improve-soil-health/>
- **(USDA) NRCS:**  
<http://www.nrcs.usda.gov/wps/portal/nrcs/detail/national/programs/technical/cta/?ci=d=stelprdb1049425>  
<http://www.nrcs.usda.gov/wps/portal/nrcs/main/me/contact/local/>  
<http://www.nrcs.usda.gov/wps/portal/nrcs/main/soils/health/>  
[http://www.nrcs.usda.gov/wps/portal/nrcs/detailfull/co/home/?cid=nrcs144p2\\_063020](http://www.nrcs.usda.gov/wps/portal/nrcs/detailfull/co/home/?cid=nrcs144p2_063020)
- **Web Soil Survey (WSS)**- <http://websoilsurvey.sc.egov.usda.gov/App/HomePage.htm>



For information about any of our conservation projects please contact Dale Finseth at 622-7847, x 3 or check our website at [www.kcsxcd.org](http://www.kcsxcd.org)

**COMMON GROUND  
COUNTRY FAIR**

CELEBRATE RURAL LIVING WITH MOFGA

**SEPTEMBER 25, 26 & 27, 2015**

**UNITY, MAINE**

GATES OPEN AT 9:00 AM

Maine Organic Farmers and Gardeners Association

P.O. Box 170, Unity, Maine 04989

## Can you do well while doing good?



At Golden Pond,  
we have been  
handcrafting and  
managing sustain-  
able investment  
portfolios which  
reflect the values  
of Maine families  
and nonprofits for  
over 20 years.



129 Silver St, Waterville, ME  
Phone: (207) 873-2200  
[www.goldenpondwealth.com](http://www.goldenpondwealth.com)



Securities offered through LPL Financial, Member FINRA/SIPC





## Your own little island of

# FUN

**LARGEST  
SHOREMASTER  
DISTRIBUTOR  
in the  
COUNTRY**

Improve your lake shore living experience with a **SHOREMASTER SWIM RAFT**. Kids and adults alike will enjoy years of fun and treasured memories.

We Cover The Waterfront.

**SHOREMASTER**

### SWIM RAFTS

90" x 114" Poly Swim Raft – Poly Deck - Yellow or Gray	<b>\$1,079</b>
8'x8' Aluminum Swim Raft Cedar Deck	<b>\$1,509</b>
8'x8' Aluminum Swim Raft Aluminum Deck	<b>\$1,929</b>
8'x8' Aluminum Swim Raft White Aluminum	<b>\$1,999</b>
Rip Raft – Tan or Orange	<b>\$809</b>

Ladder sold separately

3 step pivot ladder	\$279
4 step pivot ladder	\$319
5 step pivot ladder	\$389
Nylon Rope Ladder (Rip Raft only)	\$55
2 step Rip Raft Ladder	\$205

Toll-free 1-866-HAMMOND

# Hammond Lumber Company

Visit us online at [www.hammond-shoremaster.com](http://www.hammond-shoremaster.com) for a 72-page Product Planning Guide & Price List.

AUBURN • BANGOR • BELGRADE • BOOTHBAY HARBOR • BRUNSWICK • DAMARISCOTTA  
FAIRFIELD • FARMINGTON GREENVILLE • PEMAQUID • PORTLAND • SKOWHEGAN • WILTON



## Enjoy all life has to offer in a community that cares.

Join the family at Granite Hill Estates, one of Maine's premiere continuing care retirement communities, a member of the MaineGeneral Health family.

- spacious apartments & cozy cottages in a gorgeous setting with easy access to the hills and lakes of central Maine
- an extensive library
- an indoor swimming pool
- a fully equipped fitness center with a full schedule of fitness classes
- outstanding amenities and services

Call 207-626-7786 or toll free 1-888-321-1119 today to schedule a tour or visit our website at [granitehillestates.com](http://granitehillestates.com).



**GRANITE  
HILL  
ESTATES**

Retire your way. Today.

MaineGeneral Health



# Lakepoint

REAL ESTATE

207.495.3700

221 Main St.,  
Belgrade Lakes, ME 04918

[www.belgradelakepoint.com](http://www.belgradelakepoint.com)



NEW PRICE

**LONG POND ACCESS, ROME:** 3BR w/wrap around deck, lge screened porch. Many improvements. Common access to beach & boating area. #1222550 **\$99,900**



**GREAT POND ACCESS, BELGRADE:** 2 Cottages side-by-side w/dock. Main has 1BR. Second is bunk house w/BA. Both Totally renovated. #1096391 **\$210,000**



**SALMON LAKE, OAKLAND:** 3BR/4BA, field-stone fireplace, exercise rm, stone patio, 340' waterfront, on a point. Many more features. A must see! #1221647 **\$899,000**



**EAST POND, SMITHFIELD:** 4BR/4BA Contemporary on 16+ acres with 920' +/- lakefront. Many amenities w/guest cottage 25' from the lake. #1212172 **\$989,000**



**COBBOSSEE LAKE, MANCHESTER:** 3BR/1 BA, yr-rnd Cottage at water's edge, pvt dock, 2nd cottage framed up and complete on outside. #1215825 **\$499,000**



**LONG POND SHARED, BELGRADE:** 3BR/2BA Yr-rnd w/lake views, western exp. from large front deck. Finished basement, laundry room & loft. #1116476 **\$285,000**



**LONG POND, ROME:** 4BR/3BA steps from 200' frontage, wrap around deck, screened porch, dock, 1 car gar, all on dble lot. Most furnishings incl. #1208621 **\$349,000**



**SALMON LAKE, BELGRADE:** 3BR/2BA Contemporary. Open flr plan, exposed beams, new kit, large yard, "Nature Lovers" 300' +/- waterfront. #1225706 **\$320,000**



**PARKER POND, MT VERNON:** Post & Beam 3BR/2BA, woodstove, oversized windows, 3 sliding glass doors, lge deck/screen porch overlooking water. #1212478 **\$457,000**

## DINNER on the FARM

at Winterberry Farm, Route 27, Belgrade

Saturday, July 18th

starting at 5pm



Join us for a summer evening celebration of local food and fun including a family-friendly meal, live music and dancing, kids' activities and more.

price (includes all food, drinks & activities): **ADVANCE TICKETS REQUIRED**

\$ 50 per couple

\$ 27 per person

\$ 15 per child (4 yrs & up)

free for children 3 years & under

for tickets or more information, visit the Farm, call 649-3331, find us on FaceBook, or visit [www.winterberryfarmstand.com](http://www.winterberryfarmstand.com)

proceeds to benefit

**Winterberry  
Forever!  
Farm**

...where children & veggies grow